



Agenda Item No. 10f.

Staff Report

Date: August 11, 2022

To: Mayor Kuhl and Council Members

From: Richard Simonitch, Public Works Director

Subject: Award of Construction Contract for the 2022 Pavement Rehabilitation Project to Maggiora & Ghilotti, Inc – Town Project No. 9040-45

Recommendation

It is recommended that Town Council award the construction contract base bid in the amount of \$274,274 for the 2022 Pavement Rehabilitation Project to Maggiora & Ghilotti, Inc.

Background & Discussion

The 2022 Pavement Rehabilitation Project consists of pavement grinding, dig-out repairs as needed, overlay AC pavement, protection of utility covers, pavement striping / marking, survey monument tie-out and replacement and ancillary work on the entire length of Fernhill Avenue (from Glenwood Ave to Shady Lane) in the Town of Ross.

Moe Engineering was contracted to review existing conditions and provide the engineering design and specifications for the project. The engineer's estimate was \$318,000 for the base bid. Because of the estimated cost of the project, the formal bidding procedure was used. The project was advertised for bid on July 9, 2022 and July 14, 2022, and four bids were received and opened on July 28, 2022. Maggiora & Ghilotti, Inc. is the lowest responsive and responsible bidder in the amount of \$274,274 for the base bid. The total is roughly 14% lower than the engineer's estimate.

All of the bids that were received are tabulated from low to high bidder as follows:

MAGGIORA & GHILOTTI, INC.	\$ 274,274.00
LUCAS PAVING, INC.	\$ 277,391.25
ALWAYS PAVING INC.	\$ 313,665.30
GHILOTTI BROS., INC.	\$ 338,231.00

Fiscal, resource and timeline impacts

Including Moe Engineering design and estimated construction management services costs of \$122,000, the total project cost is approximately \$396,000. There is sufficient funding in the FYE23 Public Works Roadway and Gas Tax Funds to cover this expense.

The contractor is allowed 20 working days to complete the project, with the likelihood that paving operations on Fernhill will directly impact the Branson sports program which began on August 8, and the reopening of Branson School for Fall 2022 session on August 23, 2022. Public Works staff began coordinating the construction schedule and traffic control on a video conference call with Branson staff on August 5th. Branson students and residents on Fernhill Avenue should expect lane closures and traffic delays during construction. Public Works staff will begin notifying individual property owners along Fernhill of parking and driving restrictions the week before construction starts. Public outreach and coordinating traffic control schedules with the residents throughout the course of the Project is also the responsibility of the contractor.

Alternative actions

The Town Council could request that the current bid be rejected, and the project re-advertised with the hope of receiving lower bids. Staff recommends that the current bid be considered reasonable and accurate with respect to the Engineer's estimate and the number of bids received, and that re-advertising the project for new bids will not likely result in lower bids.

Environmental review

The project is categorically exempt under the California Environmental Quality Act (CEQA) Article 19, Section 15301 existing facilities (existing pedestrian pathways).

Attachments

- Project Plans (reduced size)

TOWN OF ROSS

VICINITY MAP

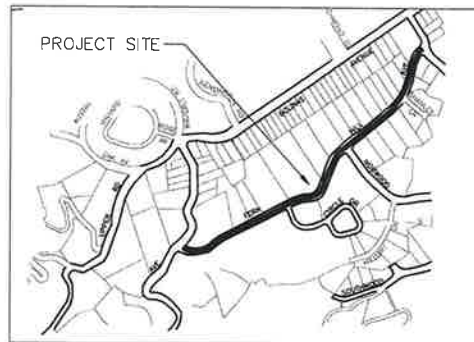
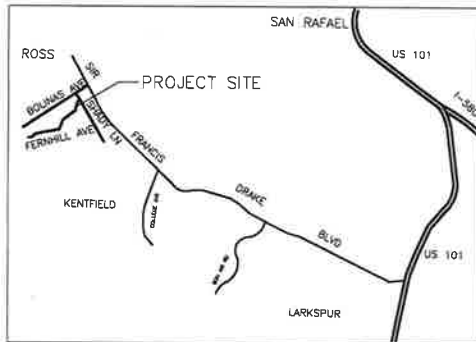

1	COVER SHEET
2	COMBINED LAYOUT AND STRIPING PLAN

John F. W.

7-7-22



JOHN L. MOE, AGE 48460

DATE _____

[illegible]

COVER SHEET

Journal of

FERN HILL AVE
ROSS, CA

REPORT NAME

JULY 8, 2002

42

18

2022-008

CROSS COVER SHEET

1

1

WEST SEGMENT

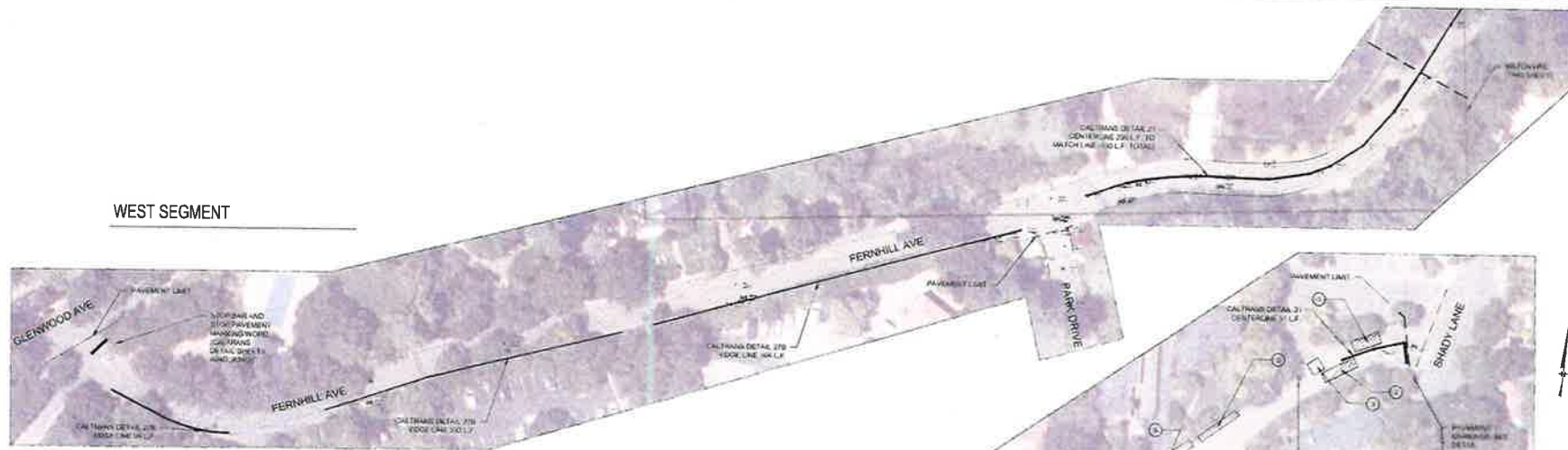

EAST SEGMENT

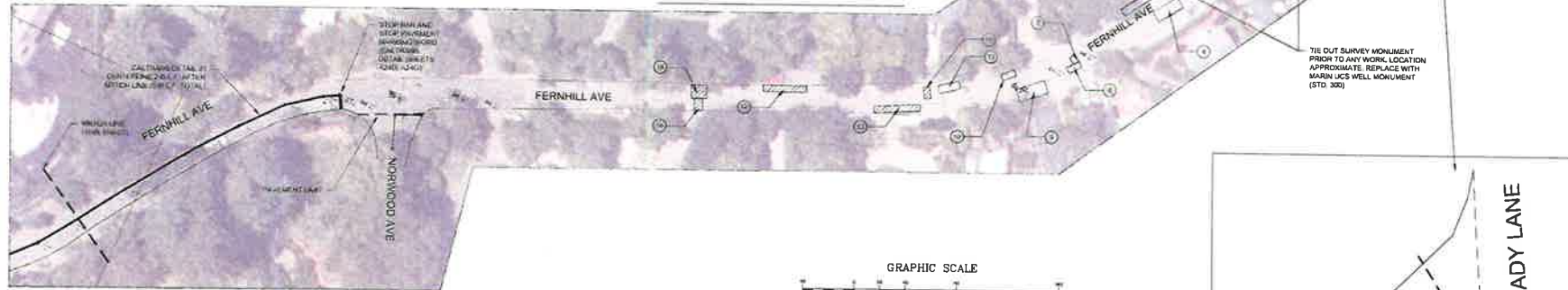

TABLE OF DIGOUTS

NUMBER	DIM.	AREA (SQ FT)
1	6' x 15'	75
2	8' x 28'	224
3	10' x 10'	100
4	9' x 22'	198
5	5' x 36'	90
6	6' x 64'	384
7	6' x 5'	30
8	11' x 5'	55
9	10' x 23'	230
10	5' x 11'	55
11	6' x 17'	102
12	5' x 9'	45
13	5' x 36'	180
14	5' x 34'	170
15	12' x 10'	120
16	6' x 10'	60
TOTAL AREA = 2,223 SQ FT		

LEGEND

- GRIND AND OVERLAY A.C.
- DIGOUT LOCATION (SEE TABLE)

NOTES

- CONTRACTOR TO ENSURE EXISTING STRIPING IS REPLACED IN KIND AFTER PAVING.
- EXACT PAVEMENT LIMITS TO BE MARKED BY TOWNS REPRESENTATIVE PRIOR TO CONSTRUCTION.
- CONTRACTOR TO PROTECT ALL EXISTING UTILITY COVERS IN PLACE.

