



**Agenda Item No. 12h.**

**Staff Report**

**Date:** July 14, 2022

**To:** Mayor Kuhl and Council Members

**From:** Richard Simonitch, Public Works Director

**Subject:** Award of Construction Contract for the Ross Common Pathway 2022 Improvements Project to Maggiora & Ghilotti, Inc – Town Project No. 9188-66

---

**Recommendation**

It is recommended that Town Council award the construction contract base bid in the amount of \$252,252 for the Ross Common Pathway 2022 Improvements Project to Maggiora & Ghilotti, Inc.

**Background & Discussion**

The Ross Common Pathway 2022 Improvements Project consists of removal of the existing asphalt concrete pathways, grading and preparation for new pathway, tree root preservation, installation of pathway edging, adjustment and/or preservation of utility covers, installation & compaction of base rock, and installation of asphalt concrete pathway and turf restoration within Ross Common Park. The pathway rehabilitation is the initial phase of the "Ross Common Landscape Improvement & Rehabilitation Plan" adopted by Town Council on December 9, 2021.

Moe Engineering was contracted to review existing conditions and provide the engineering design and specifications for the project. The engineer's estimate was \$279,000 for the base bid. Because of the estimated cost of the project, the formal bidding procedure was used. The project was advertised for bid on June 16, 2022, and seven bids were received and opened on July 7, 2022. Maggiora & Ghilotti, Inc. is the lowest responsive and responsible bidder in the amount of \$252,252 for the base bid. The total is roughly 10% lower than the engineer's estimate.

All of the bids that were received are tabulated from low to high bidder as follows:

MAGGIORA & GHILOTTI, INC.	\$ 252,252
W.R. FORDE	\$ 268,250
AZUL WORKS	\$ 273,500
MPC	\$ 331,450
GHILOTTI BROS	\$ 387,550

RODMAN ELECTRIC	\$ 420,500
CF CONTRACTING	\$ 488,000

**Fiscal, resource and timeline impacts**

Including Moe Engineering design and estimated construction management services costs of \$87,000 the total project cost is approximately \$339,252. There is sufficient funding in the FYE23 Public Works Facilities and Equipment Fund to cover this expense, which will include a \$177,952 reimbursement from the Prop 68 Per Capita grant once the project is completed. The contractor is allowed 30 working days, with the intent that the work be completed prior to the reopening of Ross School for Fall 2022 session on August 16, 2022. There are no scheduled Ross Recreation programs that will be impacted by the construction.

**Alternative actions**

Council could request that the current bid be rejected, and the project re-advertised with the hope of receiving lower bids. Staff recommends that the current bid be considered reasonable and accurate with respect to the Engineer's estimate and the number of bids received, and that re-advertising the project for new bids will not likely result in lower bids.

**Environmental review**

The project is categorically exempt under the California Environmental Quality Act (CEQA) Article 19, Section 15301 existing facilities (existing pedestrian pathways).

**Attachments**

- Project Plans (reduced size)

# ROSS COMMON PATHWAYS 2022 IMPROVEMENTS



TOWN  
OF  
ROSS

TOWN PROJECT # 9188-66

## VICINITY MAP

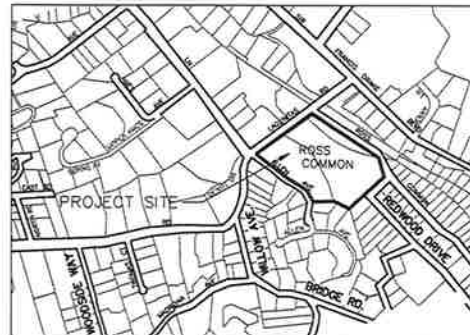
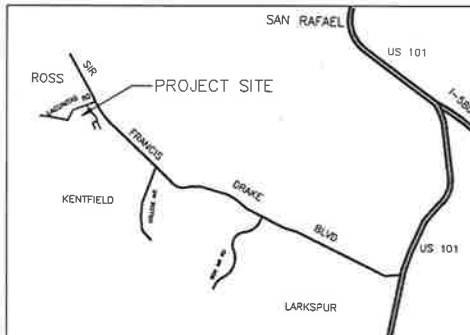

## INDEX OF SHEETS

- |   |   |
|---|---|
| 1 | COVER SHEET                             |
| 2 | PATH IMPROVEMENT PLAN - NORTHERN LAYOUT |
| 3 | PATH IMPROVEMENT PLAN - SOUTHERN LAYOUT |

## TYPICAL PATHWAY SECTION

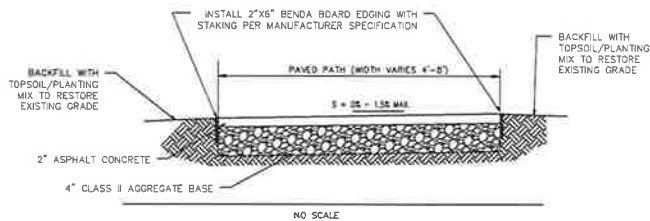

### NOTES

1. PAVED PATHWAY TO BE 2" ASPHALT PAVING OVER 4" CLASS II AGG @ 95% COMPACTION
2. EDGING TO BE SYNTHETIC BENDER BOARD 2"x6" EDGING IN COLOR APPROVED BY TOWN
3. THE INTENT IS FOR NEW PATHWAY CENTERLINE GRADES TO MATCH EXISTING PATHWAY GRADES. FILL ANY LOW AREAS ADJACENT TO PATHWAY WITHIN 5' OF PATH EDGE WITH TOPSOIL.
4. COMPACT NATIVE SUBGRADE TO 90% RELATIVE COMPACTION

## CONSTRUCTION FENCING EXAMPLE

(FOR ILLUSTRATIVE PURPOSES ONLY)

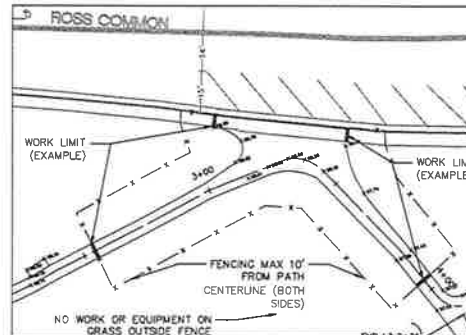

JOHN L. MOIR, RCE 49460

6-16-2022

DATE

 MOE ENGINEERING, INC. 2000 MONTICELLO AVE. SANTA ROSA, CALIFORNIA 95404 (707) 544-6274	
COVER SHEET	
PROJECT NAME	ROSS COMMON PATHWAYS ROSS, CA
DATE	JUNE 16, 2022
SHEET	1 OF 2
PROJECT NO.	2022-008
PROJECT	ROSS PATH IMPROVEMENT
1	

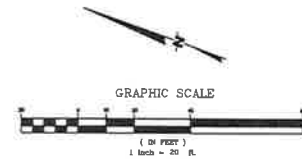
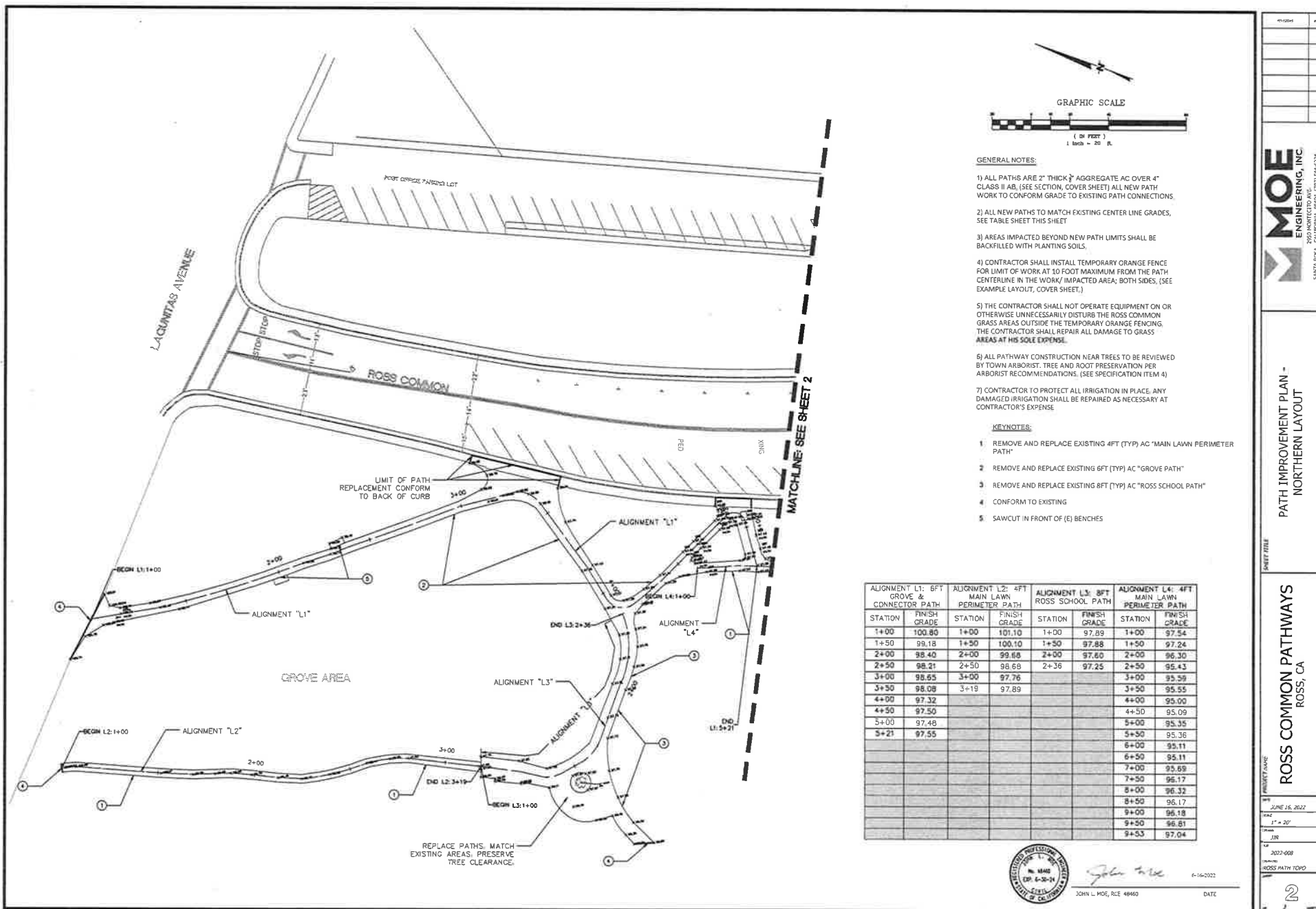

GENERAL NOTES:

- 1) ALL PATHS ARE 2" THICK 3/4" AGGREGATE AC OVER 4" CLASS II AB, (SEE SECTION, COVER SHEET) ALL NEW PATH WORK TO CONFORM GRADE TO EXISTING PATH CONNECTIONS.
- 2) ALL NEW PATHS TO MATCH EXISTING CENTER LINE GRADES, SEE TABLE SHEET THIS SHEET
- 3) AREAS IMPACTED BEYOND NEW PATH LIMITS SHALL BE BACKFILLED WITH PLANTING SOILS.
- 4) CONTRACTOR SHALL INSTALL TEMPORARY ORANGE FENCE FOR LIMIT OF WORK AT 10 FOOT MAXIMUM FROM THE PATH CENTERLINE IN THE WORK/IMPACTED AREA; BOTH SIDES, (SEE EXAMPLE LAYOUT, COVER SHEET.)
- 5) THE CONTRACTOR SHALL NOT OPERATE EQUIPMENT ON OR OTHERWISE UNNECESSARILY DISTURB THE ROSS COMMON GRASS AREAS OUTSIDE THE TEMPORARY ORANGE FENCING. THE CONTRACTOR SHALL REPAIR ALL DAMAGE TO GRASS AREAS AT HIS SOLE EXPENSE.
- 6) ALL PATHWAY CONSTRUCTION NEAR TREES TO BE REVIEWED BY TOWN ARBORIST. TREE AND ROOT PRESERVATION PER ARBORIST RECOMMENDATIONS. (SEE SPECIFICATION ITEM 4)
- 7) CONTRACTOR TO PROTECT ALL IRRIGATION IN PLACE. ANY DAMAGED IRRIGATION SHALL BE REPAIRED AS NECESSARY AT CONTRACTOR'S EXPENSE.

KEYNOTES:

- 1 REMOVE AND REPLACE EXISTING 4FT (TYP) AC "MAIN LAWN PERIMETER PATH"
- 2 REMOVE AND REPLACE EXISTING 6FT (TYP) AC "GROVE PATH"
- 3 REMOVE AND REPLACE EXISTING 8FT (TYP) AC "ROSS SCHOOL PATH"
- 4 CONFORM TO EXISTING
- 5 SAWCUT IN FRONT OF (E) BENCHES

ALIGNMENT L1: 6FT GROVE & CONNECTOR PATH		ALIGNMENT L2: 4FT MAIN LAWN PERIMETER PATH		ALIGNMENT L3: 8FT ROSS SCHOOL PATH		ALIGNMENT L4: 4FT MAIN LAWN PERIMETER PATH	
STATION	FINISH GRADE	STATION	FINISH GRADE	STATION	FINISH GRADE	STATION	FINISH GRADE
1+00	100.80	1+00	101.10	1+00	97.89	1+00	97.54
1+50	98.18	1+50	100.10	1+50	97.88	1+50	97.24
2+00	98.40	2+00	99.88	2+00	97.60	2+00	96.30
2+50	98.21	2+50	98.69	2+36	97.25	2+50	95.43
3+00	98.65	3+00	97.76			3+00	95.59
3+50	98.08	3+19	97.89			3+50	95.55
4+00	97.32					4+00	95.00
4+50	97.50					4+50	95.09
5+00	97.48					5+00	95.35
5+21	97.55					5+50	95.36
						6+00	95.11
						6+50	95.11
						7+00	95.69
						7+50	96.17
						8+00	96.32
						8+50	96.17
						9+00	96.18
						9+50	96.61
						9+53	97.04



JOHN L. MOORE, RCE 49460

DATE

