



Agenda Item No. 9f.

Staff Report

Date: June 18, 2020

To: Mayor McMillan and Council Members

From: Richard Simonitch, Public Works Director

Subject: Council approval of the design of the Bolinas Avenue Rehabilitation Project and approval of the Town of San Anselmo's recommendation for the lowest responsible and responsive bid

Recommendation

Council approve the design for the Bolinas Avenue Rehabilitation Project (Project) and approve the Town of San Anselmo's recommendation to award the contract to Team Ghilotti, the lowest responsible and responsive bidder.

Background & Discussion

The maintenance of Bolinas Avenue is shared by the Towns of Ross and San Anselmo. In March 2019, the Town Council approved a cost share agreement (the agreement) between the towns for drainage improvements and roadway rehabilitation. Under the terms of the agreement, The Town of Ross managed the design and construction of the storm drain improvements which were completed in the summer/fall of 2019. San Anselmo prepared the design and will manage the construction of the roadway rehabilitation project and once completed, the two towns will balance the costs for the two projects and split the costs evenly.

The agreement stipulates that both Ross and San Anselmo's Town Councils approve the Project design plans and approve the lowest responsive and responsible bid prior to either lead Party's award of contract. San Anselmo's Town Council approved the design and authorized their staff to advertise for bids at their May 12, 2020 Council meeting. Bids were opened on June 16, 2020

The roadway rehabilitation project consists of rebuilding the subgrade using Full Depth Reclamation (FDR) between San Anselmo Avenue and Kensington Road, and removal of 4 inches and replacement of 3 inches of asphalt between Kensington Road and Upper Road. The FDR process consists of grinding down 12" into the existing asphalt and base material, amending the grindings with cement and other additives, and recompacting to create a strengthened base,

followed by placing 0.3 feet (3.6 inches) of new asphalt on top. The new road surface elevation will be a couple of inches lower than the existing road surface to return the roadway to the proper elevation that was raised by the last overlay.

An additive alternate was added to the bid for grinding and paving of Oak Avenue in San Anselmo, from the Upper Road intersection to Austin Avenue. The Engineer's Estimate for this segment is \$130,000. This cost for this additive alternate is to be borne by the Town of San Anselmo alone and is not part of the cost share agreement.

The Town has been working with San Anselmo and the Bolinas Avenue Neighborhood Committee (BANC) to address vehicular speeding and pedestrian safety issues. The project includes maintaining the existing median islands installed in 2013 at crosswalks at Shady Lane and Richmond Road. The project also includes traffic calming measures consisting of speed humps at two locations between Richmond Road and Kensington Road, shoulder islands at the Kensington Road intersection (both sides) and green-backed sharrows throughout. The shoulder islands will be placed in the parking lane on the east side of the intersection, and will not affect available street parking as they are located in a red zone on one side, and adjacent to the curb ramp on the other side. Also, a new fog line (4 inch white stripe) between the parking area and travel lane will create the appearance that the roadway is narrowed when there are no cars parked along the street, and should lower speeds. The engineer's estimate for construction of the project was \$875,000.

Because of the estimated cost of the project, the formal bidding procedure was used by the Town of San Anselmo. Bids were received and opened by Town of San Anselmo staff on June 16, 2020 at 10AM with the following results.

Bidder	Base Bid	Additive Alt	Total
Team Ghilotti (low bidder)	\$654,857.34	\$82,284.43	\$737,141.77
Ghilotti Bros	\$664,117.50	\$81,253.50	\$745,371.00
Ghilotti Construction Co.	\$672,722.50	\$83,757.50	\$756,480.00
Maggiore & Ghilotti	\$763,742.30	\$84,104.70	\$847,847.00

The Town of San Anselmo recommends that the project be awarded to Team Ghilotti after the mandatory bid protest period (sometime early next week) and after confirming that Team Ghilotti is the lowest responsible and responsive bidder. Town of Ross staff agrees with the Town of San Anselmo recommendation.

Fiscal, resource and timeline impacts

Under the agreement, the Town of Ross will be responsible for contributing half of the costs of the project under the base bid, after the project is completed and all change orders are considered. The final, balancing payment amount will be determined based on the cost difference between this project and the Bolinas Avenue Storm Drain Project costs from 2019, which totaled \$874,760.

Alternative actions

None recommended.

Environmental review

The Town finds this project to be categorically exempt from the requirement for the preparation of environmental documents under the California Environmental Quality Act (CEQA) under CEQA Guidelines Section 15301 Class 1, because it involves rehabilitation of existing streets, sidewalks, and gutters that will not create additional automobile lanes and involves negligible or no expansion of use. (14 Cal. Code Regs. § 15301).

Attachments

1. Bolinas Avenue Rehabilitation Project Plans

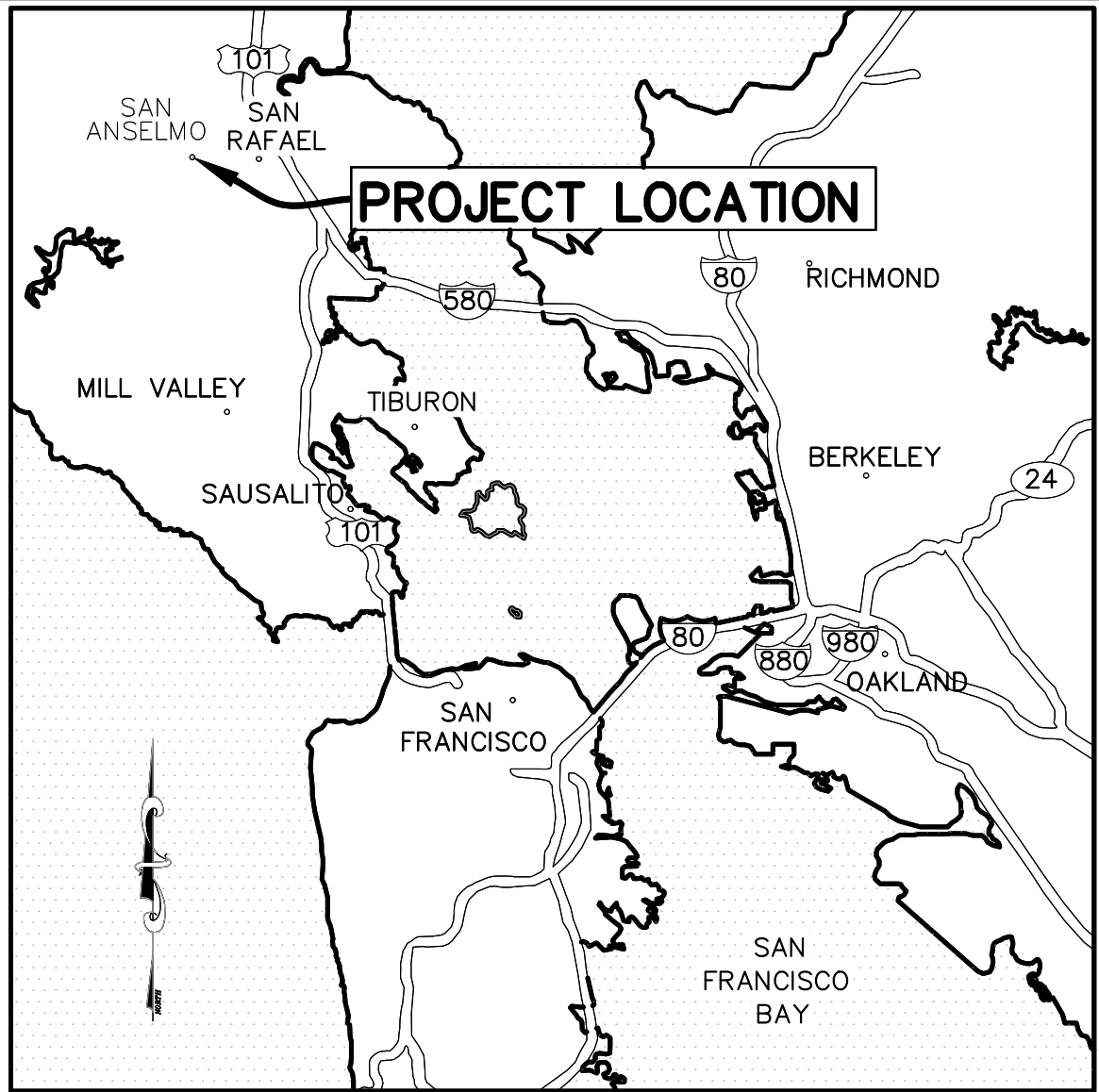

VICINITY MAP
NOT TO SCALE

ABBREVIATIONS

ABBREVIATION	DESCRIPTION
AC	ASPHALT CONCRETE
ADJ	ADJUST
ALT	ADDITIVE ALTERNATIVE BID
APPROX	APPROXIMATE
C	CENTERLINE
EX	EXISTING
FDR	FULL DEPTH RECLAMATION
FOC	FACE OF CURB
FG	FINISHED GRADE
FSG	FINISHED SUBGRADE
FT	FEET
HMA	HOT MIX ASPHALT
LC	LEVELING COURSE
LF	LINEAR FEET
LIP	LIP OF GUTTER
MH	MAINTENANCE HOLE
NTS	NOT TO SCALE
OG	ORIGINAL GRADE
OSG	ORIGINAL SUBGRADE
PCC	PORTLAND CEMENT CONCRETE
PM	PAVING MAT
ROW	RIGHT-OF-WAY
SD	STORM DRAIN
SS	SANITARY SEWER
SSCO	SANITARY SEWER CLEAN OUT
TYP	TYPICAL
VG	VALLEY GUTTER
WV	WATER VALVE
±	PLUS OR MINUS

LEGEND

CURB AND GUTTER		PROPERTY LINE	
TREE		SEWER LINE	
CLEAN OUT		STORM DRAIN LINE	
CATCH BASIN		WATER LINE	
MAINTENANCE HOLE		GAS LINE	
WATER VALVE		FIBER OPTIC LINE	
GAS VALVE		ELECTRIC LINE	
UTILITY VALVE		TV LINE	
UTILITY VAULT/BOX		JOINT TRENCH	
POWER POLE		OVERHEAD LINE	
FIRE HYDRANT			
UTILITY MAINTENANCE HOLE			
SANITARY SEWER LAMPHOLE			

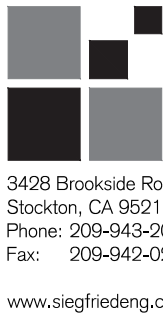

- CIVIL ENGINEERING
- STRUCTURAL ENGINEERING
- LANDSCAPE ARCHITECTURE
- LAND SURVEYING
- PLANNING
- ATHLETIC FACILITY DESIGN



525 San Anselmo Avenue, San Anselmo, CA 94960

BOLINAS AVENUE REHABILITATION PROJECT

TOWN OF SAN ANSELMO



LOCATION MAP
NOT TO SCALE

SHEET INDEX

SHEET NO.	DESCRIPTION
C1.00	COVER SHEET
C2.00	NOTES & CROSS SECTIONS
C3.00	BOLINAS AVENUE LAYOUT I
C3.01	BOLINAS AVENUE LAYOUT II
C3.02	BOLINAS AVENUE LAYOUT III
C3.03	BOLINAS AVENUE LAYOUT IV
C4.00	BOLINAS AVENUE STRIPING I
C4.01	BOLINAS AVENUE STRIPING II
C4.02	BOLINAS AVENUE STRIPING III
C4.03	BOLINAS AVENUE STRIPING IV
C5.00	DETAILS

LOCATION KEY

1	BOLINAS AVENUE AND OAK AVENUE (SAN ANSELMO AVE TO AUSTIN AVENUE)
---	---

TOWN OF SAN ANSELMO

BOLINAS AVENUE REHABILITATION PROJECT

COVER SHEET

C1.00

DESIGNED: RAC	SCALE: AS SHOWN
DRAWN: JKP	
CHECKED: RAC	
DRAWING DATE: 10/07/19	SHEET: 1 OF 11

1. THE CONTRACTOR AGREES THAT IN ACCORDANCE WITH GENERALLY ACCEPTED CONSTRUCTION PRACTICES, CONTRACTOR SHALL ASSUME SOLE AND COMPLETE RESPONSIBILITY FOR JOB SITE CONDITIONS DURING THE COURSE OF CONSTRUCTION OF THE PROJECT. THESE PLANS DO NOT INCLUDE COMPONENTS NECESSARY FOR CONSTRUCTION SAFETY. IT IS THE CONTRACTOR'S RESPONSIBILITY TO PROVIDE FOR THE SAFETY OF ALL PERSONS AND PROPERTY DURING THE COURSE OF THE PROJECT AND TO KNOW AND COMPLY WITH ALL APPLICABLE LAWS AND REGULATIONS, INCLUDING WITH CONSTRUCTION SAFETY ORDERS AND CAL/OSHA REQUIREMENTS. THESE REQUIREMENTS SHALL APPLY CONTINUOUSLY AND NOT BE LIMITED TO NORMAL WORKING HOURS, AND THE CONTRACTOR SHALL DEFEND, INDEMNIFY AND HOLD THE TOWN AND THE ENGINEER HARMLESS FROM ANY AND ALL LIABILITY, REAL OR ALLEGED, IN CONNECTION WITH THE PERFORMANCE OF WORK ON THIS PROJECT, EXCEPTING FOR LIABILITY ARISING FROM THE SOLE NEGLIGENCE OF THE TOWN OR THE ENGINEER.

2. THESE PLANS SHALL BE USED IN CONJUNCTION WITH THE CONTRACT SPECIAL PROVISIONS, THE LATEST EDITION OF THE COUNTY OF MARIN STANDARD PLANS, AND THE STATE OF CALIFORNIA STANDARDS PLANS AND STANDARD SPECIFICATIONS DATED MAY 2018 AND THE REVISED STANDARD SPECIFICATIONS AND STANDARD PLANS AS AMENDED THROUGH FEBRUARY 21, 2019.

3. THE CONTRACTOR SHALL INSPECT THE PROJECT SITE PRIOR TO SUBMITTING A BID IN ORDER TO OBSERVE AND DETERMINE THE EXISTING JOB SITE CONDITIONS.

4. THE PRIME CONTRACTOR AND ALL SUBCONTRACTORS SHALL BE APPROPRIATELY LICENSED BY THE CALIFORNIA CONTRACTORS STATE LICENSE BOARD AND REGISTERED WITH THE DEPARTMENT OF INDUSTRIAL RELATIONS.

5. LOCATION OF ALL EXISTING UNDERGROUND UTILITIES MAY NOT BE SHOWN ON THE PLANS. LOCATION OF EXISTING UNDERGROUND UTILITIES SHOWN ON PLANS ARE APPROXIMATE AND WERE OBTAINED BY FIELD OBSERVATION ONLY. THE TOWN AND THE ENGINEER DO NOT ACCEPT RESPONSIBILITY FOR THE ACCURACY OR COMPLETENESS OF THE UTILITY INFORMATION.

6. CONTRACTOR SHALL NOTIFY UNDERGROUND SERVICE ALERT (U.S.A.) AT (800) 272-2600 OR 811 A MINIMUM OF 7 DAYS IN ADVANCE OF ANY EXCAVATION, AND SHALL FIELD VERIFY LOCATION OF UTILITIES IN ACCORDANCE WITH THE SPECIFICATIONS AND USA NORTH. IT SHALL BE THE CONTRACTOR'S SOLE RESPONSIBILITY TO PROTECT ALL EXISTING UTILITIES SO THAT NO DAMAGE RESULTS TO THEM DURING THE PERFORMANCE OF THE CONTRACT. ANY ADDITIONAL COSTS INCURRED AS A RESULT OF CONTRACTOR'S FAILURE TO VERIFY LOCATION OF ALL EXISTING UTILITIES PRIOR TO BEGINNING OF CONSTRUCTION OR FAILURE TO PROTECT THEM SHALL BE BORNE BY THE CONTRACTOR.

7. EXCAVATION OF 5 FEET OR MORE IN DEPTH WILL REQUIRE AN EXCAVATION PERMIT FROM THE STATE OF CALIFORNIA DEPARTMENT OF INDUSTRIAL SAFETY.

8. THE CONTRACTOR SHALL BE RESPONSIBLE FOR PROTECTING FROM DAMAGE ALL EXISTING IMPROVEMENTS THAT ARE TO REMAIN. SUCH IMPROVEMENTS THAT ARE DAMAGED BY THE CONTRACTOR SHALL BE REPLACED AT THE CONTRACTOR'S EXPENSE.

9. CONTRACTOR SHALL PROTECT ALL MONUMENTS AND ADJUST COVERS TO GRADE AT LOCATIONS SHOWN ON THE PLANS. MONUMENTS THAT WILL BE DISTURBED SHALL BE IDENTIFIED BY THE CONTRACTOR TO THE ENGINEER A MINIMUM OF 2 WEEKS PRIOR TO DISTURBANCE SO THAT A TOWN HIRED SURVEYOR CAN SET REFERENCE POINTS TO ESTABLISH THE MONUMENT BEFORE THE MONUMENT IS DISTURBED.

10. SAFE TRAFFIC CONTROL DURING CONSTRUCTION SHALL BE THE CONTRACTOR'S SOLE RESPONSIBILITY. ALL TRAFFIC CONTROL AND DEVICES SHALL BE IN ACCORDANCE WITH THE LATEST EDITION OF THE "CALIFORNIA MANUAL OF UNIFORM TRAFFIC CONTROL DEVICES" (MUTCD) ISSUED BY THE STATE OF CALIFORNIA, DEPARTMENT OF TRANSPORTATION.

11. THE CONTRACTOR SHALL PROVIDE FOR CONTINUOUS VEHICULAR AND PEDESTRIAN INGRESS AND EGRESS TO ALL PRIVATE PROPERTY ADJACENT TO THE WORK THROUGHOUT THE PERIOD OF CONSTRUCTION UNLESS APPROVED IN ADVANCE BY THE ENGINEER.

12. DUST CONTROL SHALL BE PERFORMED AT ALL TIMES, AT THE CONTRACTORS' EXPENSE, TO MINIMIZE ANY DUST NUISANCE AND SHALL BE IN ACCORDANCE WITH SECTION 10 OF CALTRANS STANDARD SPECIFICATIONS.

13. ANY EXCESS MATERIALS SHALL BE CONSIDERED THE PROPERTY OF THE CONTRACTOR/OWNER AND SHALL BE DISPOSED OF AWAY FROM THE JOB SITE IN ACCORDANCE WITH APPLICABLE LOCAL, STATE AND FEDERAL REGULATIONS, AND THE SPECIFICATIONS.

14. IF, DURING THE COURSE OF THE WORK, THE CONTRACTOR ENCOUNTERS ANY SURFACE OR SUBSURFACE MATERIALS THAT THEY BELIEVE ARE HAZARDOUS (AS DEFINED IN SECT. 25117 OF THE HEALTH AND SAFETY CODE), ALL WORK SHALL IMMEDIATELY BE STOPPED AND THE COUNTY ENVIRONMENTAL HEALTH DEPARTMENT, THE FIRE DEPARTMENT, THE POLICE DEPARTMENT, AND THE TOWN INSPECTOR SHALL BE NOTIFIED IMMEDIATELY. MATERIAL IS TO REMAIN UNDISTURBED UNTIL CLEARANCE HAS BEEN ISSUED BY ALL OF THESE AGENCIES.

15. ALL CONSTRUCTION SITE ACTIVITIES SHALL CONFORM TO THE STATE WATER RESOURCES CONTROL BOARD, NATIONAL POLLUTION DISCHARGE ELIMINATION SYSTEM (NPDES), WASTE DISCHARGE REQUIREMENTS FOR DISCHARGES OF STORM WATER RUNOFF ASSOCIATED WITH CONSTRUCTION ACTIVITY. THE CONTRACTOR SHALL PREPARE AND OBTAIN A NOTICE OF INTENT, IF APPLICABLE.

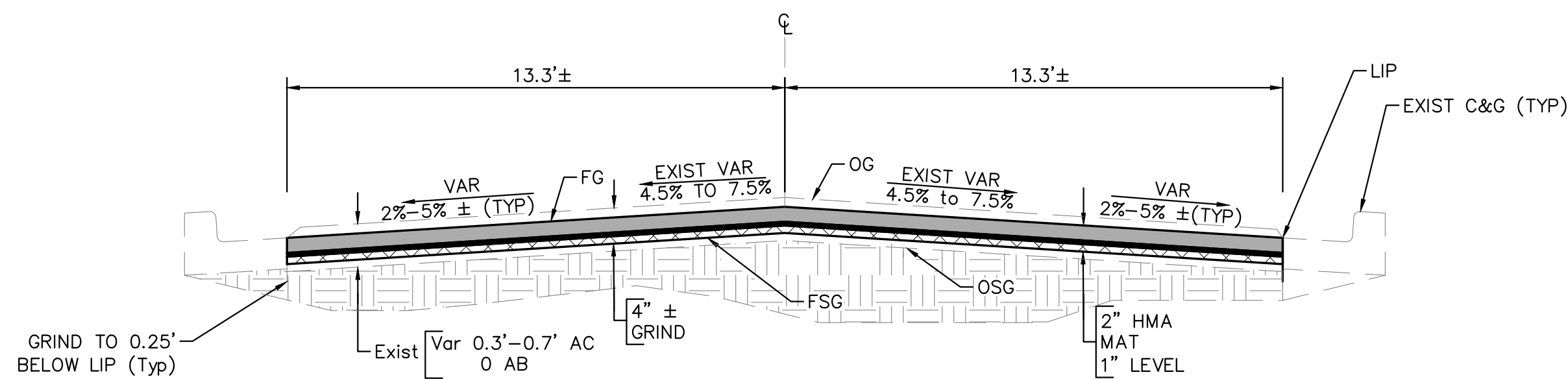

1A 2" HMA/MAT/1" LEVEL
NTS OAK AVENUE

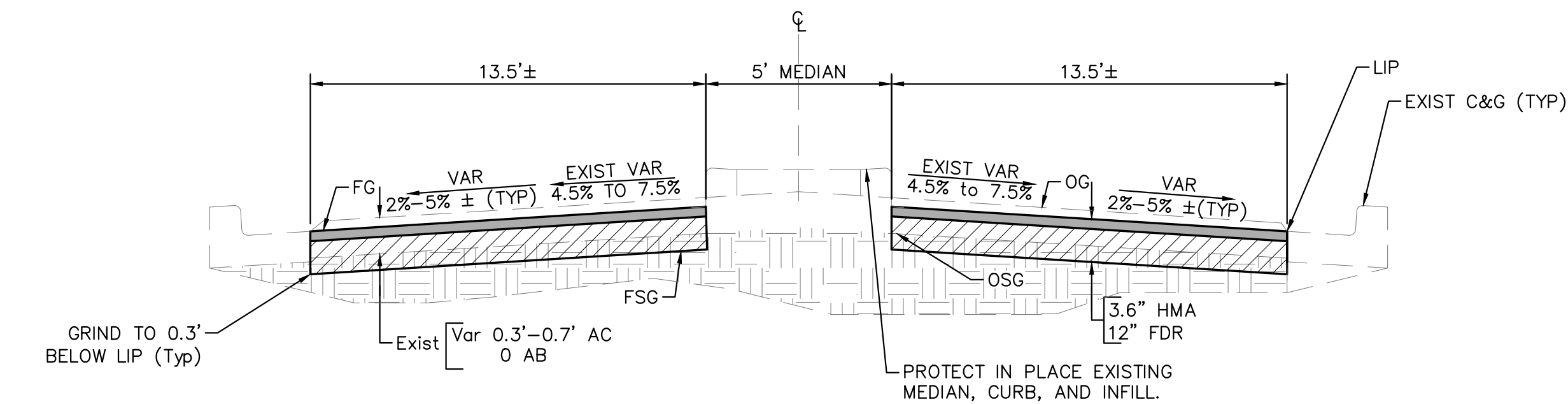

2	3.6" HMA/12" FDR
NTS	BOLINAS AVENUE: TYPICAL WITH MEDIAN

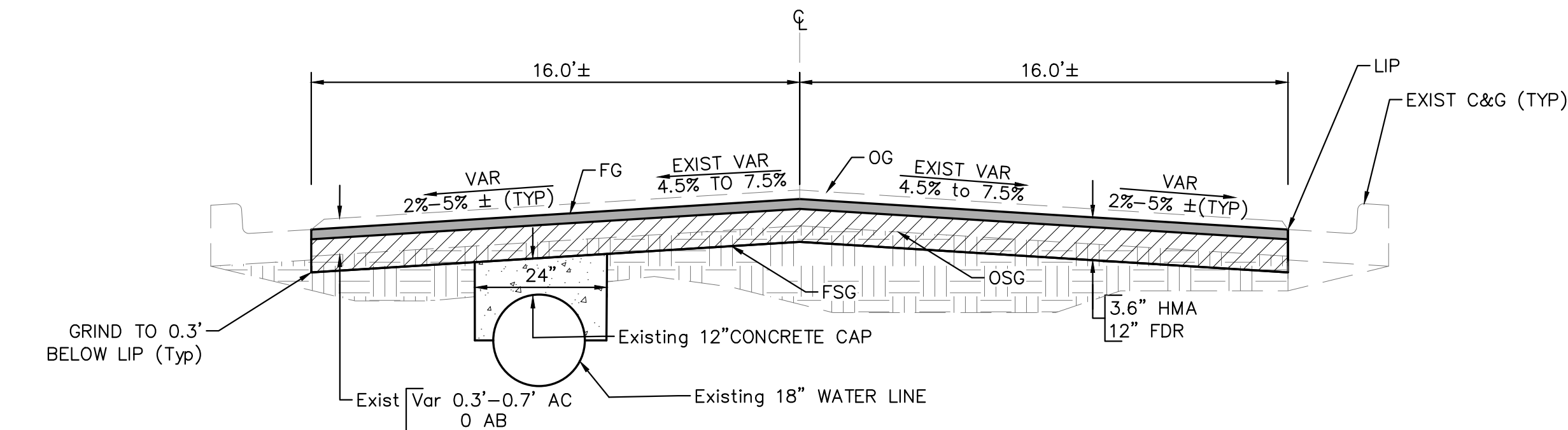

4 3.6" HMA/12" FDR WITH CONCRETE CAP
NTS BOLINAS AVENUE



Know what's **below**.
Call before you dig.



3428 Brookside Road
Stockton, CA 95219
Phone: 209-943-2021
Fax: 209-942-0214
www.siegfriedeng.com

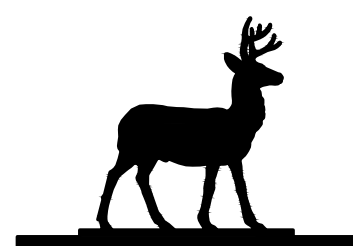

SAN ANSELMO

525 San Anselmo Avenue, San Anselmo, CA 94960

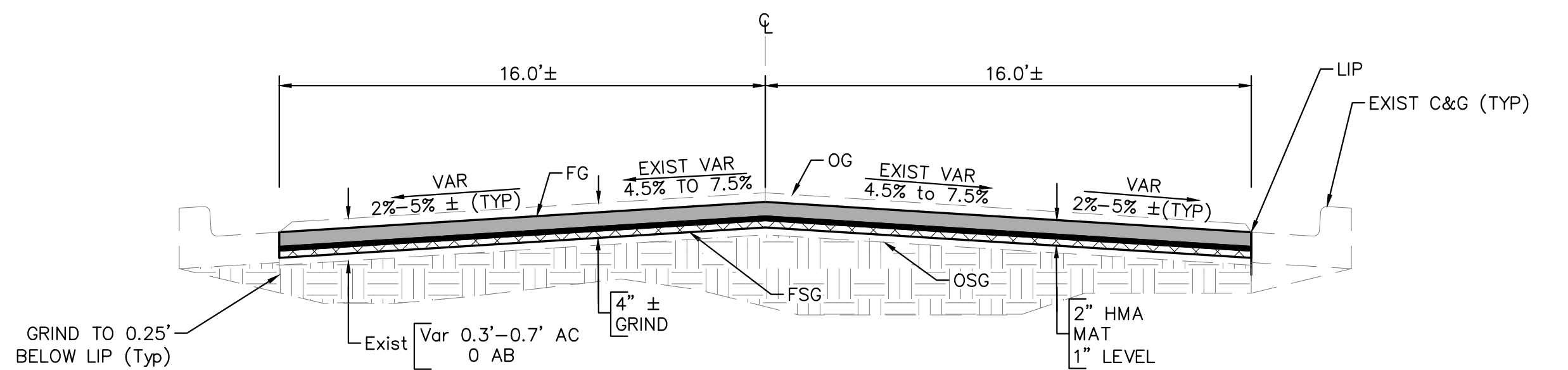

1B 2" HMA/MAT/1" LEVEL
NTS BOLINAS AVENUE

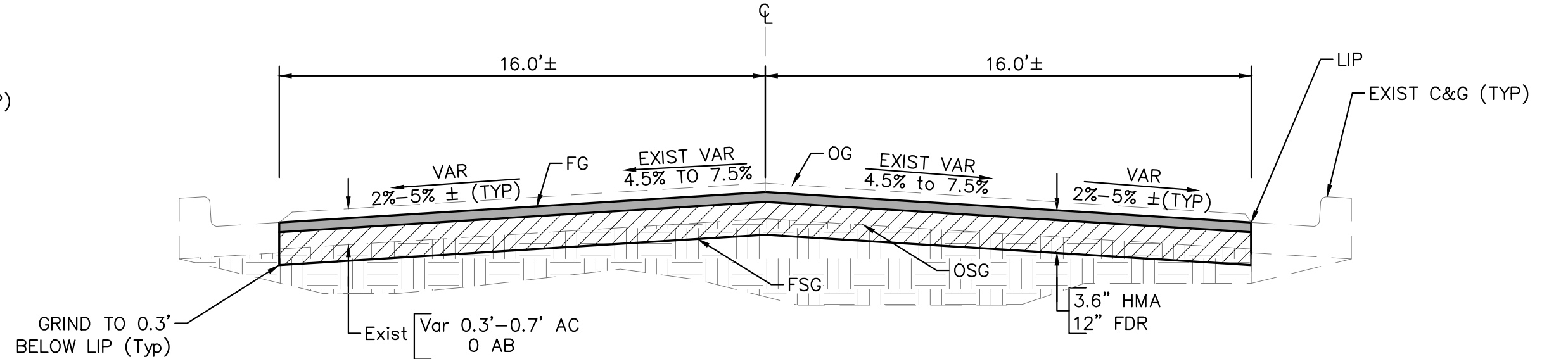

3	3.6" HMA/12" FDR
NTS	BOLINAS AVENUE: TYPICAL WITHOUT MEDIAN

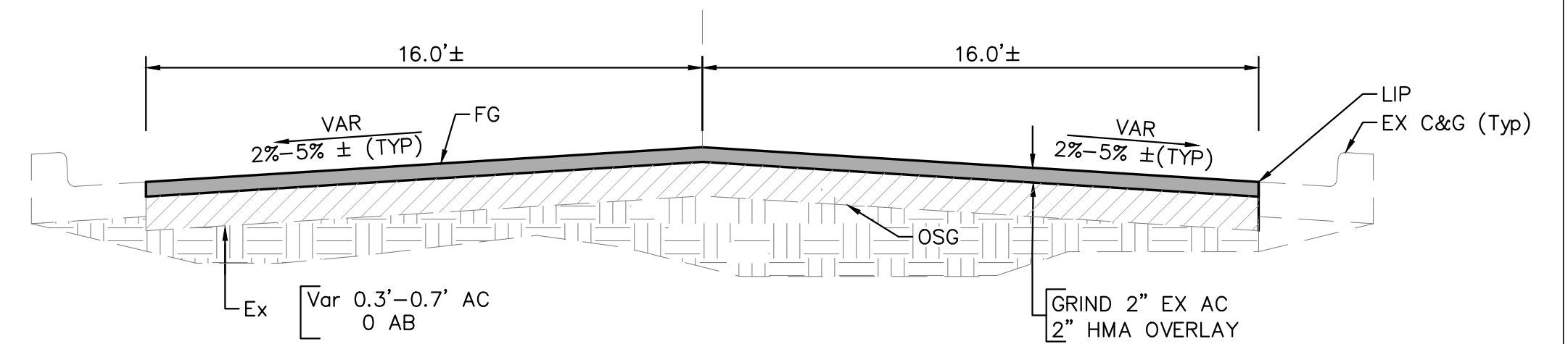

5 2" GRIND AND OVERLAY
NTS BOLINAS AVENUE



DATE SIGNED: 05/06/20

ACCEPTED 05/06/20

S. Long

TOWN ENGINEER

TOWN OF SAN ANSELMO

BOLINAS AVENUE REHABILITATION PROJECT

NOTES & CROSS SECTIONS

2.00

DESIGNED: RAC

DRAWN:	JKP
--------	-----

CHECKED:	RAC
REVIEWED:	

SALE: AS SHOWN

PAGE: 3 OF 11

PAVEMENT REHABILITATION NOTES:

1. SHOWN EXISTING UTILITIES WERE PLOTTED FROM RECORD INFORMATION AND FIELD TOPOGRAPHY. ACTUAL LOCATIONS MAY VARY AND ADDITIONAL CROSSINGS MAY EXIST IN THE FIELD. IT IS MANDATORY THAT "U.S.A. LOCATING SERVICES" LOCATE AND MARK EXISTING UTILITIES PRIOR TO THE START OF EXCAVATION.
2. THE CONTRACTOR SHALL USE EXTREME CAUTION WHEN EXPOSING EXISTING UTILITIES AND CROSSINGS AND SERVICES.
3. ANY DAMAGE TO EXISTING UTILITIES WILL BE THE SOLE RESPONSIBILITY OF THE CONTRACTOR.
4. THE CONTRACTOR SHALL CALL USA AT LEAST 7 DAYS BEFORE STARTING CONSTRUCTION FOR LOCATING UNDERGROUND UTILITIES WITHIN THE PROJECT LIMITS. VERIFY UTILITY LOCATIONS PRIOR TO PERFORMING WORK. THE CONTRACTOR SHALL TAKE DUE PRECAUTIONARY MEASURES TO PROTECT ALL UTILITIES WITHIN AND ADJACENT TO THE PROJECT AREA, INCLUDING BOTH THOSE SHOWN AND NOT SHOWN IN THIS PLAN SET. THE CONTRACTOR SHALL BE RESPONSIBLE FOR ANY DAMAGE TO UTILITIES.
5. ALL STORM, WATER, SEWER, GAS, AND ELECTRIC FACILITIES ARE DRAWN FROM RECORD DOCUMENTS. IT IS THE RESPONSIBILITY OF THE CONTRACTOR TO LOCATE AND ADJUST FACILITIES TO FINISHED ELEVATION IF REQUIRED. IMPACTED FACILITIES MAY INCLUDE, BUT ARE NOT LIMITED TO, MAINTENANCE HOLES, DRAIN INLETS, VALVES, CATHODIC PROTECTION TESTING STATIONS, ANODES, BOXES, AND VAULTS.
6. TIE OUT ALL MANHOLES, WATER VALVE COVERS, CLEAN OUTS, PULL BOXES, GS BOXES, AND MONUMENTS, THEN PROVIDE DATA TO THE TOWN REPRESENTATIVE 14 DAYS PRIOR TO GRINDING.
7. TIE OUT EXISTING PAVEMENT MARKINGS, STRIPING AND MARKERS, AND PROVIDE DATA TO THE TOWN REPRESENTATIVE 14 DAYS PRIOR TO GRINDING.
8. DO NOT START WORK WITHOUT AN APPROVED TRAFFIC CONTROL PLAN.
9. CONTRACTOR SHALL PROTECT MONUMENTS IN PLACE AND SHALL NOTIFY THE TOWN ENGINEER 7 DAYS PRIOR TO GRINDING IF ANY ARE IDENTIFIED WITHIN THE LIMITS OF THE WORK.

10. CONTRACTOR SHALL PROTECT IN PLACE ALL EXISTING PAINT OR THERMOPLASTIC OUTSIDE OF GRINDING LIMITS.
11. CONTRACTOR SHALL REPLACE ALL IMPACTED STRIPING, MARKINGS, REFLECTORS, ETC. IN KIND.
12. CONTRACTOR TO CONFORM NEW PAVEMENT TO EXISTING GRADE AT EDGE CONDITIONS INCLUDING, BUT NOT LIMITED TO, GUTTER LIPS, CURBS, GATES, DRIVEWAYS, DOORS, STRUCTURES, AND WALLS. SHOULD DEVIATIONS BE NECESSARY OR QUESTIONS ARISE, IMMEDIATELY SUBMIT RFI TO ENGINEER.

PAVEMENT REHABILITATION NOTES:

1. PROTECT IN PLACE AND ADJUST TO GRADE WATER VALVE
2. PROTECT IN PLACE AND ADJUST TO GRADE STORM DRAIN MANHOLE
3. PROTECT IN PLACE STORM DRAIN CATCH BASIN
4. PROTECT IN PLACE AND ADJUST TO GRADE SANITARY SEWER MANHOLE
5. PROTECT IN PLACE AND ADJUST TO GRADE SANITARY SEWER CLEANOUT
6. PROTECT IN PLACE AND ADJUST TO GRADE UNKNOWN UTILITY
7. PROTECT IN PLACE EXISTING CURB AND GUTTER, VERTICAL CURB, AC DIKE, WALL, STRUCTURE, ETC., TYPICAL
8. PROTECT IN PLACE EXISTING STRIPING
9. PROTECT IN PLACE AND ADJUST TO GRADE GAS VALVE
10. 8" GLUE DOWN CURB PER DETAIL 2 SHEET C5.00
11. SPEED HUMP PER DETAIL 1 SHEET C5.00

LEGEND:

SECTION 1
SEE SHEET C2.00.

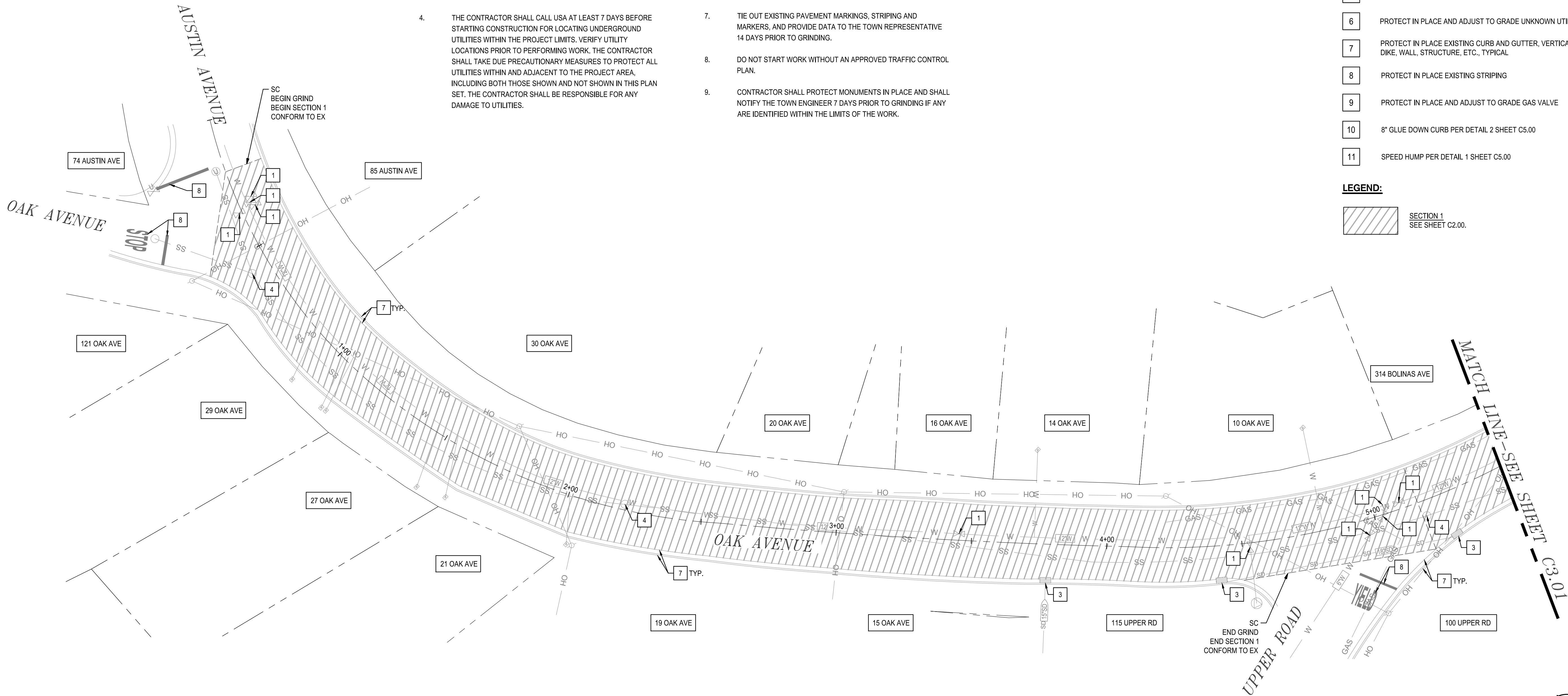

NOTES:

1. SHOWN EXISTING UTILITIES WERE PLOTTED FROM RECORD INFORMATION AND FIELD TOPOGRAPHY. ACTUAL LOCATIONS MAY VARY AND ADDITIONAL CROSSINGS MAY EXIST IN THE FIELD. IT IS MANDATORY THAT "U.S.A. LOCATING SERVICES" LOCATE AND MARK EXISTING UTILITIES PRIOR TO THE START OF EXCAVATION.
2. THE CONTRACTOR SHALL USE EXTREME CAUTION WHEN EXPOSING EXISTING UTILITY CROSSINGS AND SERVICES.
3. ANY DAMAGE TO EXISTING UTILITIES WILL BE THE SOLE RESPONSIBILITY OF THE CONTRACTOR.



Know what's below.
Call before you dig.



3428 Brookside Road
Stockton, CA 95219
Phone: 209-943-2021
Fax: 209-942-0214
www.siegfriedeng.com

- CIVIL ENGINEERING
- STRUCTURAL ENGINEERING
- LANDSCAPE ARCHITECTURE
- LAND SURVEYING
- PLANNING
- ATHLETIC FACILITY DESIGN

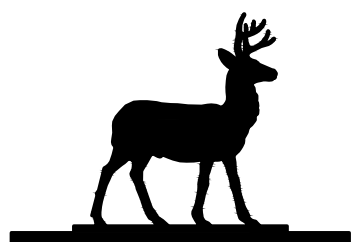

TOWN OF
SAN ANSELMO

525 San Anselmo Avenue, San Anselmo, CA 94960



DATE SIGNED: 05/06/20

ACCEPTED 05/06/20

TOWN ENGINEER

TOWN OF SAN ANSELMO

BOLINAS AVENUE REHABILITATION PROJECT

BOLINAS AVENUE LAYOUT I C3.00

REVISIONS	NO.	DESCRIPTION	DATE	BY	DRAWING DATE: 10/07/19	SHEET: 3 OF 11
					DESIGNED: RAC	SCALE: AS SHOWN
					DRAWN: JKP	
					CHECKED: RAC	

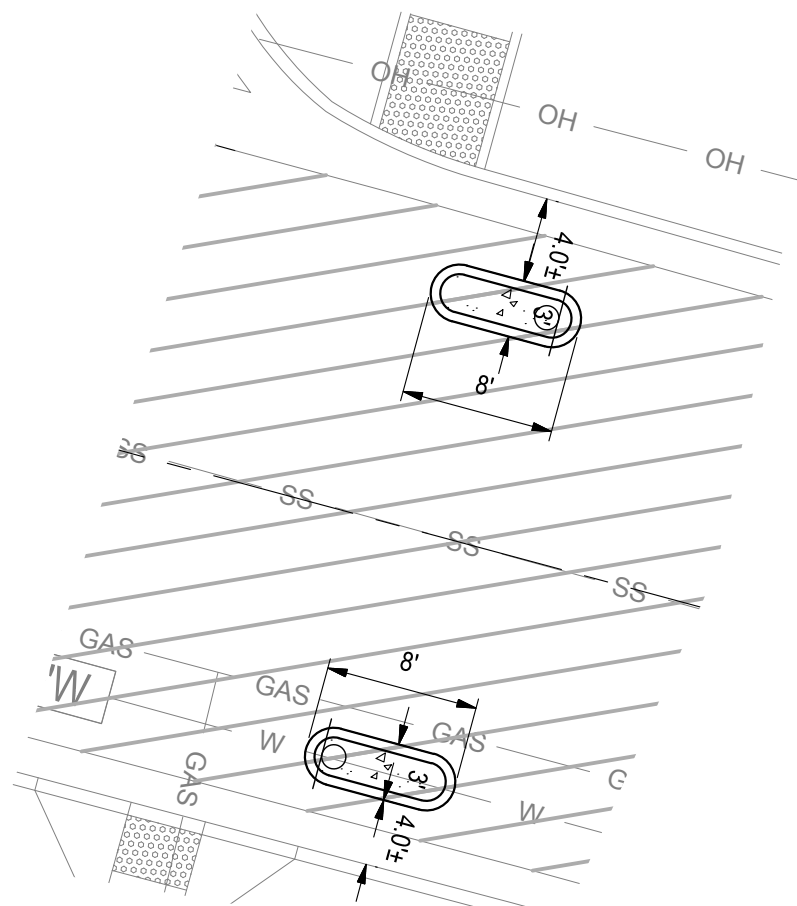

1 RAISED MEDIAN LAYOUT DETAIL
SCALE: 1"=10'

PAVEMENT REHABILITATION NOTES:

1. SHOWN EXISTING UTILITIES WERE PLOTTED FROM RECORD INFORMATION AND FIELD TOPOGRAPHY. ACTUAL LOCATIONS MAY VARY AND ADDITIONAL CROSSINGS MAY EXIST IN THE FIELD. IT IS MANDATORY THAT "U.S.A. LOCATING SERVICES" LOCATE AND MARK EXISTING UTILITIES PRIOR TO THE START OF EXCAVATION.
2. THE CONTRACTOR SHALL USE EXTREME CAUTION WHEN EXPOSING EXISTING UTILITIES AND CROSSINGS AND SERVICES.
3. ANY DAMAGE TO EXISTING UTILITIES WILL BE THE SOLE RESPONSIBILITY OF THE CONTRACTOR.
4. THE CONTRACTOR SHALL CALL USA AT LEAST 7 DAYS BEFORE STARTING CONSTRUCTION FOR LOCATING UNDERGROUND UTILITIES WITHIN THE PROJECT LIMITS. VERIFY UTILITY LOCATIONS PRIOR TO PERFORMING WORK. THE CONTRACTOR SHALL TAKE DUE PRECAUTIONARY MEASURES TO PROTECT ALL UTILITIES WITHIN AND ADJACENT TO THE PROJECT AREA, INCLUDING BOTH THOSE SHOWN AND NOT SHOWN IN THIS PLAN SET. THE CONTRACTOR SHALL BE RESPONSIBLE FOR ANY DAMAGE TO UTILITIES.
5. ALL STORM, WATER, SEWER, GAS, AND ELECTRIC FACILITIES ARE DRAWN FROM RECORD DOCUMENTS. IT IS THE RESPONSIBILITY OF THE CONTRACTOR TO LOCATE AND ADJUST FACILITIES TO FINISHED ELEVATION IF REQUIRED. IMPACTED FACILITIES MAY INCLUDE, BUT ARE NOT LIMITED TO, MAINTENANCE HOLES, DRAIN INLETS, VALVES, CATHODIC PROTECTION TESTING STATIONS, ANODES, BOXES, AND VAULTS.
6. TIE OUT ALL MANHOLES, WATER VALVE COVERS, CLEAN OUTS, PULL BOXES, GS BOXES, AND MONUMENTS, THEN PROVIDE DATA TO THE TOWN REPRESENTATIVE 14 DAYS PRIOR TO GRINDING.
7. TIE OUT EXISTING PAVEMENT MARKINGS, STRIPING AND MARKERS, AND PROVIDE DATA TO THE TOWN REPRESENTATIVE 14 DAYS PRIOR TO GRINDING.
8. DO NOT START WORK WITHOUT AN APPROVED TRAFFIC CONTROL PLAN.
9. CONTRACTOR SHALL PROTECT MONUMENTS IN PLACE AND SHALL NOTIFY THE TOWN ENGINEER 7 DAYS PRIOR TO GRINDING IF ANY ARE IDENTIFIED WITHIN THE LIMITS OF THE WORK.
10. CONTRACTOR SHALL PROTECT IN PLACE ALL EXISTING PAINT OR THERMOPLASTIC OUTSIDE OF GRINDING LIMITS.
11. CONTRACTOR SHALL REPLACE ALL IMPACTED STRIPING, MARKINGS, REFLECTORS, ETC. IN KIND.
12. CONTRACTOR TO CONFORM NEW PAVEMENT TO EXISTING GRADE AT EDGE CONDITIONS INCLUDING, BUT NOT LIMITED TO, GUTTER LIPS, CURBS, GATES, DRIVEWAYS, DOORS, STRUCTURES, AND WALLS. SHOULD DEVIATIONS BE NECESSARY OR QUESTIONS ARISE, IMMEDIATELY SUBMIT RFI TO ENGINEER.

PAVEMENT REHABILITATION NOTES:

1. PROTECT IN PLACE AND ADJUST TO GRADE WATER VALVE
2. PROTECT IN PLACE AND ADJUST TO GRADE STORM DRAIN MANHOLE
3. PROTECT IN PLACE STORM DRAIN CATCH BASIN
4. PROTECT IN PLACE AND ADJUST TO GRADE SANITARY SEWER MANHOLE
5. PROTECT IN PLACE AND ADJUST TO GRADE SANITARY SEWER CLEANOUT
6. PROTECT IN PLACE AND ADJUST TO GRADE UNKNOWN UTILITY
7. PROTECT IN PLACE EXISTING CURB AND GUTTER, VERTICAL CURB, AC DIKE, WALL, STRUCTURE, ETC., TYPICAL
8. PROTECT IN PLACE EXISTING STRIPING
9. PROTECT IN PLACE AND ADJUST TO GRADE GAS VALVE
10. 8" GLUE DOWN CURB PER DETAIL 2 SHEET C5.00, SEE DETAIL 1 THIS SHEET FOR LAYOUT
11. SPEED HUMP PER DETAIL 1 SHEET C5.00

LEGEND:

- SECTION 1
SEE SHEET C2.00.
- SECTION 3
SEE SHEET C2.00.
- CONCRETE
8.0" (3,500 PSI @ 28 DAYS) NORMAL WEIGHT CONCRETE
WITH #4 BARS AT 12" O.C. E.W. OVER EXISTING PAVEMENT
(SEE DETAIL 3 SHEET C5.00 FOR JOINT DETAILS)

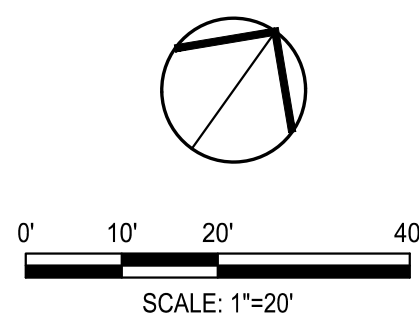
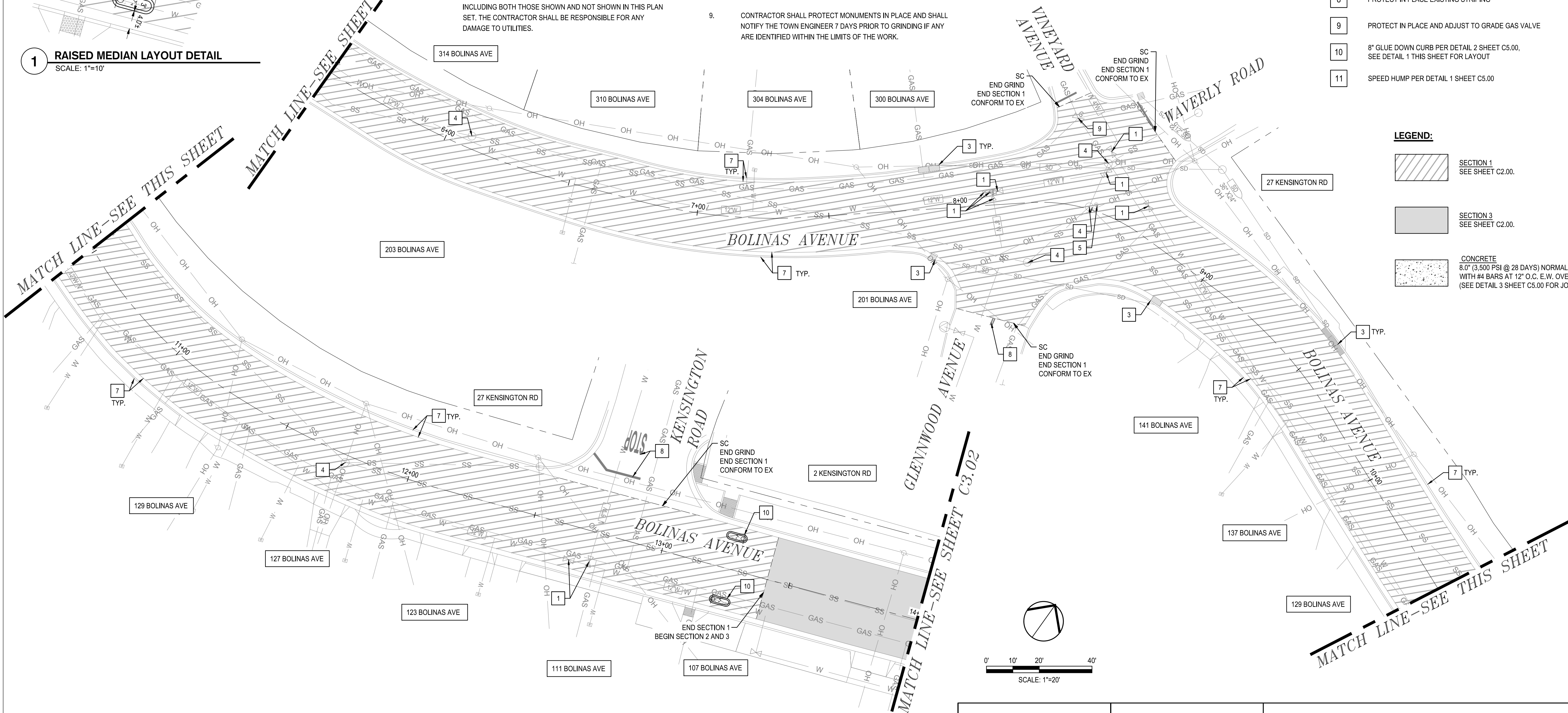

NOTES:

1. SHOWN EXISTING UTILITIES WERE PLOTTED FROM RECORD INFORMATION AND FIELD TOPOGRAPHY. ACTUAL LOCATIONS MAY VARY AND ADDITIONAL CROSSINGS MAY EXIST IN THE FIELD. IT IS MANDATORY THAT "U.S.A. LOCATING SERVICES" LOCATE AND MARK EXISTING UTILITIES PRIOR TO THE START OF EXCAVATION.
2. THE CONTRACTOR SHALL USE EXTREME CAUTION WHEN EXPOSING EXISTING UTILITY CROSSINGS AND SERVICES.
3. ANY DAMAGE TO EXISTING UTILITIES WILL BE THE SOLE RESPONSIBILITY OF THE CONTRACTOR.



Know what's below.
Call before you dig.

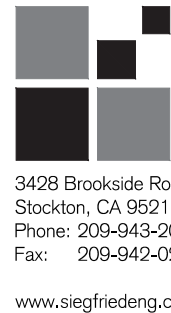

- CIVIL ENGINEERING
- STRUCTURAL ENGINEERING
- LANDSCAPE ARCHITECTURE
- LAND SURVEYING
- PLANNING
- ATHLETIC FACILITY DESIGN



525 San Anselmo Avenue, San Anselmo, CA 94960



DATE SIGNED: 05/06/20

ACCEPTED 05/06/20

[Signature]

TOWN ENGINEER

TOWN OF SAN ANSELMO

BOLINAS AVENUE REHABILITATION PROJECT

BOLINAS AVENUE LAYOUT II C3.01

NO.	DESCRIPTION	DATE	BY	DRAWING DATE: 10/07/19	SHEET: 4 OF 11
DESIGNED:	RAC				
DRAWN:	JKP				
CHECKED:	RAC				

PAVEMENT REHABILITATION NOTES:

1. SHOWN EXISTING UTILITIES WERE PLOTTED FROM RECORD INFORMATION AND FIELD TOPOGRAPHY. ACTUAL LOCATIONS MAY VARY AND ADDITIONAL CROSSINGS MAY EXIST IN THE FIELD. IT IS MANDATORY THAT "U.S.A. LOCATING SERVICES" LOCATE AND MARK EXISTING UTILITIES PRIOR TO THE START OF EXCAVATION.
2. THE CONTRACTOR SHALL USE EXTREME CAUTION WHEN EXPOSING EXISTING UTILITIES AND CROSSINGS AND SERVICES.
3. ANY DAMAGE TO EXISTING UTILITIES WILL BE THE SOLE RESPONSIBILITY OF THE CONTRACTOR.
4. THE CONTRACTOR SHALL CALL USA AT LEAST 7 DAYS BEFORE STARTING CONSTRUCTION FOR LOCATING UNDERGROUND UTILITIES WITHIN THE PROJECT LIMITS. VERIFY UTILITY LOCATIONS PRIOR TO PERFORMING WORK. THE CONTRACTOR SHALL TAKE DUE PRECAUTIONARY MEASURES TO PROTECT ALL UTILITIES WITHIN AND ADJACENT TO THE PROJECT AREA, INCLUDING BOTH THOSE SHOWN AND NOT SHOWN IN THIS PLAN SET. THE CONTRACTOR SHALL BE RESPONSIBLE FOR ANY DAMAGE TO UTILITIES.
5. ALL STORM, WATER, SEWER, GAS, AND ELECTRIC FACILITIES ARE DRAWN FROM RECORD DOCUMENTS. IT IS THE RESPONSIBILITY OF THE CONTRACTOR TO LOCATE AND ADJUST FACILITIES TO FINISHED ELEVATION IF REQUIRED. IMPACTED FACILITIES MAY INCLUDE, BUT ARE NOT LIMITED TO, MAINTENANCE HOLES, DRAIN INLETS, VALVES, CATHODIC PROTECTION TESTING STATIONS, ANODES, BOXES, AND VAULTS.
6. TIE OUT ALL MANHOLES, WATER VALVE COVERS, CLEAN OUTS, PULL BOXES, G5 BOXES, AND MONUMENTS, THEN PROVIDE DATA TO THE TOWN REPRESENTATIVE 14 DAYS PRIOR TO GRINDING.
7. TIE OUT EXISTING PAVEMENT MARKINGS, STRIPING AND MARKERS, AND PROVIDE DATA TO THE TOWN REPRESENTATIVE 14 DAYS PRIOR TO GRINDING.
8. DO NOT START WORK WITHOUT AN APPROVED TRAFFIC CONTROL PLAN.
9. CONTRACTOR SHALL PROTECT MONUMENTS IN PLACE AND SHALL NOTIFY THE TOWN ENGINEER 7 DAYS PRIOR TO GRINDING IF ANY ARE IDENTIFIED WITHIN THE LIMITS OF THE WORK.

LEGEND:

SECTION 2 AND SECTION 3
SEE SHEET C2.00.

PAVEMENT REHABILITATION NOTES:

1. PROTECT IN PLACE AND ADJUST TO GRADE WATER VALVE
2. PROTECT IN PLACE AND ADJUST TO GRADE STORM DRAIN MANHOLE
3. PROTECT IN PLACE STORM DRAIN CATCH BASIN
4. PROTECT IN PLACE AND ADJUST TO GRADE SANITARY SEWER MANHOLE
5. PROTECT IN PLACE AND ADJUST TO GRADE SANITARY SEWER CLEANOUT
6. PROTECT IN PLACE AND ADJUST TO GRADE UNKNOWN UTILITY
7. PROTECT IN PLACE EXISTING CURB AND GUTTER, VERTICAL CURB, AC DIKE, WALL, STRUCTURE, ETC., TYPICAL
8. PROTECT IN PLACE EXISTING STRIPING
9. PROTECT IN PLACE AND ADJUST TO GRADE GAS VALVE
10. 8" GLUE DOWN CURB PER DETAIL 2 SHEET C5.00
11. SPEED HUMP PER DETAIL 1 SHEET C5.00

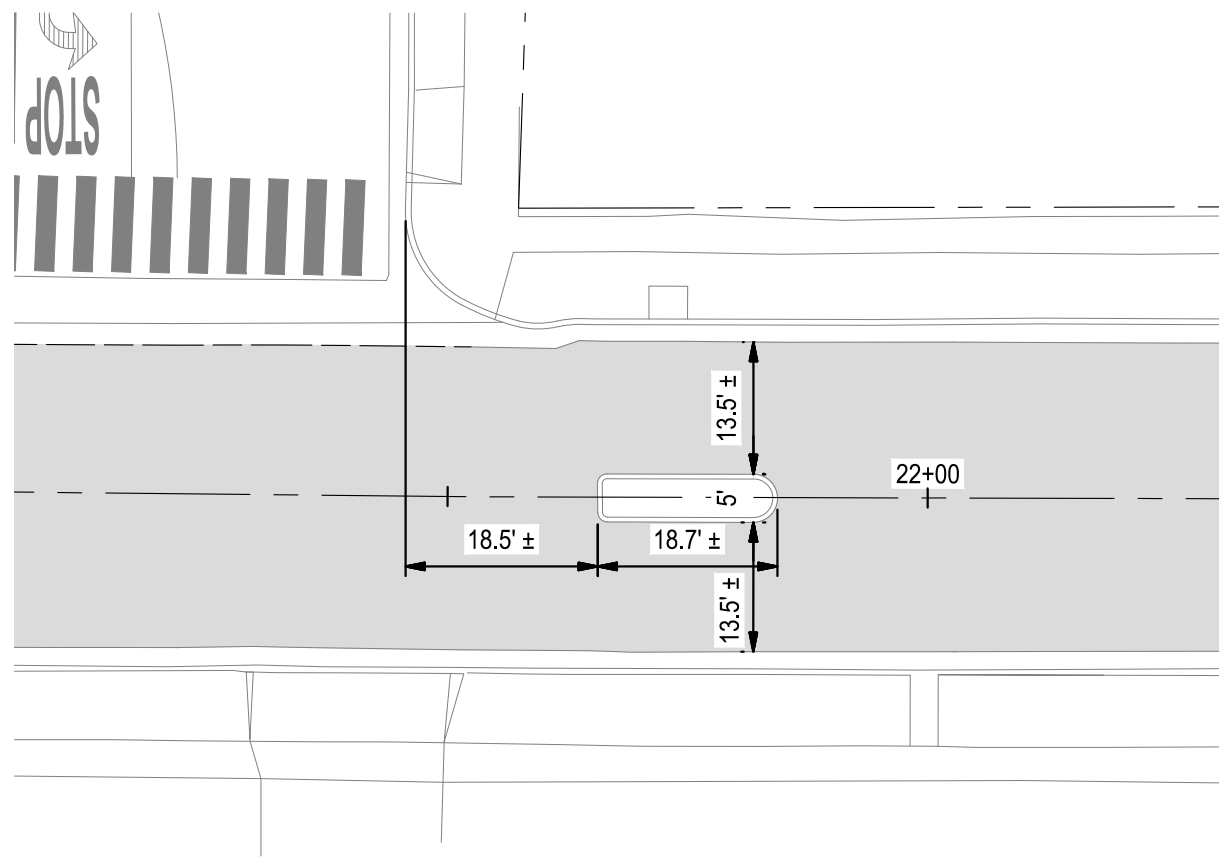

1 DIMENSION DETAIL
SCALE: 1"=20'

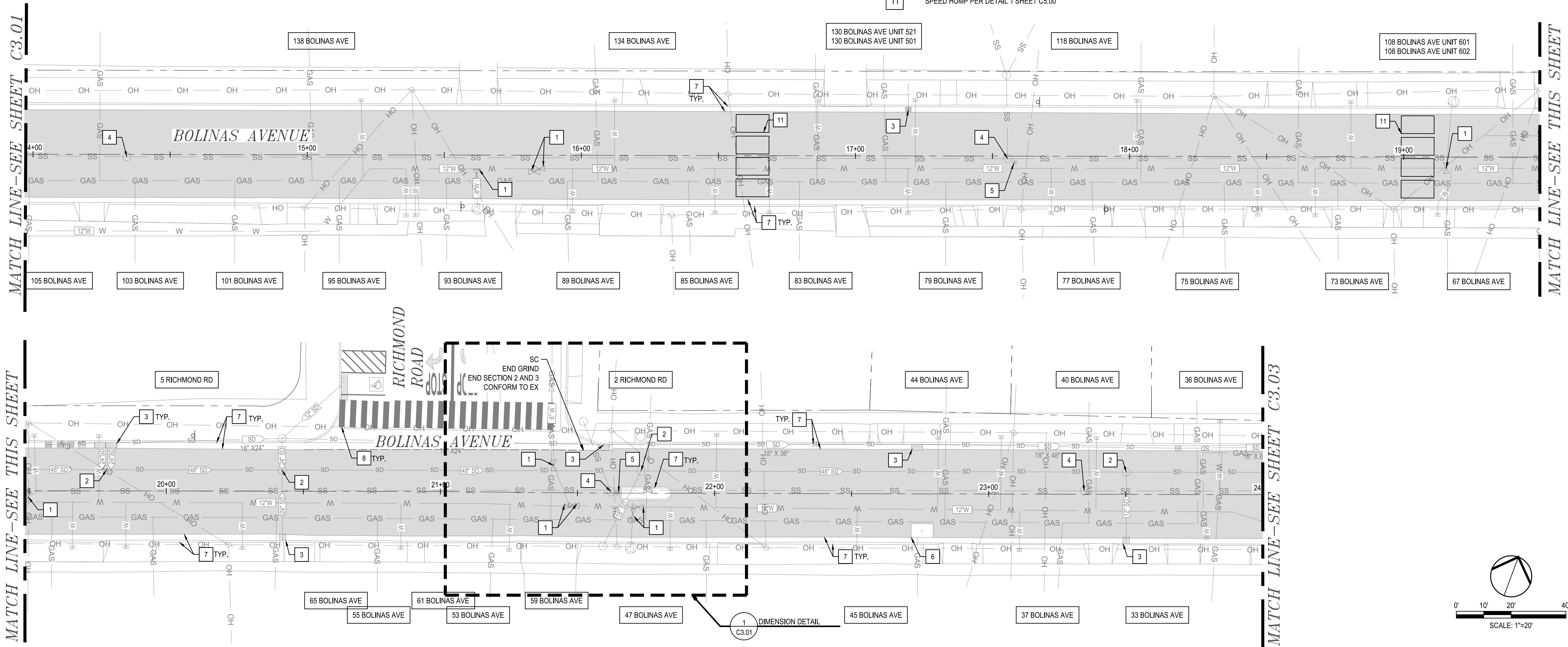

NOTES:

1. SHOWN EXISTING UTILITIES WERE PLOTTED FROM RECORD INFORMATION AND FIELD TOPOGRAPHY. ACTUAL LOCATIONS MAY VARY AND ADDITIONAL CROSSINGS MAY EXIST IN THE FIELD. IT IS MANDATORY THAT "U.S.A. LOCATING SERVICES" LOCATE AND MARK EXISTING UTILITIES PRIOR TO THE START OF EXCAVATION.
2. THE CONTRACTOR SHALL USE EXTREME CAUTION WHEN EXPOSING EXISTING UTILITY CROSSINGS AND SERVICES.
3. ANY DAMAGE TO EXISTING UTILITIES WILL BE THE SOLE RESPONSIBILITY OF THE CONTRACTOR.

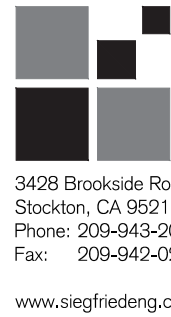

525 San Anselmo Avenue, San Anselmo, CA 94960



DATE SIGNED: 05/06/20

ACCEPTED 05/06/20

TOWN ENGINEER

TOWN OF SAN ANSELMO

BOLINAS AVENUE REHABILITATION PROJECT

BOLINAS AVENUE LAYOUT III C3.02

NO.	DESCRIPTION	DATE	BY	DRAWING DATE: 10/07/19	SHEET: 5 OF 11
DESIGNED:	RAC				SCALE: AS SHOWN
DRAWN:	JKP				
CHECKED:	RAC				

PAVEMENT REHABILITATION NOTES:

1.

SHOWN EXISTING UTILITIES WERE PLOTTED FROM RECORD INFORMATION AND FIELD TOPOGRAPHY. ACTUAL LOCATIONS MAY VARY AND ADDITIONAL CROSSINGS MAY EXIST IN THE FIELD. IT IS MANDATORY THAT "U.S.A. LOCATING SERVICES" LOCATE AND MARK EXISTING UTILITIES PRIOR TO THE START OF EXCAVATION.
2.

THE CONTRACTOR SHALL USE EXTREME CAUTION WHEN EXPOSING EXISTING UTILITIES AND CROSSINGS AND SERVICES.
3.

ANY DAMAGE TO EXISTING UTILITIES WILL BE THE SOLE RESPONSIBILITY OF THE CONTRACTOR.
4.

THE CONTRACTOR SHALL CALL USA AT LEAST 7 DAYS BEFORE STARTING CONSTRUCTION FOR LOCATING UNDERGROUND UTILITIES WITHIN THE PROJECT LIMITS. VERIFY UTILITY LOCATIONS PRIOR TO PERFORMING WORK. THE CONTRACTOR SHALL TAKE DUE PRECAUTIONARY MEASURES TO PROTECT ALL UTILITIES WITHIN AND ADJACENT TO THE PROJECT AREA, INCLUDING BOTH THOSE SHOWN AND NOT SHOWN IN THIS PLAN SET. THE CONTRACTOR SHALL BE RESPONSIBLE FOR ANY DAMAGE TO UTILITIES.
5.

ALL STORM, WATER, SEWER, GAS, AND ELECTRIC FACILITIES ARE DRAWN FROM RECORD DOCUMENTS. IT IS THE RESPONSIBILITY OF THE CONTRACTOR TO LOCATE AND ADJUST FACILITIES TO FINISHED ELEVATION IF REQUIRED. IMPACTED FACILITIES MAY INCLUDE, BUT ARE NOT LIMITED TO, MAINTENANCE HOLES, DRAIN INLETS, VALVES, CATHODIC PROTECTION TESTING STATIONS, ANODES, BOXES, AND VAULTS.
6.

TIE OUT ALL MANHOLES, WATER VALVE COVERS, CLEAN OUTS, PULL BOXES, GS BOXES, AND MONUMENTS, THEN PROVIDE DATA TO THE TOWN REPRESENTATIVE 14 DAYS PRIOR TO GRINDING.
7.

TIE OUT EXISTING PAVEMENT MARKINGS, STRIPING AND MARKERS, AND PROVIDE DATA TO THE TOWN REPRESENTATIVE 14 DAYS PRIOR TO GRINDING.
8.

DO NOT START WORK WITHOUT AN APPROVED TRAFFIC CONTROL PLAN.
9.

CONTRACTOR SHALL PROTECT MONUMENTS IN PLACE AND SHALL NOTIFY THE TOWN ENGINEER 7 DAYS PRIOR TO GRINDING IF ANY ARE IDENTIFIED WITHIN THE LIMITS OF THE WORK.
10.

CONTRACTOR SHALL PROTECT IN PLACE ALL EXISTING PAINT OR THERMOPLASTIC OUTSIDE OF GRINDING LIMITS.
11.

CONTRACTOR SHALL REPLACE ALL IMPACTED STRIPING, MARKINGS, REFLECTORS, ETC. IN KIND.
12.

CONTRACTOR TO CONFORM NEW PAVEMENT TO EXISTING GRADE AT EDGE CONDITIONS INCLUDING, BUT NOT LIMITED TO, GUTTER LIPS, CURBS, GATES, DRIVEWAYS, DOORS, STRUCTURES, AND WALLS. SHOULD DEVIATIONS BE NECESSARY OR QUESTIONS ARISE, IMMEDIATELY SUBMIT RFI TO ENGINEER.

LEGEND:

- SECTION 3 AND SECTION 4
SEE SHEET C2.00.
- SECTION 5
SEE SHEET C2.00.

PAVEMENT REHABILITATION NOTES:

- 1

PROTECT IN PLACE AND ADJUST TO GRADE WATER VALVE
- 2

PROTECT IN PLACE AND ADJUST TO GRADE STORM DRAIN MANHOLE
- 3

PROTECT IN PLACE STORM DRAIN CATCH BASIN
- 4

PROTECT IN PLACE AND ADJUST TO GRADE SANITARY SEWER MANHOLE
- 5

PROTECT IN PLACE AND ADJUST TO GRADE SANITARY SEWER CLEANOUT
- 6

PROTECT IN PLACE AND ADJUST TO GRADE UNKNOWN UTILITY
- 7

PROTECT IN PLACE EXISTING CURB AND GUTTER, VERTICAL CURB, AC DIKE, WALL, STRUCTURE, ETC., TYPICAL
- 8

PROTECT IN PLACE EXISTING STRIPING
- 9

PROTECT IN PLACE AND ADJUST TO GRADE GAS VALVE
- 10

8" GLUE DOWN CURB PER DETAIL 2 SHEET C5.00
- 11

SPEED HUMP PER DETAIL 1 SHEET C5.00

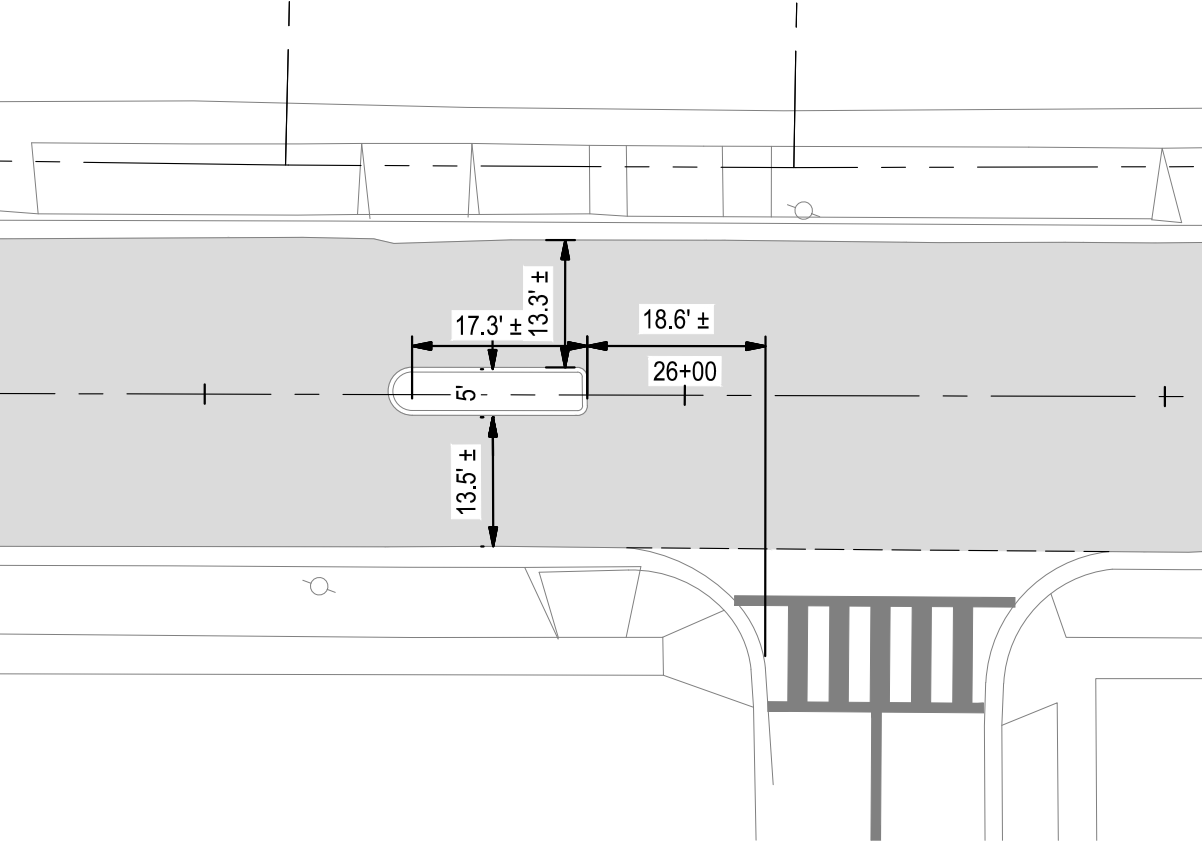
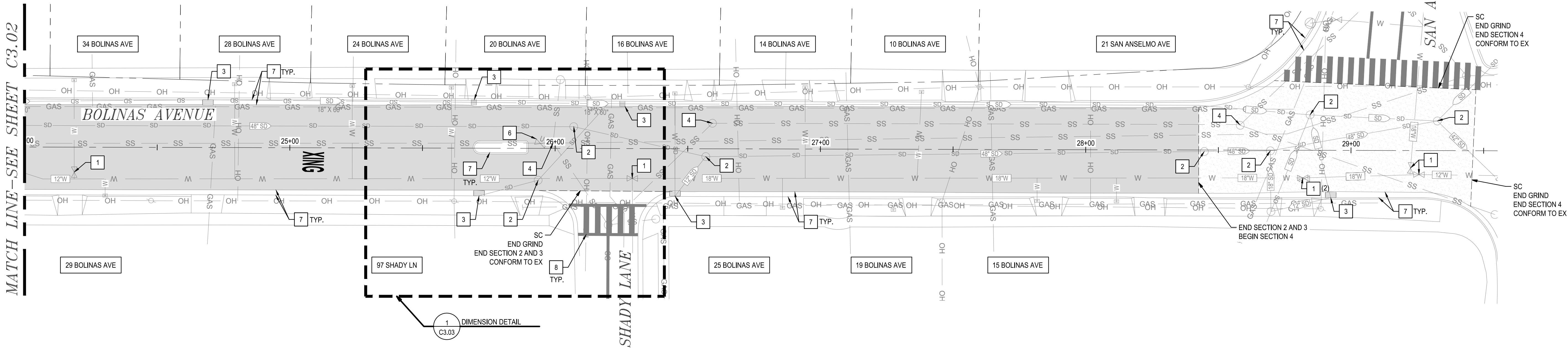

1 DIMENSION DETAIL
SCALE: 1"=20'

- NOTES:
1.

SHOWN EXISTING UTILITIES WERE PLOTTED FROM RECORD INFORMATION AND FIELD TOPOGRAPHY. ACTUAL LOCATIONS MAY VARY AND ADDITIONAL CROSSINGS MAY EXIST IN THE FIELD. IT IS MANDATORY THAT "U.S.A. LOCATING SERVICES" LOCATE AND MARK EXISTING UTILITIES PRIOR TO THE START OF EXCAVATION.
2.

THE CONTRACTOR SHALL USE EXTREME CAUTION WHEN EXPOSING EXISTING UTILITY CROSSINGS AND SERVICES.
3.

ANY DAMAGE TO EXISTING UTILITIES WILL BE THE SOLE RESPONSIBILITY OF THE CONTRACTOR.



525 San Anselmo Avenue, San Anselmo, CA 94960



DATE SIGNED: 05/06/20

ACCEPTED 05/06/20

[Signature]
TOWN ENGINEER

TOWN OF SAN ANSELMO

BOLINAS AVENUE REHABILITATION PROJECT







BOLINAS AVENUE LAYOUT IV C3.03

REVISIONS					DESIGNED: RAC	SCALE: AS SHOWN
					DRAWN: JKP	
					CHECKED: RAC	
					DRAWING DATE: 10/07/19	
NO.	DESCRIPTION	DATE	BY			SHEET: 6 OF 11

STRIPING NOTES:

- STRIPING AND SIGNING SHALL CONFORM TO THE APPLICABLE DETAILS OF THE CALIFORNIA DEPARTMENT OF TRANSPORTATION (CAL TRANS) 2018 STANDARD PLANS, STANDARD SPECIFICATIONS, THE LATEST CALIFORNIA MUTCD SUPPLEMENT, AND THE LATEST SUPPLEMENT.
- ALL STRIPING SHALL BE THERMOPLASTIC UNLESS OTHERWISE NOTED. ALL TRAFFIC STRIPES AND PAVEMENT MARKING SHALL BE APPLIED AT A THICKNESS OF 0.150 INCH.
- ANY EXISTING STRIPING THAT CONFLICTS WITH THE PROPOSED STRIPING SHALL BE REMOVED AT THE APPROVAL OF THE CITY ENGINEER.
- TIE OUT EXISTING PAVEMENT MARKINGS, STRIPING AND MARKERS, AND PROVIDE DATA TO THE TOWN REPRESENTATIVE 14 DAYS PRIOR TO GRINDING.
- DO NOT START WORK WITHOUT AN APPROVED TRAFFIC CONTROL PLAN.
- CONTRACTOR SHALL PROTECT IN PLACE ALL EXISTING PAINT OR THERMOPLASTIC OUTSIDE OF GRINDING LIMITS.
- CONTRACTOR SHALL REPLACE ALL IMPACTED STRIPING, MARKINGS, REFLECTORS, ETC. IN KIND.

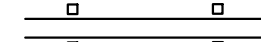
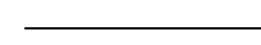
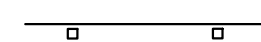
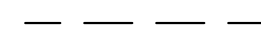
LEGEND

-  W13-P ADVISORY SPEED PLAQUE
-  W17-1 SPEED HUMP
-  W84(CA) SPEED HUMP AHEAD
-  R4-8 MEDIAN ON RIGHT SIDE
-  OM2-2H OBJECT MARKER
-  DETAIL 22 (4" DOUBLE YELLOW SOLID LINE WITH PAVEMENT MARKERS)
INTERSECTION MARKING LINE PER FIGURE 3A-104(CA)
-  DETAIL 27B (4" WHITE LINE) RIGHT EDGE MARKING LINE PER FIGURE 3A-106(CA)
-  DETAIL 38 (8" SOLID WHITE LINE WITH PAVEMENT MARKERS)
CHANNELIZING LANE MARKING LINE PER FIGURE 3A-112
-  DETAIL 41 (4" DASHED YELLOW LINE) CENTERLINE EXTENSION
THROUGH INTERSECTION PER FIGURE 3A-112 (CA)
-  CONCRETE CURB SHALL HAVE THE WORDS "NO PARKING FIRE LANE" PAINTED
AT INTERVALS NO MORE THAN TWENTY-FIVE FEET. LETTERS SHALL BE BLOCK
STYLE. MINIMUM FIVE (5) INCHES WITH A STROKE OF NOT LESS THAN 3/4 INCH,
AND SHALL BE WHITE ON A RED BACKGROUND.
-  CONTINENTAL CROSSWALK WITH 24" WHITE THERMOPLASTIC STRIPE
SPACED 48" ON CENTER PER FIGURE 3B-19 OF MUTCD



SHARROW PAVEMENT MARKING PER DETAIL ON SHEET C10-21 OF MUTCD
WITH GREEN BACK



PEDESTRIAN CROSSING PAVEMENT MARKING PER FIGURE 3B-23(CA) OF MUTCD



SPEED HUMP MARKING PER DETAIL 1 SHEET C5.00



STOP PAVEMENT MARKING PER FIGURE 3B-23(CA) MUTCD AND 12"
WHITE THERMOPLASTIC STOP BAR PER SECTION 3B.16 OF MUTCD



TYPE VII ARROW PER FIGURE 3B-24(CA) OF MUTCD



TYPE IV ARROW PER FIGURE 3B-24(CA) OF MUTCD



SPEED LIMIT PAVEMENT MARKING PER FIGURE 3B-23(CA) OF MUTCD

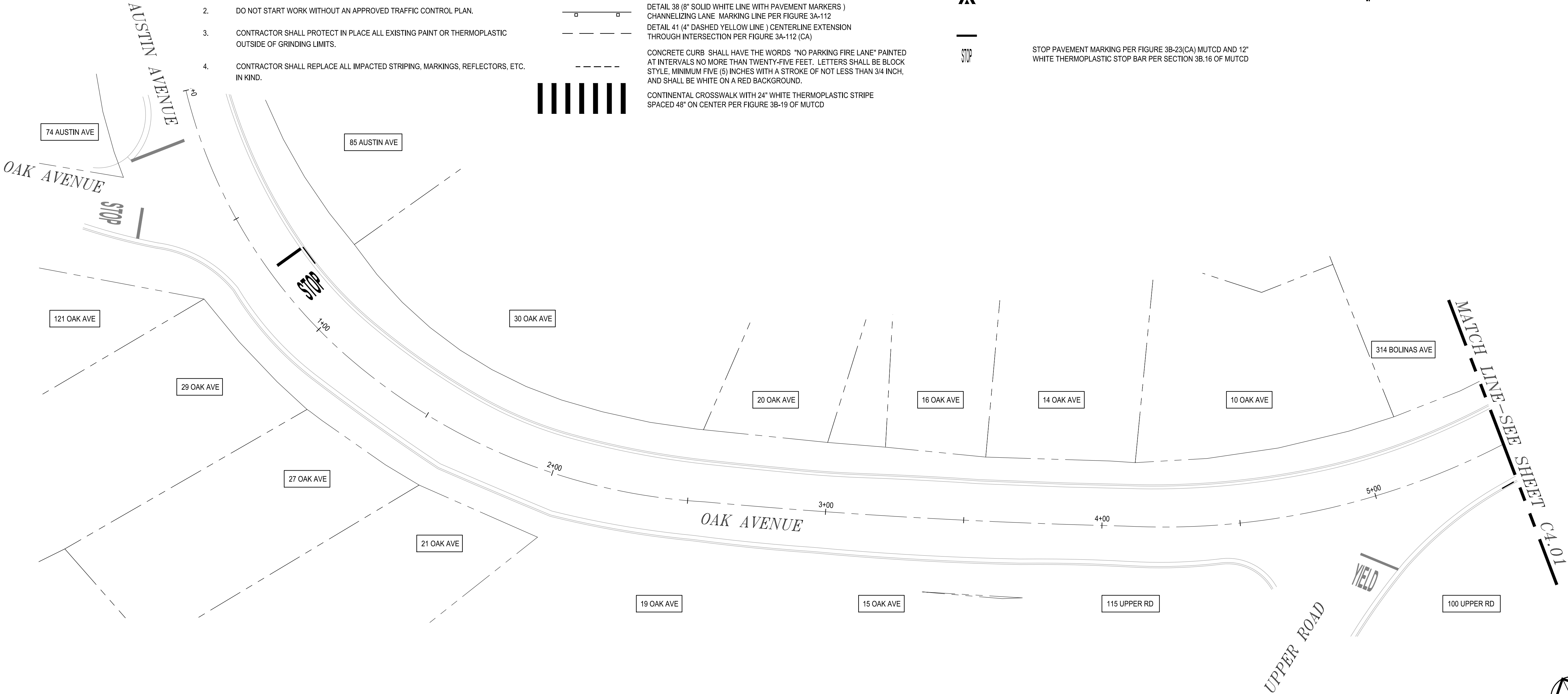

0' 10' 20' 40'
SCALE: 1"=20'

NOTES:

- SHOWN EXISTING UTILITIES WERE PLOTTED FROM RECORD INFORMATION AND FIELD TOPOGRAPHY. ACTUAL LOCATIONS MAY VARY AND ADDITIONAL CROSSINGS MAY EXIST IN THE FIELD. IT IS MANDATORY THAT "U.S.A. LOCATING SERVICES" LOCATE AND MARK EXISTING UTILITIES PRIOR TO THE START OF EXCAVATION.
- THE CONTRACTOR SHALL USE EXTREME CAUTION WHEN EXPOSING EXISTING UTILITY CROSSINGS AND SERVICES.
- ANY DAMAGE TO EXISTING UTILITIES WILL BE THE SOLE RESPONSIBILITY OF THE CONTRACTOR.



Know what's below.
Call before you dig.



3428 Brookside Road
Stockton, CA 95219
Phone: 209-943-2021
Fax: 209-942-0214
www.siegfriedeng.com

- CIVIL ENGINEERING
- STRUCTURAL ENGINEERING
- LANDSCAPE ARCHITECTURE
- LAND SURVEYING
- PLANNING
- ATHLETIC FACILITY DESIGN

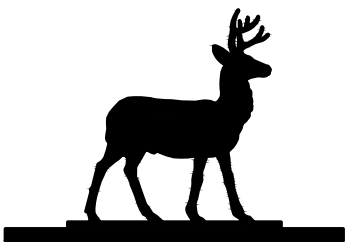

TOWN OF
SAN ANSELMO

525 San Anselmo Avenue, San Anselmo, CA 94960



DATE SIGNED: 05/06/20

ACCEPTED 05/06/20

TOWN ENGINEER

TOWN OF SAN ANSELMO

BOLINAS AVENUE REHABILITATION PROJECT

BOLINAS AVENUE STRIPING I C4.00

REVISIONS	NO.	DESCRIPTION	DATE	BY	DRAWING DATE: 10/07/19

DESIGNED: RAC
DRAWN: JKP
CHECKED: RAC

SCALE: AS SHOWN
SHEET: 7 OF 11

STRIPING NOTES:

- STRIPING AND SIGNING SHALL CONFORM TO THE APPLICABLE DETAILS OF THE CALIFORNIA DEPARTMENT OF TRANSPORTATION (CAL TRANS) 2018 STANDARD PLANS, STANDARD SPECIFICATIONS, THE LATEST CALIFORNIA MUTCD SUPPLEMENT, AND THE LATEST SUPPLEMENT.
- ALL STRIPING SHALL BE THERMOPLASTIC UNLESS OTHERWISE NOTED. ALL TRAFFIC STRIPES AND PAVEMENT MARKING SHALL BE APPLIED AT A THICKNESS OF 0.150 INCH.
- ANY EXISTING STRIPING THAT CONFLICTS WITH THE PROPOSED STRIPING SHALL BE REMOVED AT THE APPROVAL OF THE CITY ENGINEER.
- TIE OUT EXISTING PAVEMENT MARKINGS, STRIPING AND MARKERS, AND PROVIDE DATA TO THE TOWN REPRESENTATIVE 14 DAYS PRIOR TO GRINDING.
- DO NOT START WORK WITHOUT AN APPROVED TRAFFIC CONTROL PLAN.
- CONTRACTOR SHALL PROTECT IN PLACE ALL EXISTING PAINT OR THERMOPLASTIC OUTSIDE OF GRINDING LIMITS.
- CONTRACTOR SHALL REPLACE ALL IMPACTED STRIPING, MARKINGS, REFLECTORS, ETC. IN KIND.

LEGEND

- W13-P ADVISORY SPEED PLAQUE
- W17-1 SPEED HUMP
- W84(CA) SPEED HUMP AHEAD
- R4-8 MEDIAN ON RIGHT SIDE
- OM2-2H OBJECT MARKER
- DETAIL 22 (4" DOUBLE YELLOW SOLID LINE WITH PAVEMENT MARKERS) INTERSECTION MARKING LINE PER FIGURE 3A-104(CA)
- DETAIL 27B (4" WHITE LINE) RIGHT EDGE MARKING LINE PER FIGURE 3A-106(CA)
- DETAIL 38 (8" SOLID WHITE LINE WITH PAVEMENT MARKERS) CHANNELIZING LANE MARKING LINE PER FIGURE 3A-112
- DETAIL 41 (4" DASHED YELLOW LINE) CENTERLINE EXTENSION THROUGH INTERSECTION PER FIGURE 3A-112 (CA)
- CONCRETE CURB SHALL HAVE THE WORDS "NO PARKING FIRE LANE" PAINTED AT INTERVALS NO MORE THAN TWENTY-FIVE FEET. LETTERS SHALL BE BLOCK STYLE, MINIMUM FIVE (5) INCHES WITH A STROKE OF NOT LESS THAN 3/4 INCH, AND SHALL BE WHITE ON A RED BACKGROUND.
- CONTINENTAL CROSSWALK WITH 24" WHITE THERMOPLASTIC STRIPE SPACED 48" ON CENTER PER FIGURE 3B-19 OF MUTCD



SHARROW PAVEMENT MARKING PER DETAIL ON SHEET C10-21 OF MUTCD WITH GREEN BACK

PEDESTRIAN CROSSING PAVEMENT MARKING PER FIGURE 3B-23(CA) OF MUTCD

SPEED HUMP MARKING PER DETAIL 1 SHEET C5.00

STOP PAVEMENT MARKING PER FIGURE 3B-23(CA) MUTCD AND 12" WHITE THERMOPLASTIC STOP BAR PER SECTION 3B.16 OF MUTCD



TYPE VII ARROW PER FIGURE 3B-24(CA) OF MUTCD



TYPE IV ARROW PER FIGURE 3B-24(CA) OF MUTCD



SPEED LIMIT PAVEMENT MARKING PER FIGURE 3B-23(CA) OF MUTCD

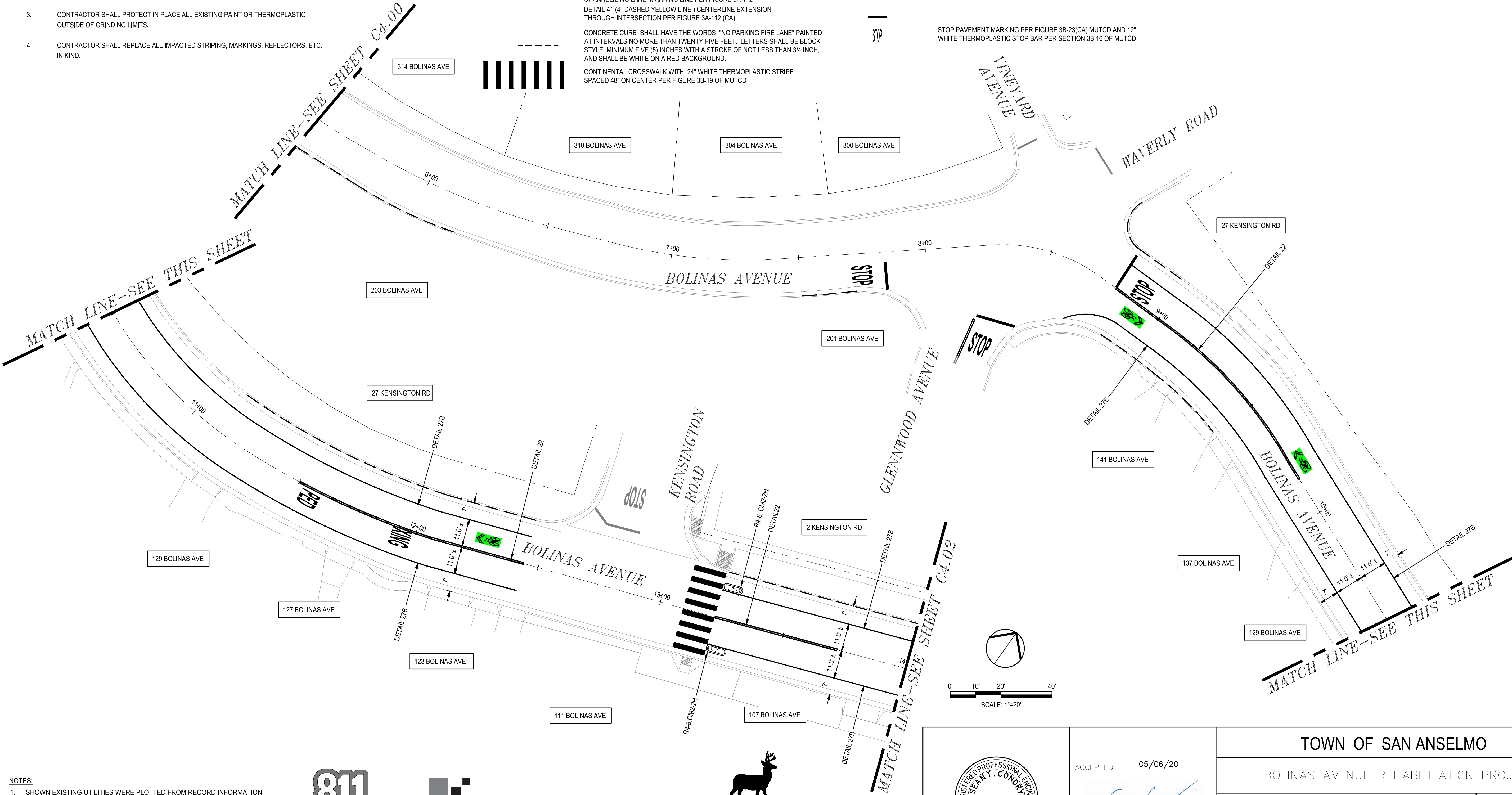

NOTES:

- SHOWN EXISTING UTILITIES WERE PLOTTED FROM RECORD INFORMATION AND FIELD TOPOGRAPHY. ACTUAL LOCATIONS MAY VARY AND ADDITIONAL CROSSINGS MAY EXIST IN THE FIELD. IT IS MANDATORY THAT "U.S.A. LOCATING SERVICES" LOCATE AND MARK EXISTING UTILITIES PRIOR TO THE START OF EXCAVATION.
- THE CONTRACTOR SHALL USE EXTREME CAUTION WHEN EXPOSING EXISTING UTILITY CROSSINGS AND SERVICES.
- ANY DAMAGE TO EXISTING UTILITIES WILL BE THE SOLE RESPONSIBILITY OF THE CONTRACTOR.

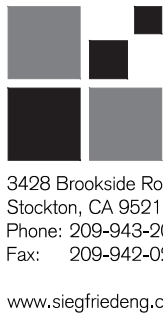

- CIVIL ENGINEERING
- STRUCTURAL ENGINEERING
- LANDSCAPE ARCHITECTURE
- LAND SURVEYING
- PLANNING
- ATHLETIC FACILITY DESIGN



525 San Anselmo Avenue, San Anselmo, CA 94960



DATE SIGNED: 05/06/20

ACCEPTED 05/06/20

TOWN ENGINEER

TOWN OF SAN ANSELMO

BOLINAS AVENUE REHABILITATION PROJECT

BOLINAS AVENUE STRIPING II C4.01

DESIGNED: RAC	SCALE: AS SHOWN
DRAWN: JKP	
CHECKED: RAC	
DRAWING DATE: 10/07/19	SHEET: 8 OF 11

STRIPING NOTES:

1. STRIPING AND SIGNING SHALL CONFORM TO THE APPLICABLE DETAILS OF THE CALIFORNIA DEPARTMENT OF TRANSPORTATION (CAL TRANS) 2018 STANDARD PLANS, STANDARD SPECIFICATIONS, THE LATEST CALIFORNIA MUTCD SUPPLEMENT, AND THE LATEST SUPPLEMENT.
2. ALL STRIPING SHALL BE THERMOPLASTIC UNLESS OTHERWISE NOTED. ALL TRAFFIC STRIPES AND PAVEMENT MARKING SHALL BE APPLIED AT A THICKNESS OF 0.150 INCH.
3. ANY EXISTING STRIPING THAT CONFLICTS WITH THE PROPOSED STRIPING SHALL BE REMOVED AT THE APPROVAL OF THE CITY ENGINEER.
1. TIE OUT EXISTING PAVEMENT MARKINGS, STRIPING AND MARKERS, AND PROVIDE DATA TO THE TOWN REPRESENTATIVE 14 DAYS PRIOR TO GRINDING.
2. DO NOT START WORK WITHOUT AN APPROVED TRAFFIC CONTROL PLAN.
3. CONTRACTOR SHALL PROTECT IN PLACE ALL EXISTING PAINT OR THERMOPLASTIC OUTSIDE OF GRINDING LIMITS.
4. CONTRACTOR SHALL REPLACE ALL IMPACTED STRIPING, MARKINGS, REFLECTORS, ETC. IN KIND.

LEGEND

- W13-P ADVISORY SPEED PLAQUE
- W17-1 SPEED HUMP
- W84(CA) SPEED HUMP AHEAD
- R4-8 MEDIAN ON RIGHT SIDE
- OM2-2H OBJECT MARKER
- DETAIL 22 (4" DOUBLE YELLOW SOLID LINE WITH PAVEMENT MARKERS)
INTERSECTION MARKING LINE PER FIGURE 3A-104(CA)
- DETAIL 27B (4" WHITE LINE) RIGHT EDGE MARKING LINE PER FIGURE 3A-106(CA)
- DETAIL 38 (8" SOLID WHITE LINE WITH PAVEMENT MARKERS)
CHANNELIZING LANE MARKING LINE PER FIGURE 3A-112 (CA)
- DETAIL 41 (4" DASHED YELLOW LINE) CENTERLINE EXTENSION
THROUGH INTERSECTION PER FIGURE 3A-112 (CA)
- CONCRETE CURB SHALL HAVE THE WORDS "NO PARKING FIRE LANE" PAINTED
AT INTERVALS NO MORE THAN TWENTY-FIVE FEET. LETTERS SHALL BE BLOCK
STYLE, MINIMUM FIVE (5) INCHES WITH A STROKE OF NOT LESS THAN 3/4 INCH,
AND SHALL BE WHITE ON A RED BACKGROUND.
- CONTINENTAL CROSSWALK WITH 24" WHITE THERMOPLASTIC STRIPE
SPACED 48" ON CENTER PER FIGURE 3B-19 OF MUTCD



SHARROW PAVEMENT MARKING PER DETAIL ON SHEET C10-21 OF MUTCD
WITH GREEN BACK

PEDESTRIAN CROSSING PAVEMENT MARKING PER FIGURE 3B-23(CA) OF MUTCD

SPEED HUMP MARKING PER DETAIL 1 SHEET C5.00

STOP PAVEMENT MARKING PER FIGURE 3B-23(CA) MUTCD AND 12"
WHITE THERMOPLASTIC STOP BAR PER SECTION 3B.16 OF MUTCD



TYPE VII ARROW PER FIGURE 3B-24(CA) OF MUTCD



TYPE IV ARROW PER FIGURE 3B-24(CA) OF MUTCD



SPEED LIMIT PAVEMENT MARKING PER FIGURE 3B-23(CA) OF MUTCD

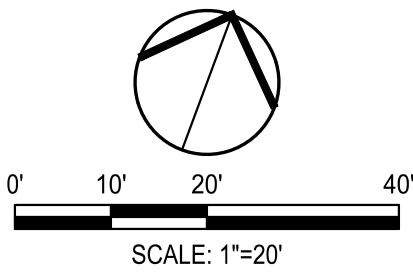
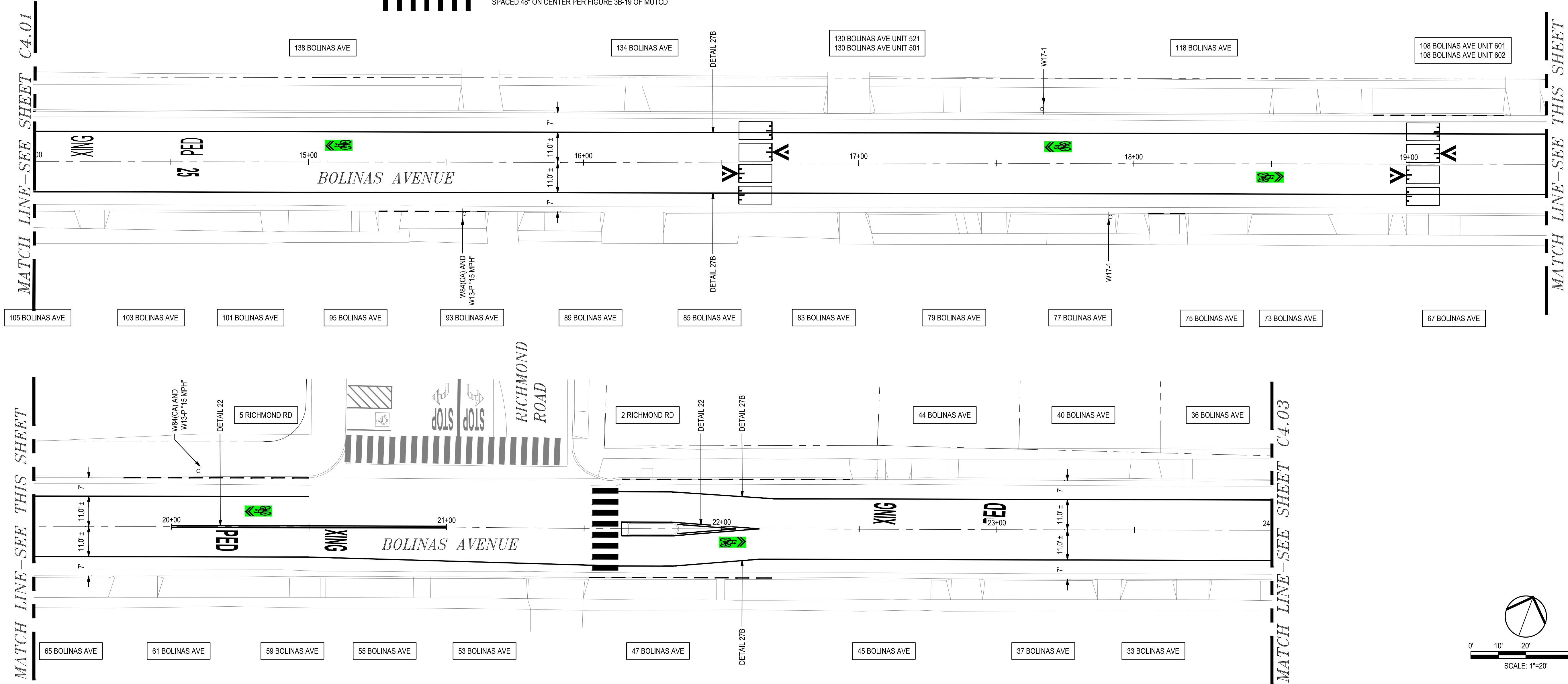

NOTES:

1. SHOWN EXISTING UTILITIES WERE PLOTTED FROM RECORD INFORMATION AND FIELD TOPOGRAPHY. ACTUAL LOCATIONS MAY VARY AND ADDITIONAL CROSSINGS MAY EXIST IN THE FIELD. IT IS MANDATORY THAT "U.S.A. LOCATING SERVICES" LOCATE AND MARK EXISTING UTILITIES PRIOR TO THE START OF EXCAVATION.
2. THE CONTRACTOR SHALL USE EXTREME CAUTION WHEN EXPOSING EXISTING UTILITY CROSSINGS AND SERVICES.
3. ANY DAMAGE TO EXISTING UTILITIES WILL BE THE SOLE RESPONSIBILITY OF THE CONTRACTOR.



Know what's below.
Call before you dig.



SIEGFRIED

3428 Brookside Road
Stockton, CA 95219
Phone: 209-943-2021
Fax: 209-942-0214
www.siegfriedeng.com

- CIVIL ENGINEERING
- STRUCTURAL ENGINEERING
- LANDSCAPE ARCHITECTURE
- LAND SURVEYING
- PLANNING
- ATHLETIC FACILITY DESIGN

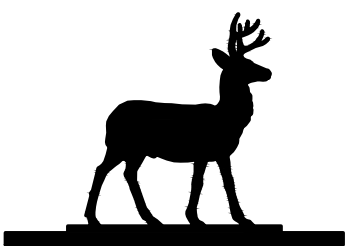

TOWN OF
SAN ANSELMO

525 San Anselmo Avenue, San Anselmo, CA 94960



DATE SIGNED: 05/06/20

ACCEPTED 05/06/20

[Signature]

TOWN ENGINEER

TOWN OF SAN ANSELMO

BOLINAS AVENUE REHABILITATION PROJECT

BOLINAS AVENUE STRIPING III

C4.02

REVISIONS	NO.	DESCRIPTION	DATE	BY	DRAWING DATE: 10/07/19

DESIGNED: RAC
DRAWN: JKP
CHECKED: RAC

SCALE: AS SHOWN

SHEET: 9 OF 11

STRIPING NOTES:

- STRIPING AND SIGNING SHALL CONFORM TO THE APPLICABLE DETAILS OF THE CALIFORNIA DEPARTMENT OF TRANSPORTATION (CAL TRANS) 2018 STANDARD PLANS, STANDARD SPECIFICATIONS, THE LATEST CALIFORNIA MUTCD SUPPLEMENT, AND THE LATEST SUPPLEMENT.
- ALL STRIPING SHALL BE THERMOPLASTIC UNLESS OTHERWISE NOTED. ALL TRAFFIC STRIPES AND PAVEMENT MARKING SHALL BE APPLIED AT A THICKNESS OF 0.150 INCH.
- ANY EXISTING STRIPING THAT CONFLICTS WITH THE PROPOSED STRIPING SHALL BE REMOVED AT THE APPROVAL OF THE CITY ENGINEER.
- TIE OUT EXISTING PAVEMENT MARKINGS, STRIPING AND MARKERS, AND PROVIDE DATA TO THE TOWN REPRESENTATIVE 14 DAYS PRIOR TO GRINDING.
- DO NOT START WORK WITHOUT AN APPROVED TRAFFIC CONTROL PLAN.
- CONTRACTOR SHALL PROTECT IN PLACE ALL EXISTING PAINT OR THERMOPLASTIC OUTSIDE OF GRINDING LIMITS.
- CONTRACTOR SHALL REPLACE ALL IMPACTED STRIPING, MARKINGS, REFLECTORS, ETC. IN KIND.

LEGEND

- | | | |
|--|---|--|
| | W13-P | ADVISORY SPEED PLAQUE |
| | W17-1 | SPEED HUMP |
| | W84(CA) | SPEED HUMP AHEAD |
| | R4-8 | MEDIAN ON RIGHT SIDE |
| | OM2-2H | OBJECT MARKER |
| | DETAIL 22 (4" DOUBLE YELLOW SOLID LINE WITH PAVEMENT MARKERS) | INTERSECTION MARKING LINE PER FIGURE 3A-104(CA) |
| | DETAIL 27B (4" WHITE LINE) | RIGHT EDGE MARKING LINE PER FIGURE 3A-106(CA) |
| | DETAIL 38 (8" SOLID WHITE LINE WITH PAVEMENT MARKERS) | CHANNELIZING LANE MARKING LINE PER FIGURE 3A-112 (CA) |
| | DETAIL 41 (4" DASHED YELLOW LINE) | CENTERLINE EXTENSION THROUGH INTERSECTION PER FIGURE 3A-112 (CA) |
| | CONCRETE CURB | SHALL HAVE THE WORDS "NO PARKING FIRE LANE" PAINTED AT INTERVALS NO MORE THAN TWENTY-FIVE FEET. LETTERS SHALL BE BLOCK STYLE, MINIMUM FIVE (5) INCHES WITH A STROKE OF NOT LESS THAN 3/4 INCH, AND SHALL BE WHITE ON A RED BACKGROUND. |
| | CONTINENTAL CROSSWALK WITH 24" WHITE THERMOPLASTIC STRIPE | SPACED 48" ON CENTER PER FIGURE 3B-19 OF MUTCD |



SHARROW PAVEMENT MARKING PER DETAIL ON SHEET C10-21 OF MUTCD WITH GREEN BACK

XING

PED

PEDESTRIAN CROSSING PAVEMENT MARKING PER FIGURE 3B-23(CA) OF MUTCD



SPEED HUMP MARKING PER DETAIL 1 SHEET C5.00

STOP

STOP PAVEMENT MARKING PER FIGURE 3B-23(CA) MUTCD AND 12" WHITE THERMOPLASTIC STOP BAR PER SECTION 3B.16 OF MUTCD



TYPE VII ARROW PER FIGURE 3B-24(CA) OF MUTCD



TYPE IV ARROW PER FIGURE 3B-24(CA) OF MUTCD



SPEED LIMIT PAVEMENT MARKING PER FIGURE 3B-23(CA) OF MUTCD

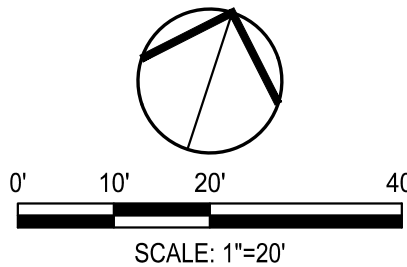
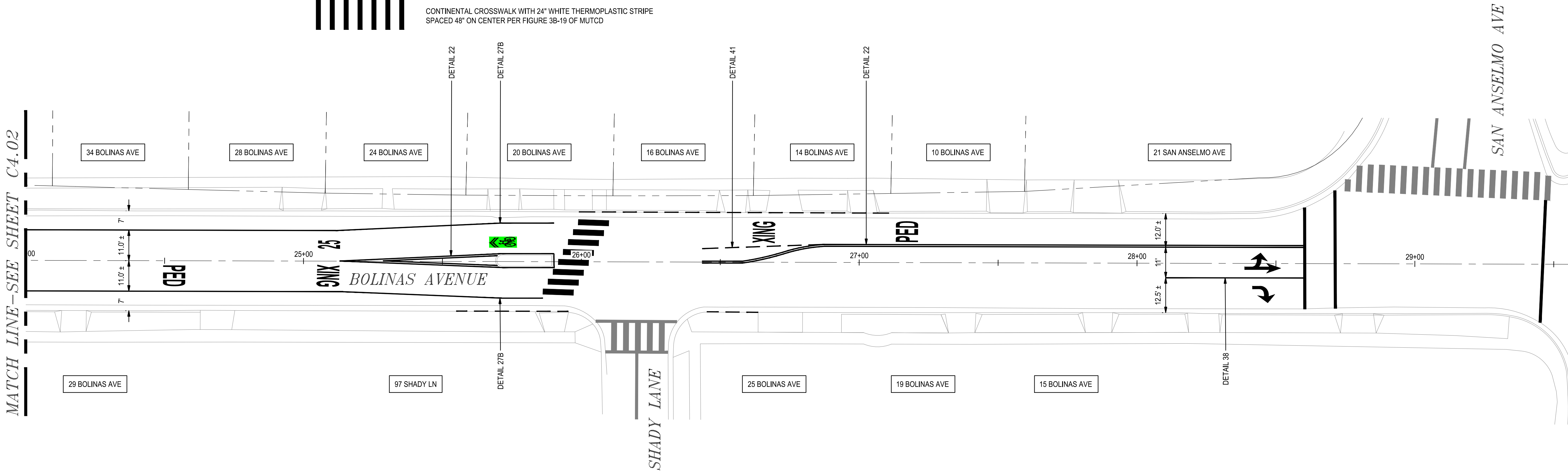

NOTES:

- SHOWN EXISTING UTILITIES WERE PLOTTED FROM RECORD INFORMATION AND FIELD TOPOGRAPHY. ACTUAL LOCATIONS MAY VARY AND ADDITIONAL CROSSINGS MAY EXIST IN THE FIELD. IT IS MANDATORY THAT "U.S.A. LOCATING SERVICES" LOCATE AND MARK EXISTING UTILITIES PRIOR TO THE START OF EXCAVATION.
- THE CONTRACTOR SHALL USE EXTREME CAUTION WHEN EXPOSING EXISTING UTILITY CROSSINGS AND SERVICES.
- ANY DAMAGE TO EXISTING UTILITIES WILL BE THE SOLE RESPONSIBILITY OF THE CONTRACTOR.



Know what's below.
Call before you dig.



3428 Brookside Road
Stockton, CA 95219
Phone: 209-943-0221
Fax: 209-942-0214
www.siegfriedeng.com

- CIVIL ENGINEERING
- STRUCTURAL ENGINEERING
- LANDSCAPE ARCHITECTURE
- LAND SURVEYING
- PLANNING
- ATHLETIC FACILITY DESIGN

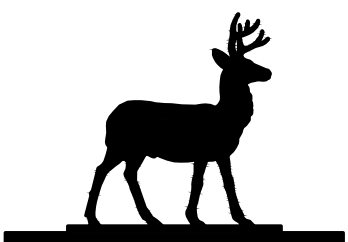

TOWN OF
SAN ANSELMO

525 San Anselmo Avenue, San Anselmo, CA 94960



DATE SIGNED: 05/06/20

ACCEPTED 05/06/20

[Signature]

TOWN ENGINEER

TOWN OF SAN ANSELMO

BOLINAS AVENUE REHABILITATION PROJECT

BOLINAS AVENUE STRIPING IV

C4.03

DESIGNED:	RAC
DRAWN:	JKP
CHECKED:	RAC
DRAWING DATE:	10/07/19

SHEET: 10 OF 11

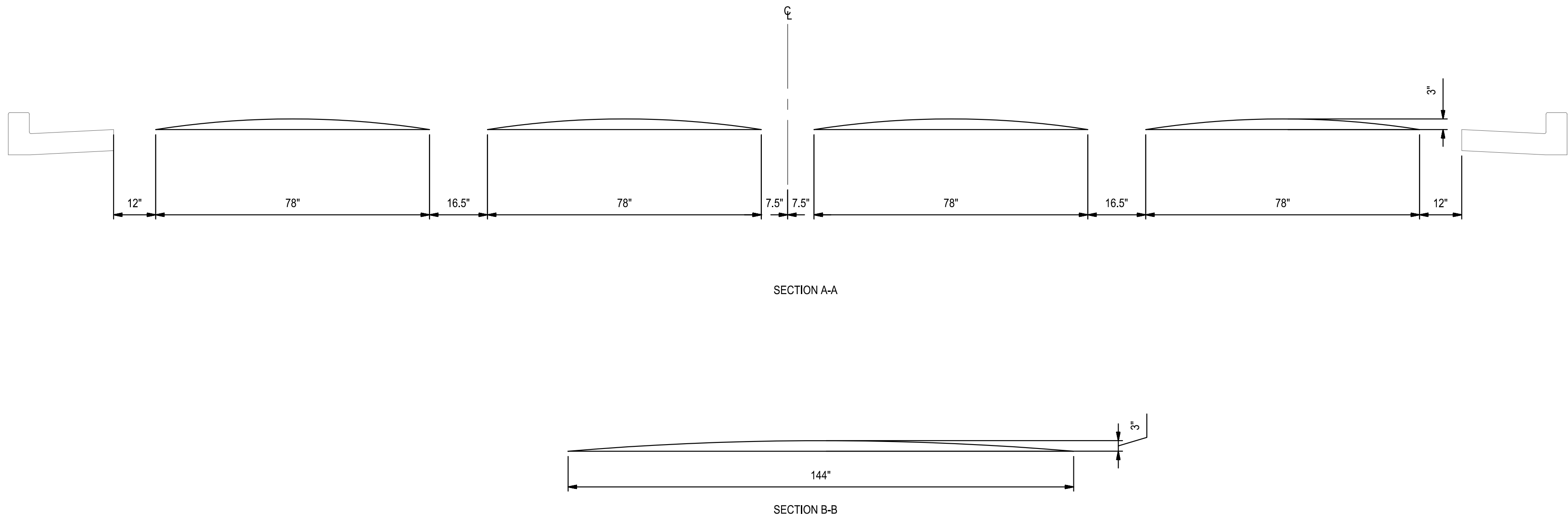
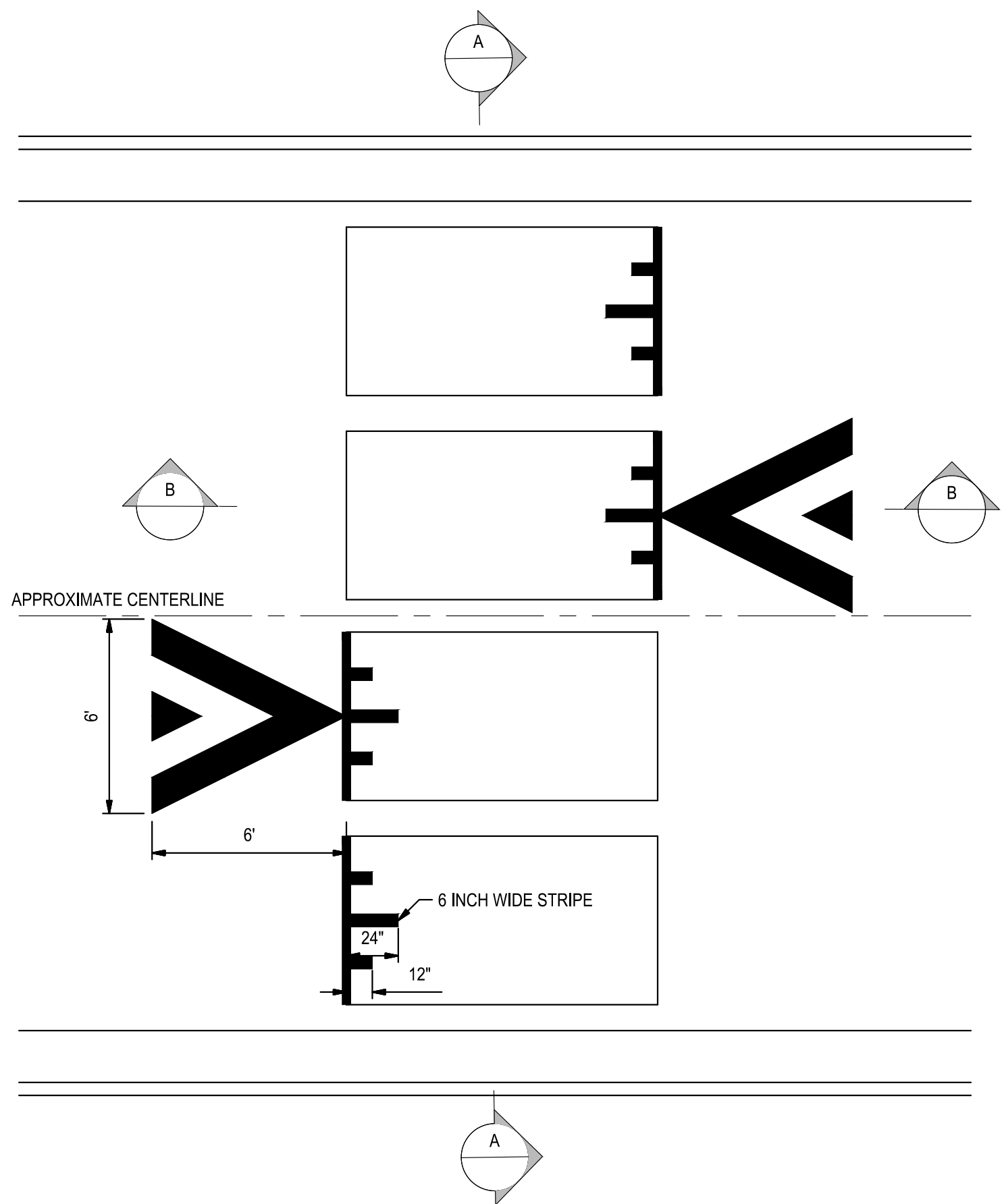

1 TYPICAL SPEED CUSHION DESIGN PLAN VIEW
NOT TO SCALE

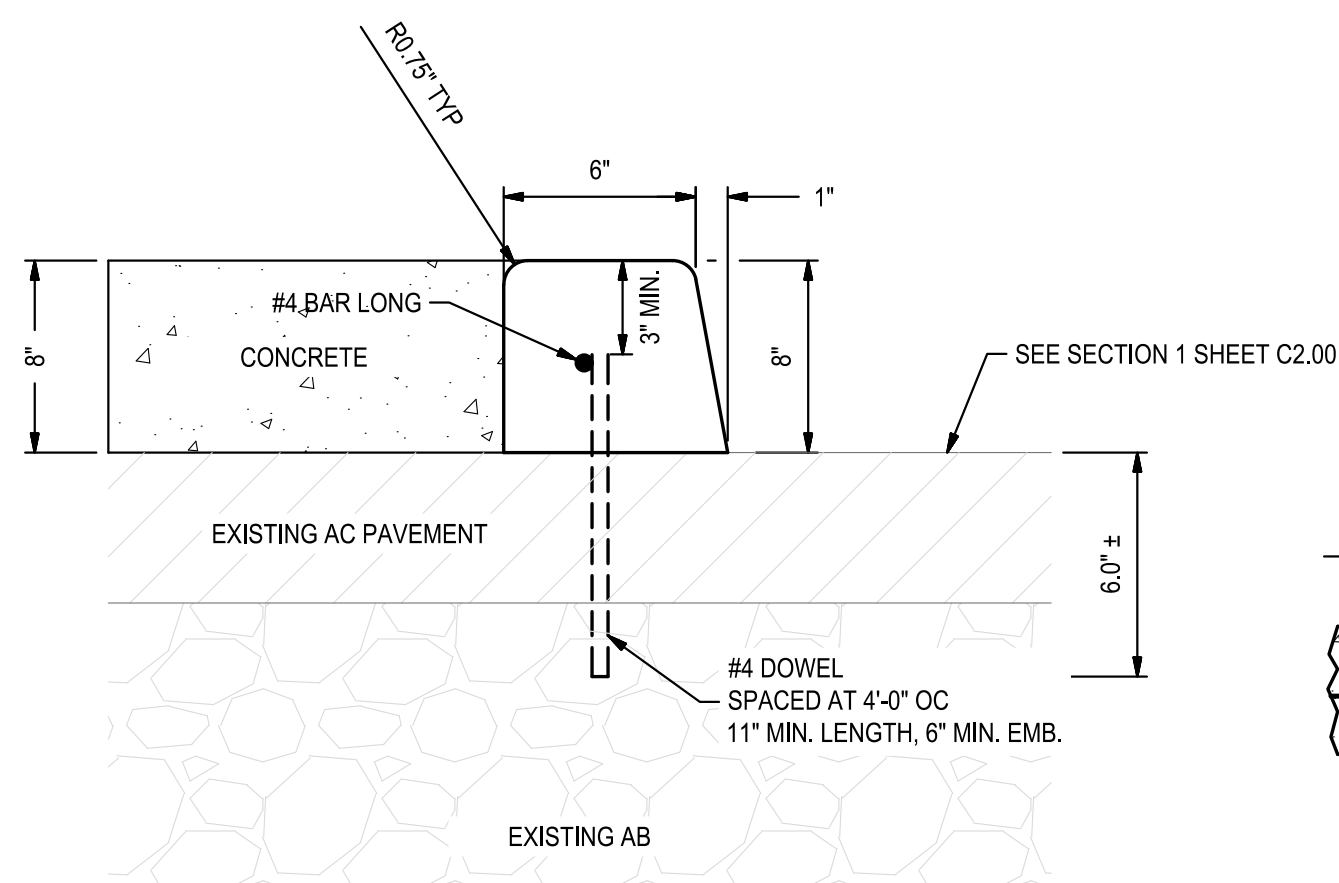

DOWEL SIZE & SPACING			
SLAB DEPTH	DIAMETER	LENGTH	SPACING
4", 5"	5/8"	12"	24" O.C.
6"	3/4"	18"	18" O.C.
8"	1"	24"	18" O.C.

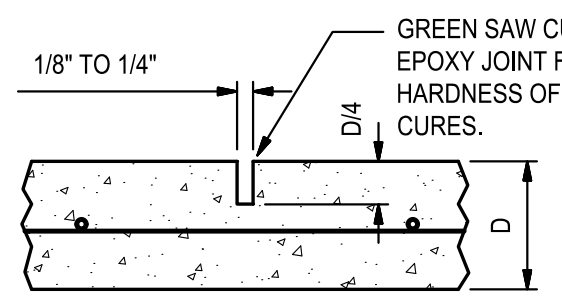
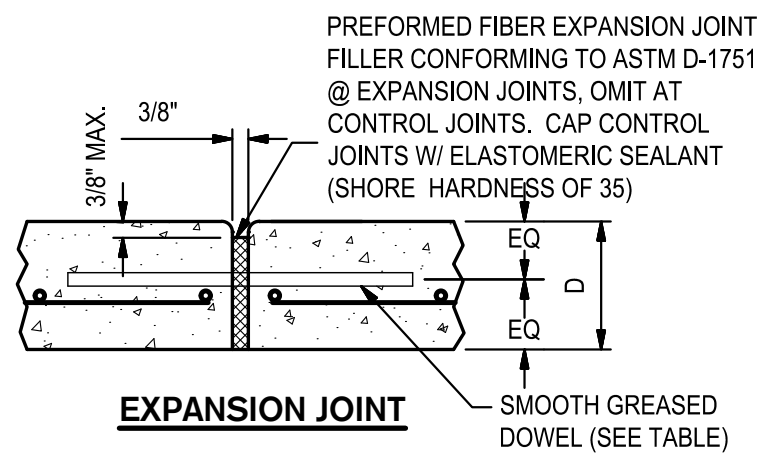

SLAB THICKNESS	WPJ SPACING (EACH WAY)	CONTROL JOINT SPACING	EXPANSION JOINT SPACING
4"	8' O.C. MAX.	32' O.C. MAX.	80' O.C. MAX.
5"	10' O.C. MAX.	32' O.C. MAX.	80' O.C. MAX.
6"	12' O.C. MAX.	36' O.C. MAX.	100' O.C. MAX.
8"	16' O.C. MAX.	40' O.C. MAX.	120' O.C. MAX.

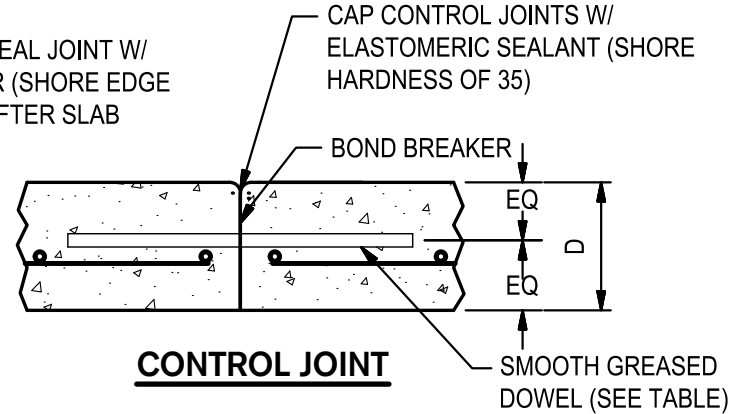

2 8" GLUE DOWN CURB DETAIL
NOT TO SCALE

3 TYPICAL CONCRETE JOINT DETAILS
NOT TO SCALE



525 San Anselmo Avenue, San Anselmo, CA 94960



DATE SIGNED: 05/06/20

ACCEPTED 05/06/20

Sean T. Condry
TOWN ENGINEER

TOWN OF SAN ANSELMO

BOLINAS AVENUE REHABILITATION PROJECT

DETAILS

C5.00

REVISIONS	NO.	DESCRIPTION	DATE	BY	DRAWING DATE: 10/07/19	SHEET: 11 OF 11
		DESIGNED: RAC				SCALE: AS SHOWN
		DRAWN: JKP				
		CHECKED: RAC				