

Path: X:\Engineering\CDI_Projects\895399_Ross_Drainage\Project\DWG\895399_CDI.dwg Layout Name: SH1-2

FOR REDUCED PLANS, THE ORIGINAL SCALE IS IN INCHES

ABBREVIATIONS:

AC ASPHALT CONCRETE	LT LEFT	WTR, W WATER
BC BEGIN CURVE	MUCS MARIN COUNTY UNIFORM CONSTRUCTION STANDARDS	< PT ANGLE POINT
BRC BEGIN REVERSE CURVE	PCC POINT OF COMPOUND CURVE	
BSW BACK OF SIDEWALK	PED PEDESTRIAN	
BVC BEGIN VERTICAL CURVE	PPB PEDESTRIAN PUSH BUTTON	
CB CATCH BASIN	PRC POINT OF REVERSE CURVE	
C&G CURB & GUTTER	PVI POINT OF VERTICAL INTERSECTION	
CI CAST IRON	PVC POLYVINYL CHLORIDE	
CL CENTERLINE	OH OVERHEAD UTILITY	
CLC CONTROL LINE COORDINATE	R.C. RELATIVE COMPACTION	
CMP CORRUGATED METAL PIPE	RCP REINFORCED CONCRETE PIPE	
CO CLEANOUT	R&R REMOVE & REPLACE	
CONC CONCRETE	RRFB RECTANGULAR FLASHING BEACON	
CR CURB RETURN	RT RIGHT	
DET DETECTOR	SD STORM DRAIN	
DI DROP INLET	SDMH STORM DRAIN MANHOLE	
DWY DRIVEWAY	SS SANITARY SEWER	
EBMUD EAST BAY MUNICIPAL UTILITY DISTRICT	SS LAT SANITARY SEWER LATERAL	
EC END CURVE	SSMH SANITARY SEWER MANHOLE	
ELEV ELEVATIONS	SSCO SANITARY SEWER CLEANOUT	
EP EDGE OF PAVEMENT	STL STEEL PIPE	
ERC END REVERSE CURVE	STD STANDARD	
EX,(E) EXISTING	SW SIDEWALK	
FC FACE OF CURB	TOB TOP OF BANK	
FG FINISHED GRADE	TC TOP OF CURB	
FL FLOW LINE	TEL TELEPHONE	
FLG FLOW LINE OF GUTTER	TG TOP OF GRATE	
FSW FRONT OF SIDEWALK	TS TRAFFIC SIGNAL	
G GAS	TYP TYPICAL	
GB GRADE BREAK	UG UNDERGROUND	
G SER GAS SERVICE	VL VAULT	
HDPE HIGH-DENSITY POLYETHYLENE	VAR VARIES	
IG INVERT GRADE	WM WATER MAIN	
INV INVERT GRADE	WS WATER SERVICE	
LF LINEAR FEET		
LG LIP OF GUTTER		

LEGEND

DESCRIPTION OF LINETYPE	PROPOSED	EXISTING
PROPERTY LINE	N/A	-----
EASEMENT	N/A	-----
FLOWLINE	N/A	-----
CENTERLINE/CONTROL LINE	N/A	-----
CHAIN LINK FENCE	N/A	○-○-○-○-○-○-○-○
WOOD FENCE	N/A	○-○-○-○-○-○-○-○
WIRE FENCE	N/A	-x-x-x-x-x-x-x-x-
WATER MAIN PIPE	N/A	-----6" W-----6" W-----
SANITARY SEWER PIPE	N/A	-----SS-----SS-----
STORM DRAIN PIPE	N/A	=====
GAS LINE	N/A	-----G-----G-----
TELEPHONE LINE/CONDUIT	N/A	-----T-----T-----
ELECTRICAL LINE/CONDUIT	N/A	-----E-----E-----
OVERHEAD UTILITY	N/A	-----OHU-----OHU-----

DESCRIPTION OF SYMBOL	PROPOSED	EXISTING
CONCRETE SURFACE		
AC PAVING		N/A
WATER MAIN GATE VALVE	N/A	○
WATER METER	N/A	⊞
FIRE HYDRANT	N/A	⊞
SANITARY SEWER MANHOLE	N/A	⊞
SANITARY SEWER CLEANOUT	N/A	⊞
STORM DRAIN MANHOLE	N/A	⊞
STORM DRAIN CURB INLET/CATCH BASIN	N/A	⊞
STORM DRAIN DROP INLET	N/A	⊞
ROADSIDE SIGN	N/A	⊞
STREET LIGHT	N/A	⊞
TREE AND DRIP LINE	N/A	⊞
SURVEY CONTROL POINT	N/A	⊞
JOINT UTILITY POLE	N/A	⊞
ADDRESS	N/A	⊞

DETAIL AND SECTION CALLOUTS

DETAILS:

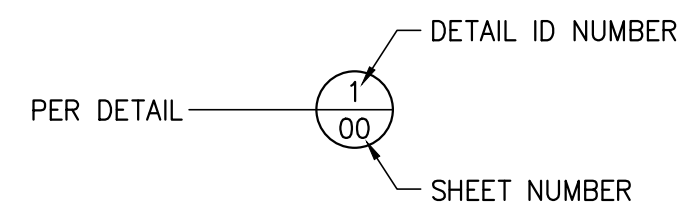

GENERAL NOTES

- EXCAVATIONS OVER FIVE FEET (5') DEEP REQUIRE AN EXCAVATION PERMIT FROM THE STATE DEPARTMENT OF INDUSTRIAL SAFETY.
- CONTRACTOR SHALL CALL "USA NORTH" AT 811 OR (800) 642-2444 AT LEAST ONE (1) WEEK PRIOR TO START OF CONSTRUCTION FOR LOCATING UNDERGROUND UTILITIES.
- CONSTRUCTION CONTRACTOR AGREES THAT IN ACCORDANCE WITH GENERALLY ACCEPTED CONSTRUCTION PRACTICES, CONSTRUCTION CONTRACTOR WILL BE REQUIRED TO ASSUME SOLE AND COMPLETE RESPONSIBILITY FOR JOB SITE CONDITIONS DURING THE COURSE OF CONSTRUCTION OF THE PROJECT, INCLUDING SAFETY OF ALL PERSONS AND PROPERTY; THAT THIS REQUIREMENT SHALL BE MADE TO APPLY CONTINUOUSLY AND NOT BE LIMITED TO NORMAL WORKING HOURS, AND CONSTRUCTION CONTRACTOR FURTHER AGREES TO DEFEND, INDEMNIFY AND HOLD DESIGN PROFESSIONAL HARMLESS FROM ANY AND ALL LIABILITY, REAL OR ALLEGED, IN CONNECTION WITH THE PERFORMANCE OF WORK ON THIS PROJECT, EXCEPTING LIABILITY ARISING FROM THE SOLE NEGLIGENCE OF THE DESIGN PROFESSIONAL.
- UNAUTHORIZED CHANGES & USES: THE ENGINEER PREPARING THESE PLANS WILL NOT BE RESPONSIBLE FOR, OR LIABLE FOR, UNAUTHORIZED CHANGES TO OR USES OF THESE PLANS. ALL CHANGES TO THE PLANS MUST BE IN WRITING AND MUST BE APPROVED BY THE PREPARER OF THESE PLANS.
- NOTICE TO CONTRACTORS: THE EXISTENCE AND LOCATION OF ANY UNDERGROUND UTILITY LINES OR STRUCTURES SHOWN ON THESE PLANS WERE OBTAINED BY A SEARCH OF AVAILABLE RECORDS. THE CONTRACTOR IS REQUIRED TO TAKE DUE PRECAUTIONARY MEASURES TO PROTECT THE UTILITY LINES SHOWN AND ANY OTHER LINES NOT OF RECORD OR NOT SHOWN ON THESE PLANS. NOT ALL OVERHEAD UTILITIES ARE NOT SHOWN ON THE PLANS, AS A PART OF THEIR PRE-BID INSPECTION, BIDDERS SHALL NOTE THE TYPE AND LOCATION OF OVERHEAD UTILITIES IN THE WORK AREA AND SHALL INCLUDE PROVISIONS FOR WORKING IN THOSE AREAS. NO ADDITIONAL COMPENSATION WILL BE ALLOWED.
- THE CONTRACTOR SHALL BE RESPONSIBLE FOR ANY DAMAGES TO CITY OR PRIVATE PROPERTY OR OTHER UTILITIES CAUSED BY THEIR OPERATIONS. ALL IRRIGATION LINES AND COMPONENTS DISTURBED BY CONSTRUCTION SHALL BE REPAIRED AND RESTORED TO WORKING CONDITION. ANY DAMAGED LAWN OR LANDSCAPING OUTSIDE OF THE WORK LIMITS SHALL BE REPLACED.
- THE CONTRACTOR SHALL MAINTAIN REASONABLE ACCESS TO THE SITE AND MINIMIZE CLOSURE TIME OF DRIVEWAYS DURING CONSTRUCTION. MAIL SERVICE SHALL BE MAINTAINED THROUGHOUT THE COURSE OF THIS PROJECT. THE U.S. POSTAL SERVICE SHALL HAVE UNINTERRUPTED ACCESS TO MAILBOXES AT ALL TIMES.
- THE CONTRACTOR SHALL BE RESPONSIBLE FOR OFF-SITE DISPOSAL OF ALL PAVEMENT, CONCRETE AND REINFORCEMENT, AND SPOILS NOT NEEDED FOR BACKFILL AS REQUIRED BY THE ENGINEER AND PER THE SPECIFICATIONS.
- ALL EXCAVATIONS OR TRENCHES IN PAVED AREAS SHALL REQUIRE SAW CUTTING IN A NEAT AND UNIFORM MANNER.
- PRIOR TO THE START OF CONSTRUCTION THE CONTRACTOR SHALL PROVIDE THE TOWN OF ROSS PUBLIC WORKS DEPARTMENT A TRAFFIC CONTROL PLAN IN ACCORDANCE WITH THE PROJECT SPECIFICATIONS.
- ALL CONSTRUCTION SHOWN ON THESE PLANS SHALL CONFORM TO THE GENERAL PROVISIONS, SPECIAL PROVISIONS, AND TECHNICAL SPECIFICATIONS IN THE CONTRACT DOCUMENTS BOOKLET. IN THE EVENT OF CONFLICT THE GENERAL PROVISIONS, SPECIAL PROVISIONS, AND TECHNICAL SPECIFICATIONS SHALL TAKE PRECEDENCE.

CONSTRUCTION NOTE DESIGNATIONS

- (R1) = ROADWAY AND RELATED ITEMS CONSTRUCTION NOTES.
- (D1) = DRAINAGE AND RELATED ITEMS CONSTRUCTION NOTES.

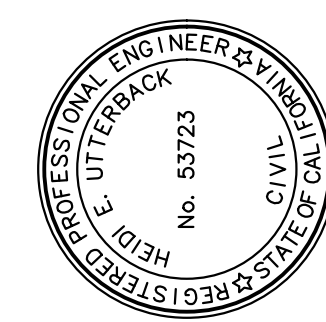

PREPARED UNDER THE DIRECTION OF
 HEIDI E. UTTERBACK
 3/19/2026
 DATE
 DESIGNED BY A.M.
 DRAWN BY A.M.
 REVIEWED BY HEU



TOWN OF ROSS
 DRAINAGE IMPROVEMENTS
 CALIFORNIA
**LEGEND, ABBREVIATIONS,
 AND GENERAL NOTES**

PROJECT NUMBER
 9007-65
 DRAWING DATE
 MARCH 2026
 SHEET NUMBER
2 OF **11**

FOR REDUCED PLANS, THE ORIGINAL SCALE IS IN INCHES

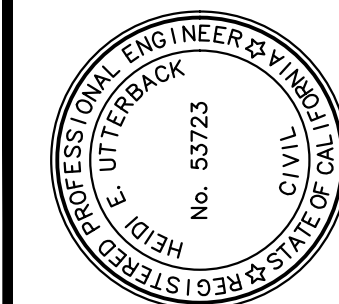
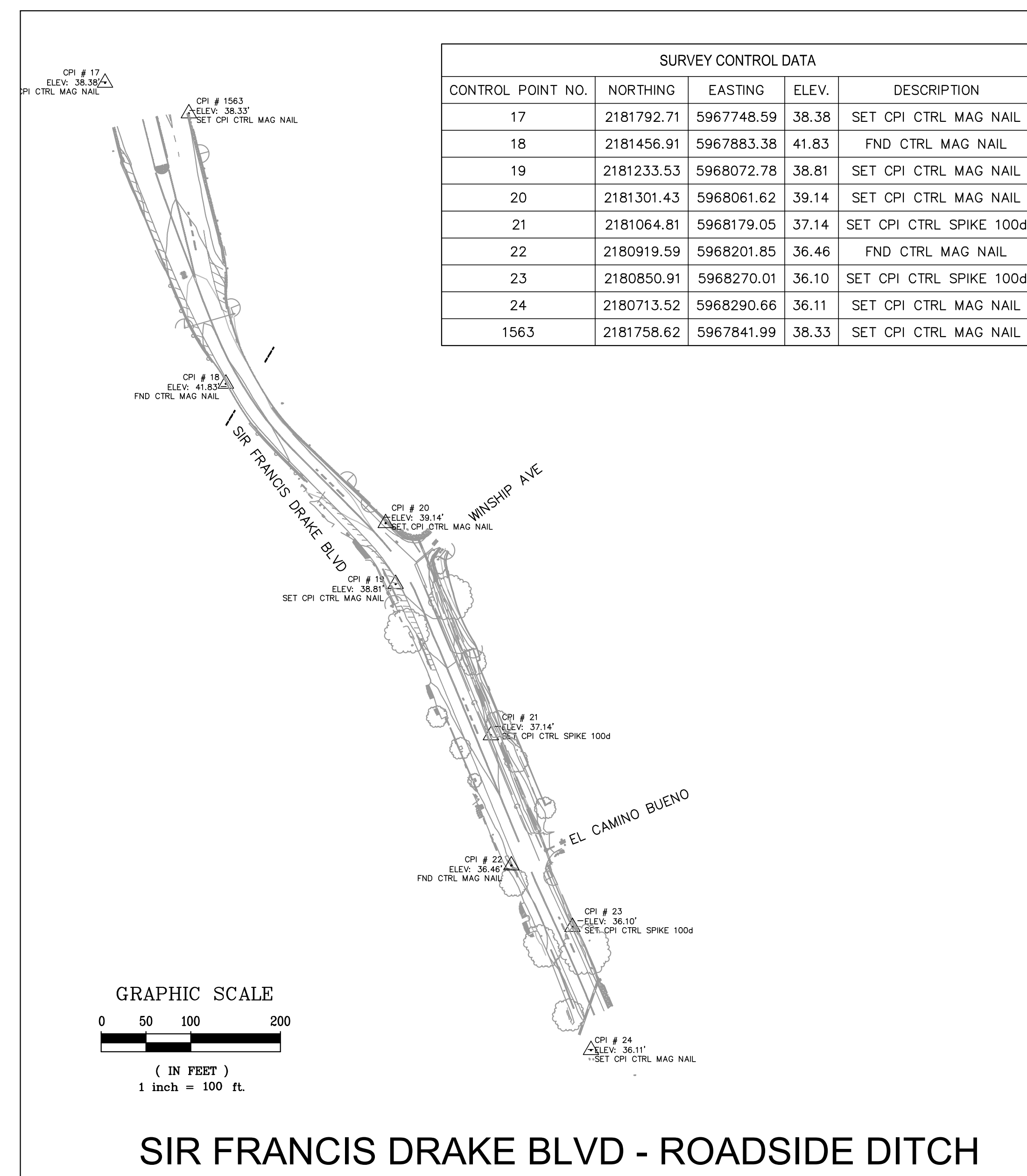
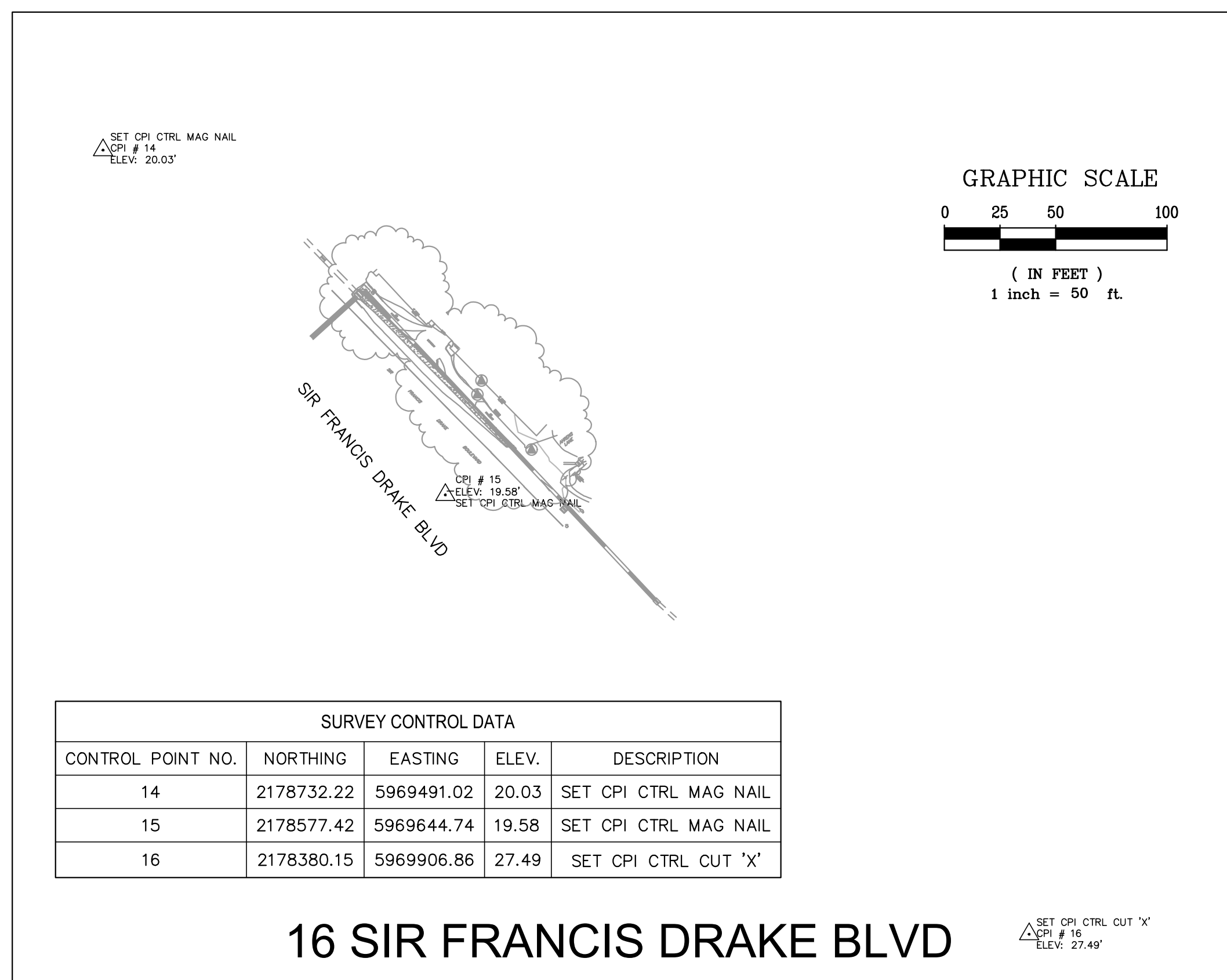
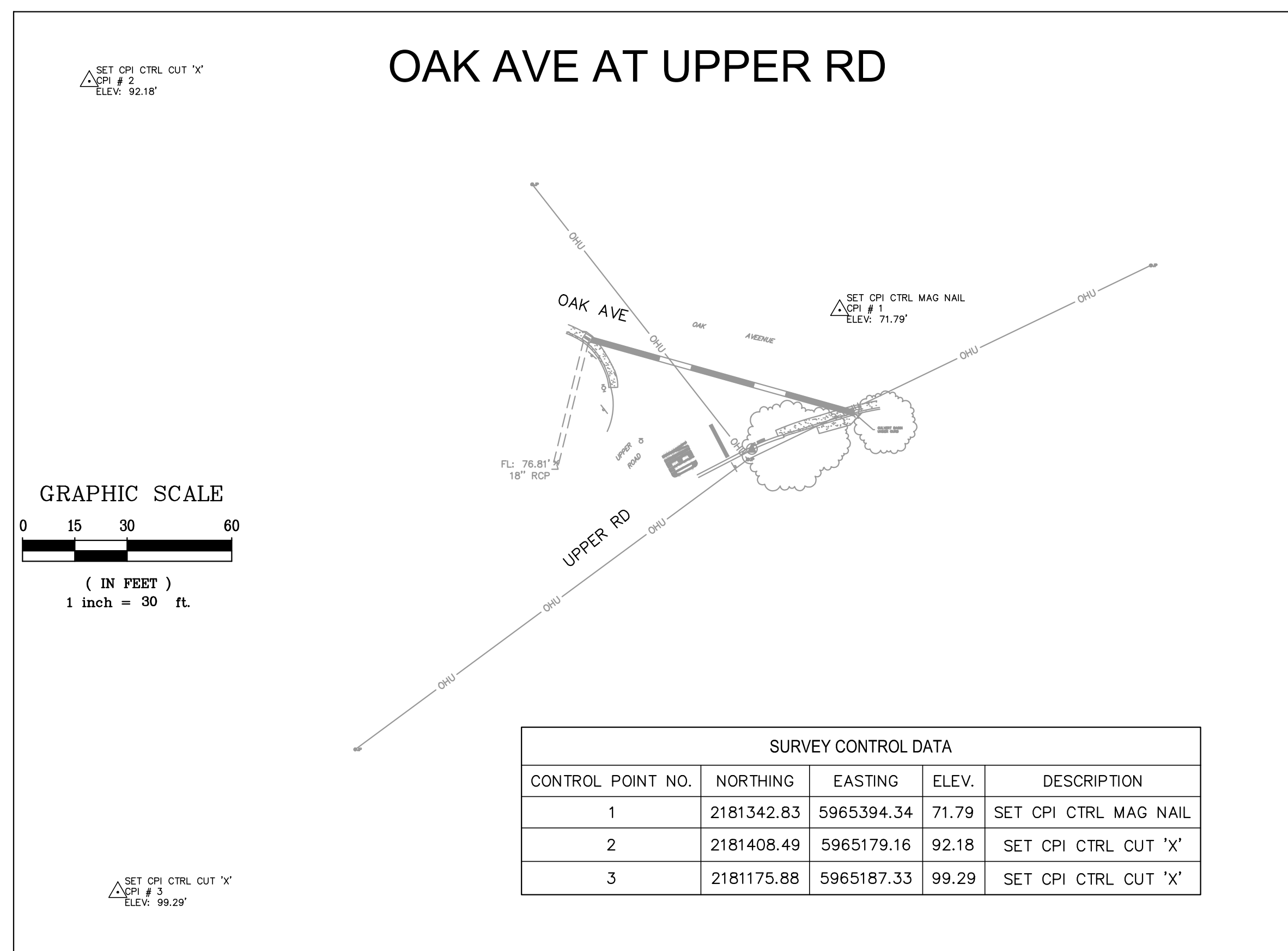

PREPARED UNDER THE DIRECTION OF
 HEIDI E. UTTERBACK, P.E. 53723
 DATE: 3/19/2026
 DRAWN BY: AJM
 REVIEWED BY: HEU

DCCM
 DCCM Infrastructure, Inc.
 1400 Neolomas Ave, Santa Rosa, CA 95405
 707.571.8005 | DCCM.com

CALIFORNIA
 DRAINAGE IMPROVEMENTS
 SURVEY CONTROL
 TOWN OF ROSS

PROJECT NUMBER
9007-65
 DRAWING DATE
MARCH 2026
 SHEET NUMBER
3 OF 11



ORIGINAL PLOT DATE:

FOR REDUCED PLANS, THE 0 ORIGINAL SCALE IS IN INCHES

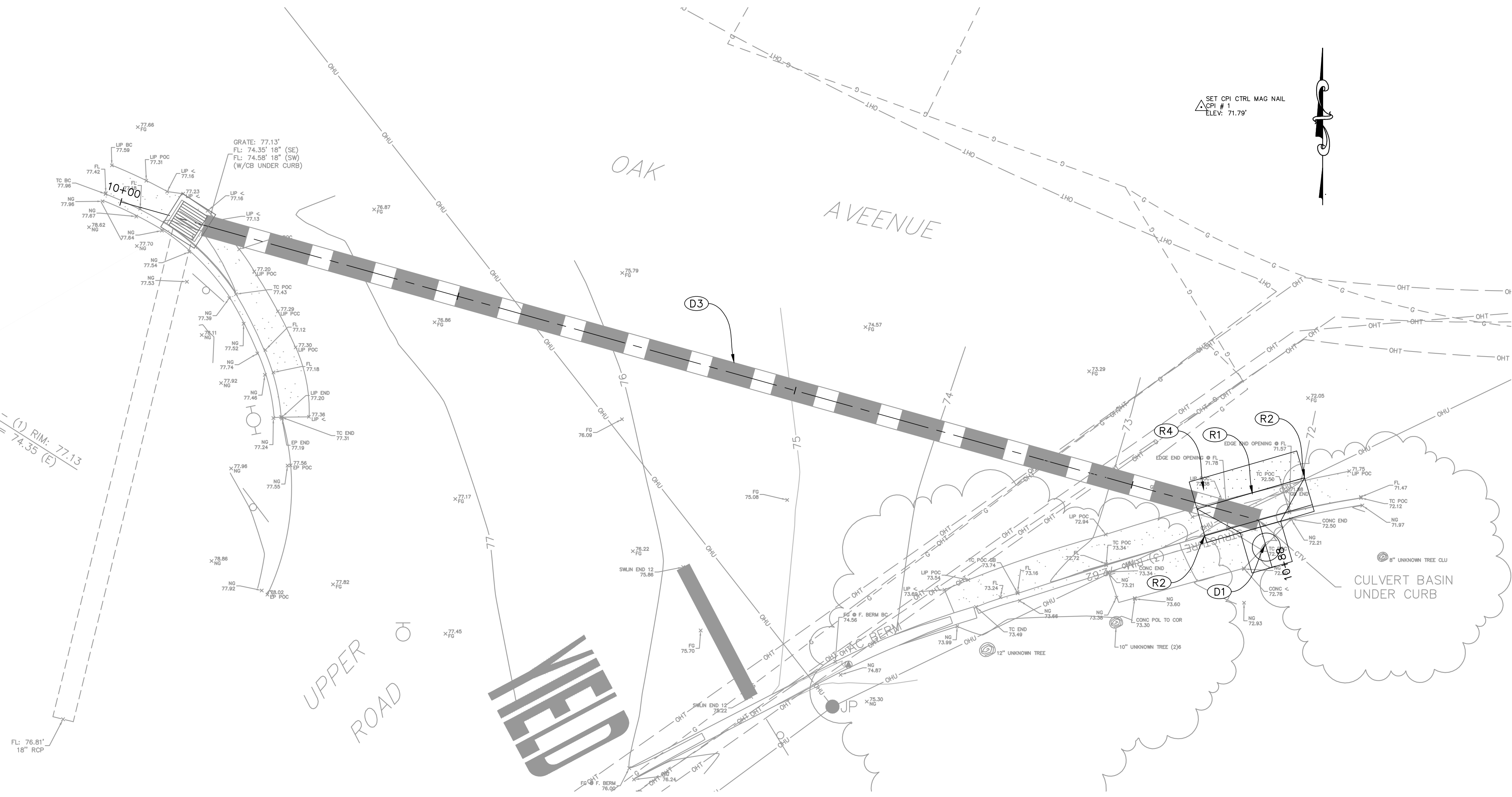

CONSTRUCTION NOTES

- (D1) INSTALL TYPE A CATCH BASIN PER MUCS DWG 225. CONTRACTOR TO FIELD VERIFY EXISTING 18" INVERT PRIOR TO CONSTRUCTION.
- (D3) EXISTING 18" RCP SHALL BE CLEANED/VACUATED AND DEBRIS DISPOSED PRIOR TO CATCH BASIN INSTALLATION SEE SPECIFICATIONS.
- (R1) REMOVE AND REPLACE CURB AND GUTTER AS REQUIRED. CURB AND GUTTER TO BE PER MUCS STD 105, TYPE "A" CURB
- (R2) SAWCUT AND CONFORM TO EXISTING CURB AND GUTTER PER DETAIL
- (R4) INSTALL AC CONFORM PER 1/10

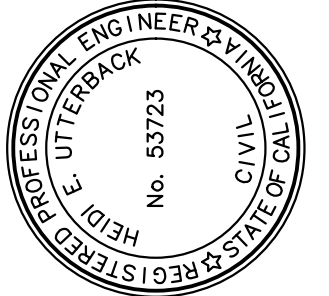

PREPARED UNDER THE DIRECTION OF
 HEIDI E. UTTERBACK
 HEIDI E. UTTERBACK, PCE 53723
 DESIGNED BY AJM
 DRAWN BY AJM
 REVIEWED BY HEU

DCCM
 DCCM Infrastructure, Inc.
 1400 Neolomas Ave, Santa Rosa, CA 95405
 707.571.8005 | DCCM.com

TOWN OF ROSS
 CALIFORNIA
DRAINAGE IMPROVEMENTS
CULVERT AT OAK & UPPER ROAD

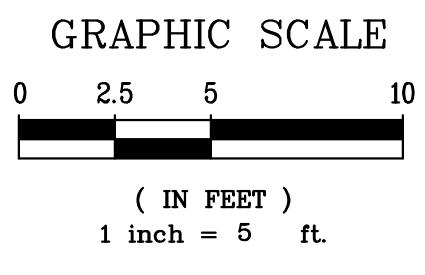
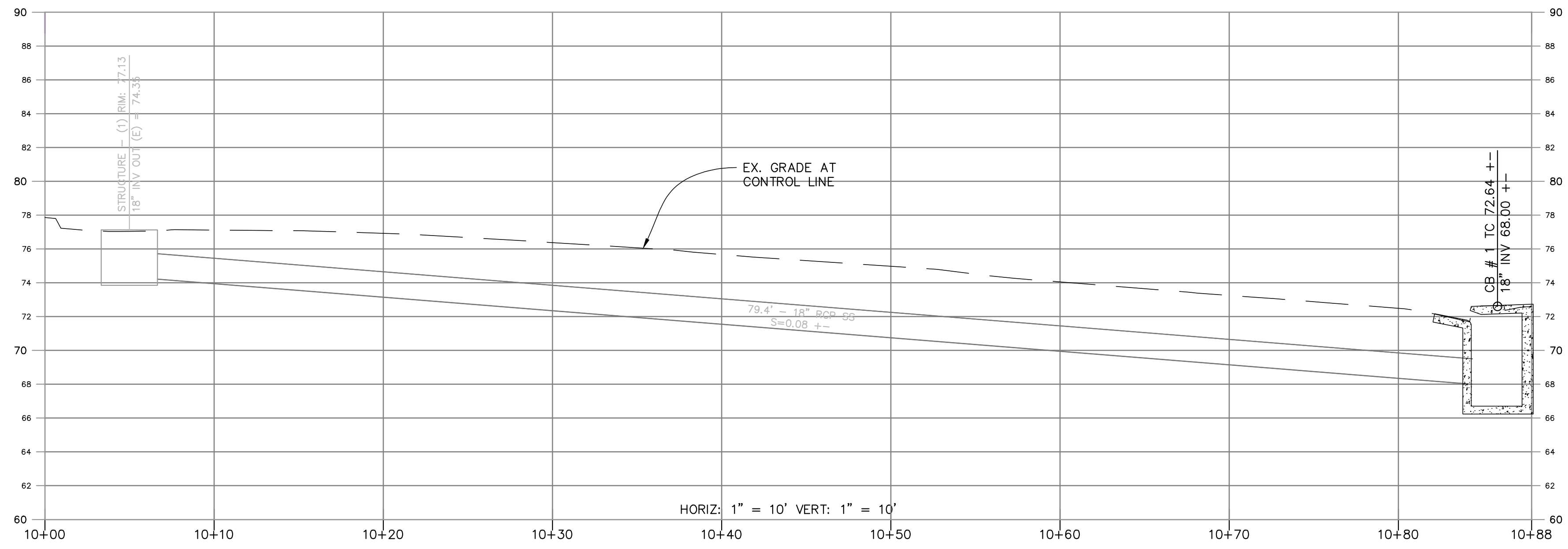

PROJECT NUMBER
9007-65
 DRAWING DATE
MARCH 2026
 SHEET NUMBER
4 OF **11**

FOR REDUCED PLANS, THE ORIGINAL SCALE IS IN INCHES

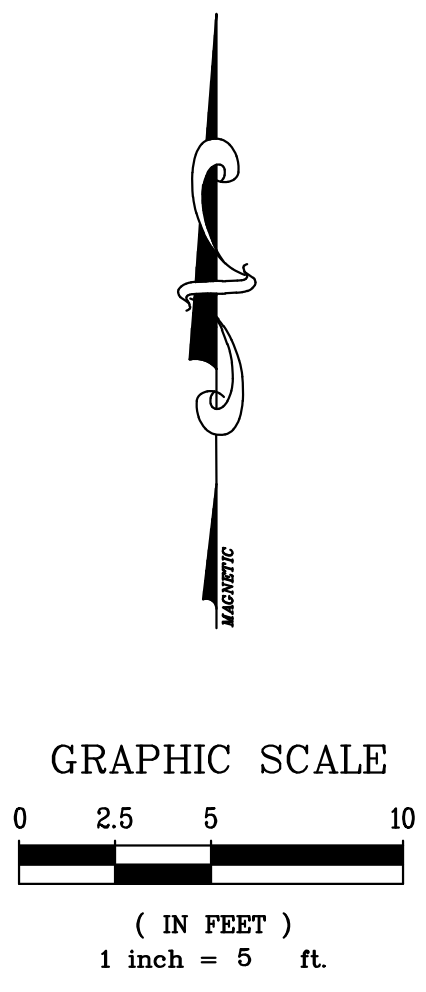
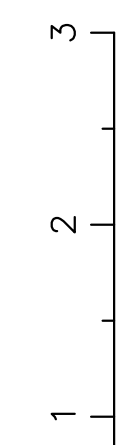

CONSTRUCTION NOTES

- ①04 REMOVE EXISTING 12" X 12" DRAINAGE INLET AND REPLACE WITH NEW 24" X 24" GRATED DROP INLET PER MUCS STD 265. MATCH EXISTING GRATE AND INVERT ELEVATIONS AND RECONNECT EXISTING 6" PVC. APPROXIMATE EXISTING DEPTH FROM GRATE TO 6" PVC INVERT IS 24". CONTRACTOR TO VERIFY EXISTING INVERT PRIOR TO CONSTRUCTION.
- ①05 EXISTING STORM DRAIN PIPES TO REMAIN. CONTRACTOR TO PROTECT IN PLACE.
- ①10 PROVIDE 3'+ VALLEY GUTTER TRANSITION TO NEW DRAINAGE INLET. CONTRACTOR TO COORDINATE NEW INLET LOCATION AND VALLEY GUTTER TRANSITION WITH THE TOWN ENGINEER.
- ①11 EXISTING CONCRETE VALLEY GUTTER DAMAGED OR REMOVED FOR INLET CONSTRUCTION SHALL BE REPLACED IN KIND

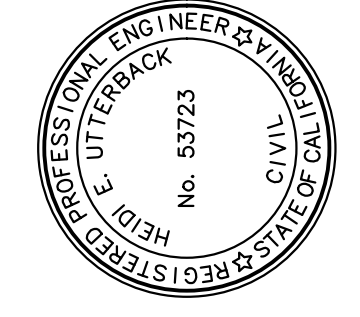

PREPARED UNDER THE DIRECTION OF
 Heidi E. Utterback
 HEIDI E. UTTERBACK, PCE 53723
 DESIGNED BY AJM
 DRAWN BY AJM
 REVIEWED BY HEU
 DATE 3/19/2026



TOWN OF ROSS
 CALIFORNIA
 DRAINAGE IMPROVEMENTS
**BERRY LN AT SIR FRANCIS DRAKE
 DRAINAGE IMPROVEMENTS**

PROJECT NUMBER
 9007-65

DRAWING DATE
 MARCH 2026

SHEET NUMBER
6 OF 11

ORIGINAL PLOT DATE:

FOR REDUCED PLANS, THE ORIGINAL SCALE IS IN INCHES

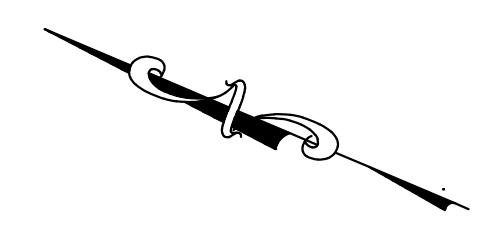
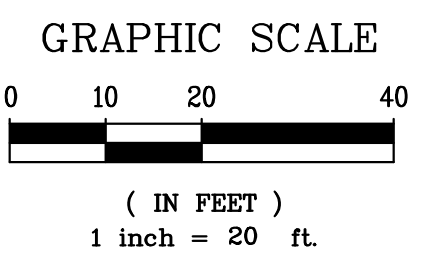

CONSTRUCTION NOTES

- (D5) EXISTING STORM DRAIN PIPES TO REMAIN. CONTRACTOR TO PROTECT IN PLACE.
- (D6) REGRADE DITCH PER FLOWLINE PROFILE AND CROSS SECTIONS. SEE DETAIL.
- (D7) REGRADE FLOWLINE AS SHOWN
- (D8) PLACE 12" THICK ROCK SLOPE PROTECTION (NO. 1 METHOD B) OVER RSP FABRIC CLASS 8
- (D9) PROTECT ABOVE GROUND CONDUIT/ CABLE IN PLACE.

2/10

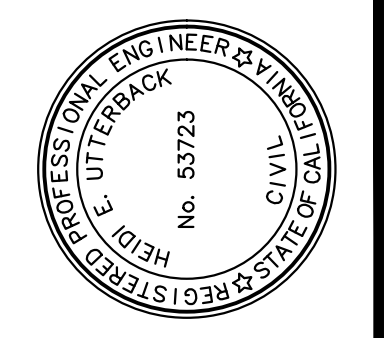
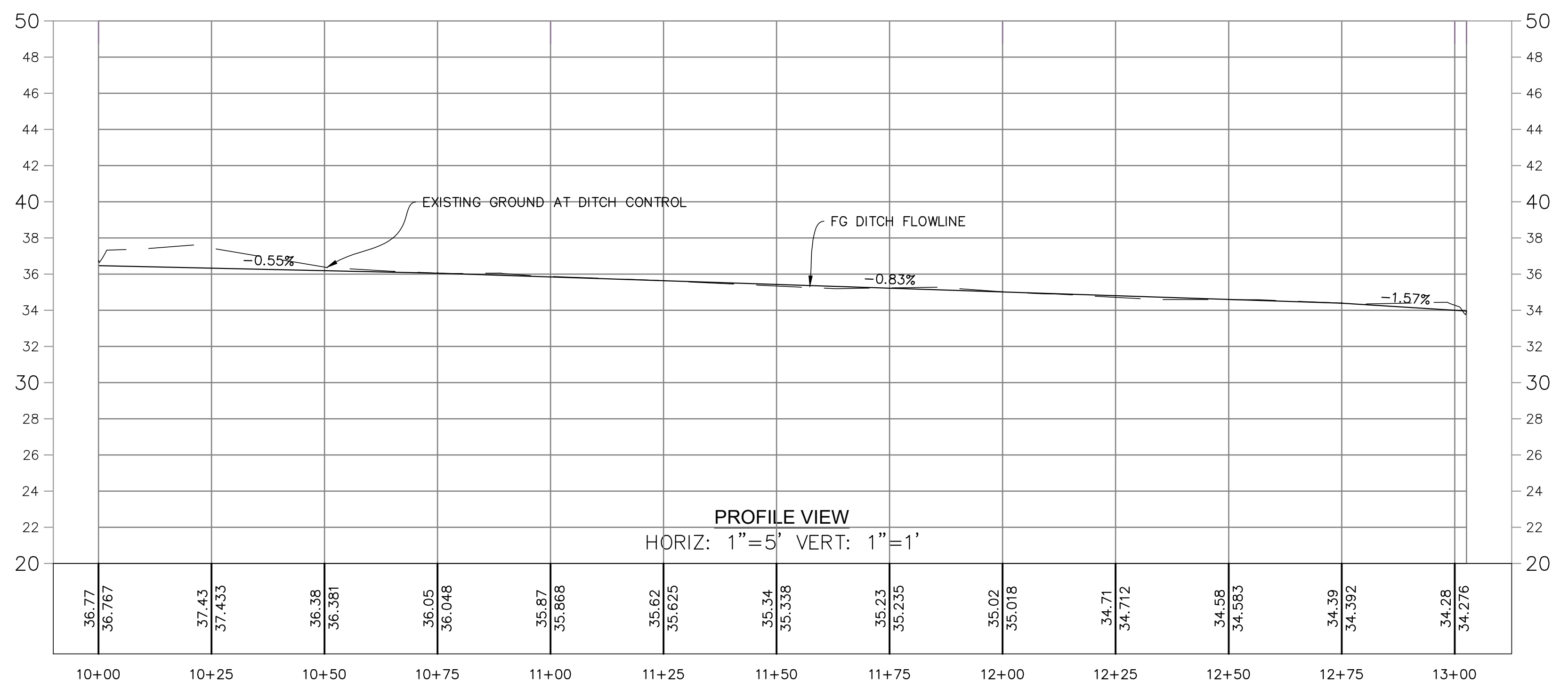
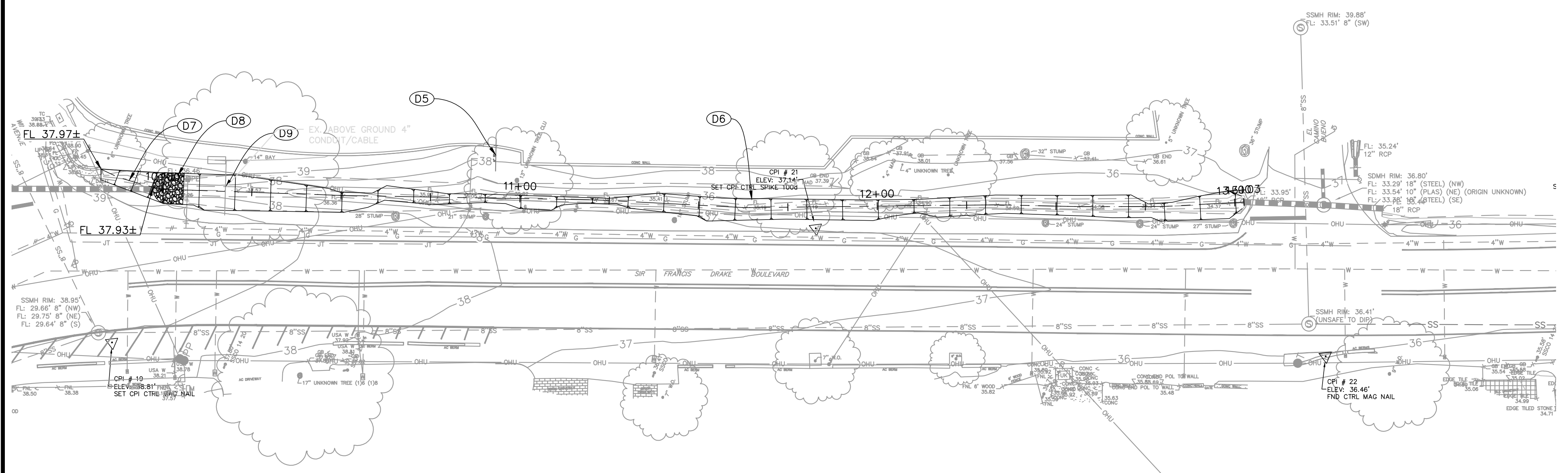

PREPARED UNDER THE DIRECTION OF
 Heidi E. Utterback
 HEIDI E. UTTERBACK, RCE 53723
 DESIGNED BY A.M.
 DRAWN BY A.M.
 REVIEWED BY HEU

DCCM
 DCCM Infrastructure, Inc.
 1400 Neolomas Ave. Santa Rosa, CA 95405
 707.571.8005 | DCCM.com

TOWN OF ROSS
 CALIFORNIA
 DRAINAGE IMPROVEMENTS
 ROADSIDE DITCH

PROJECT NUMBER
9007-65

DRAWING DATE
MARCH 2026

SHEET NUMBER
7 OF 11

ORIGINAL PLOT DATE:

FOR REDUCED PLANS, THE ORIGINAL SCALE IS IN INCHES

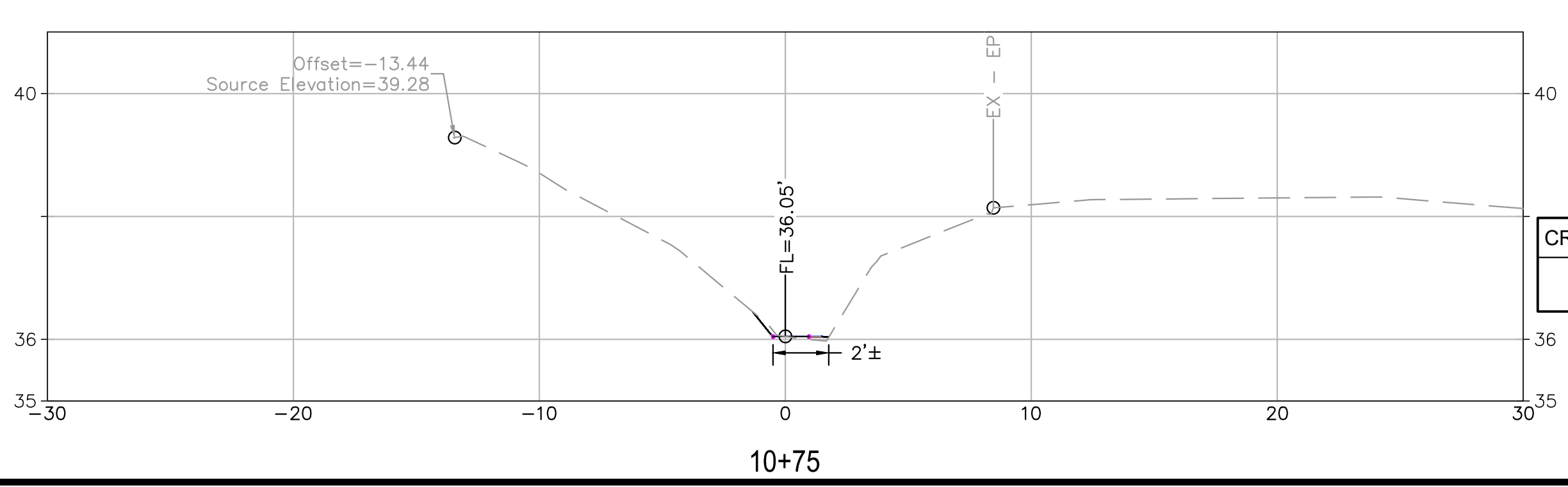
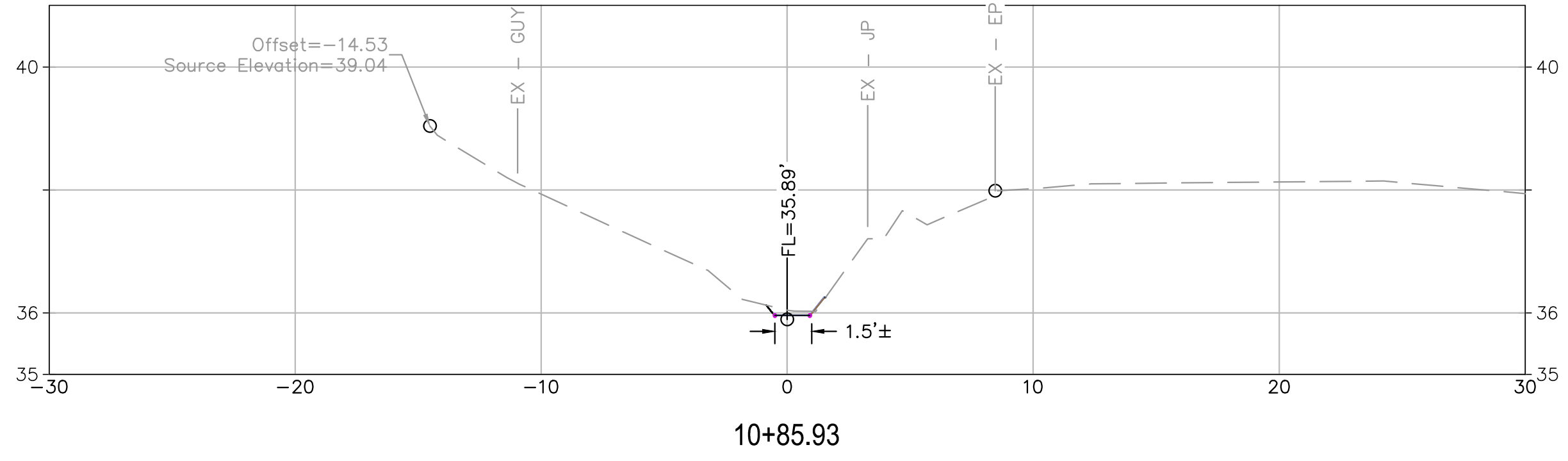
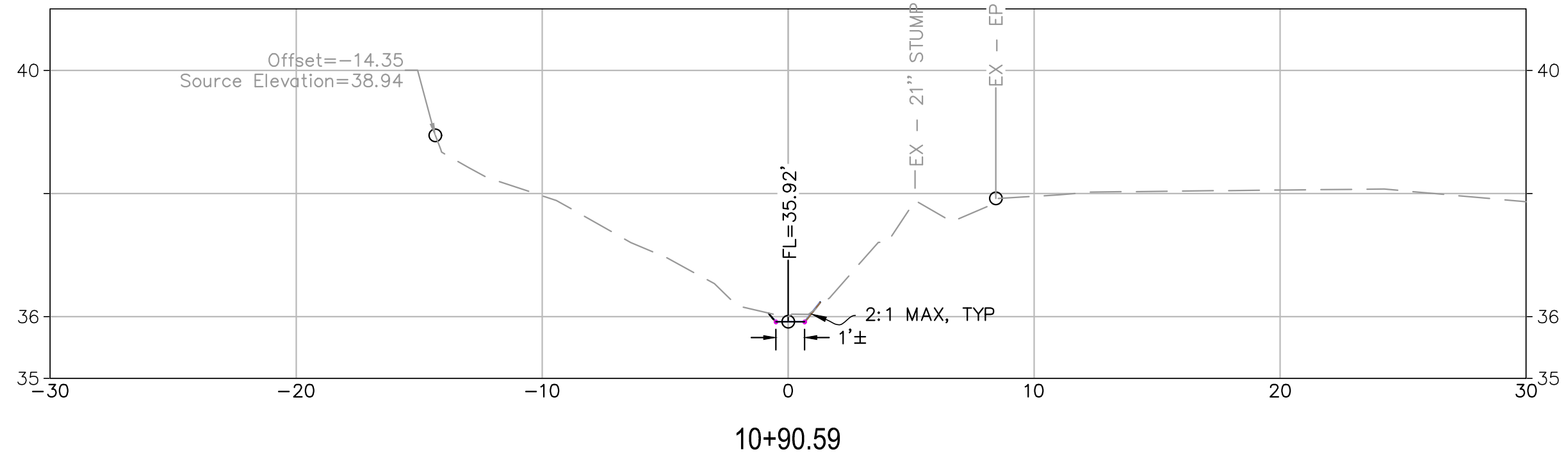
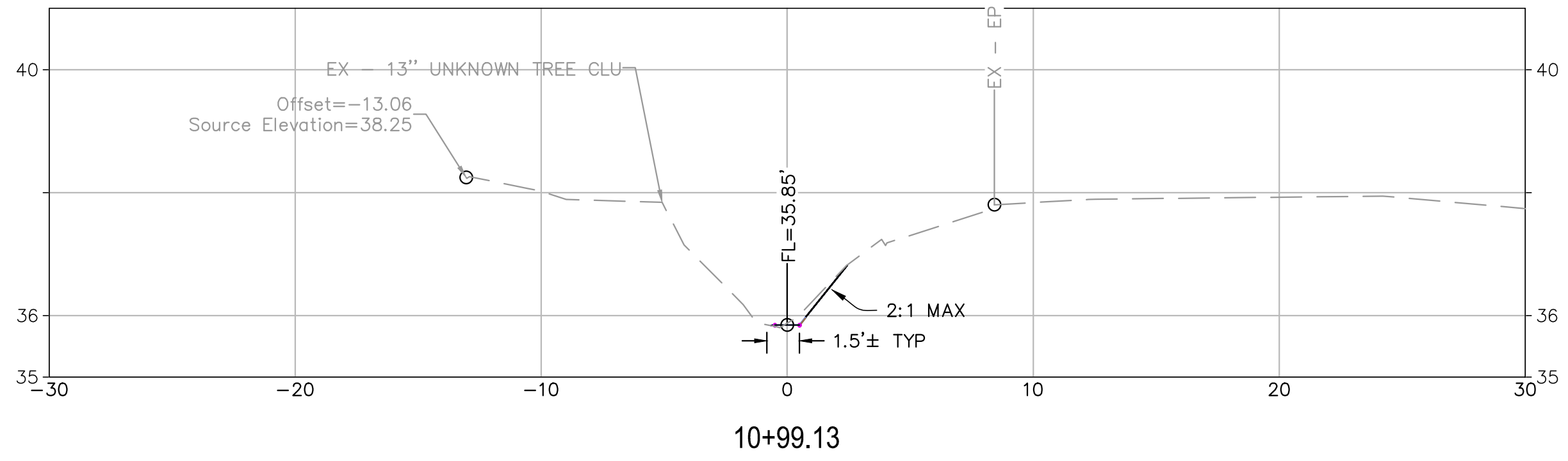
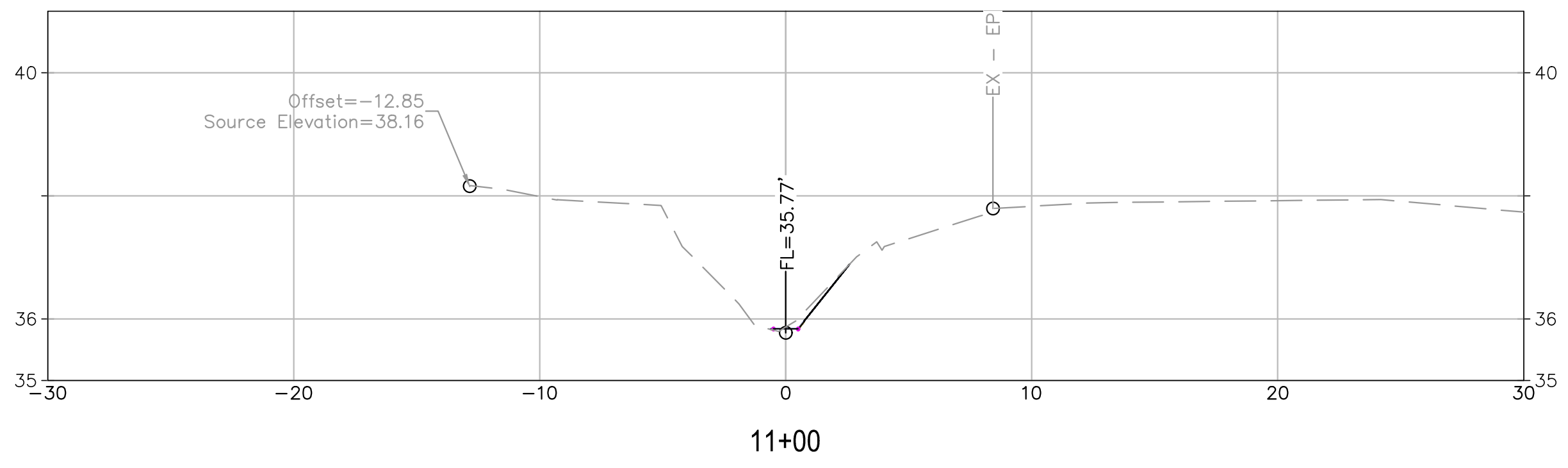
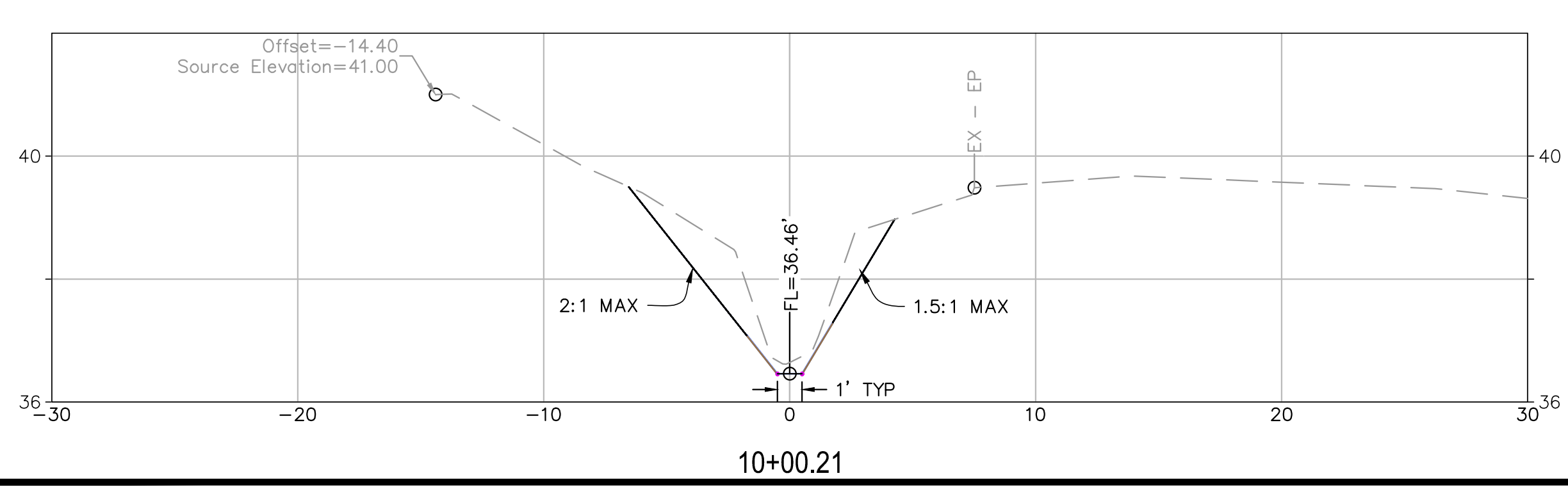
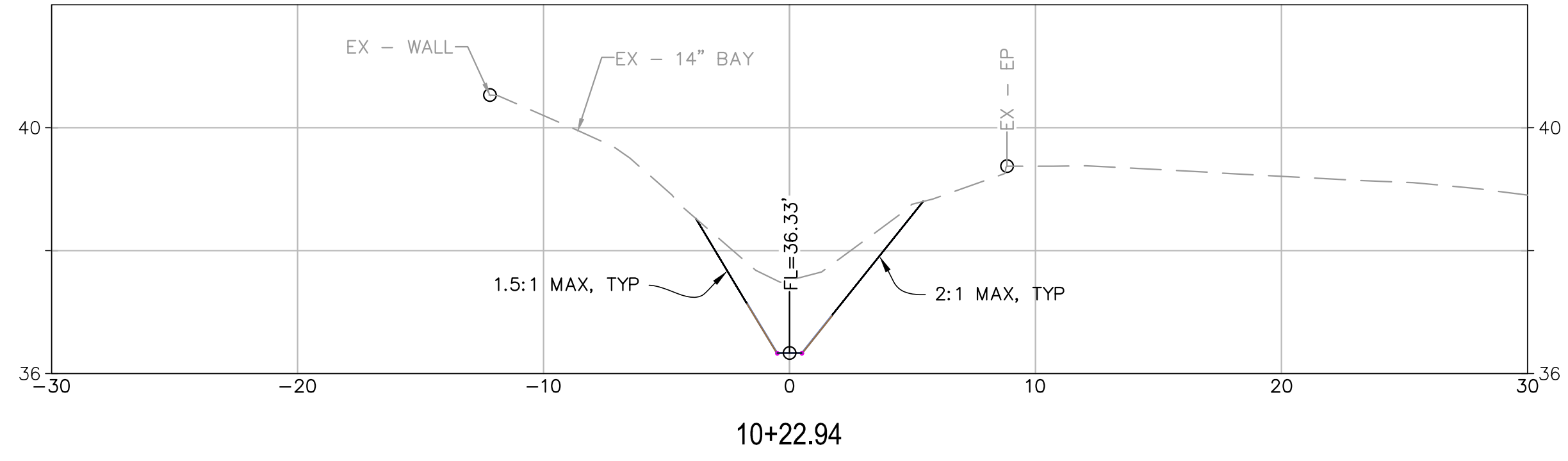
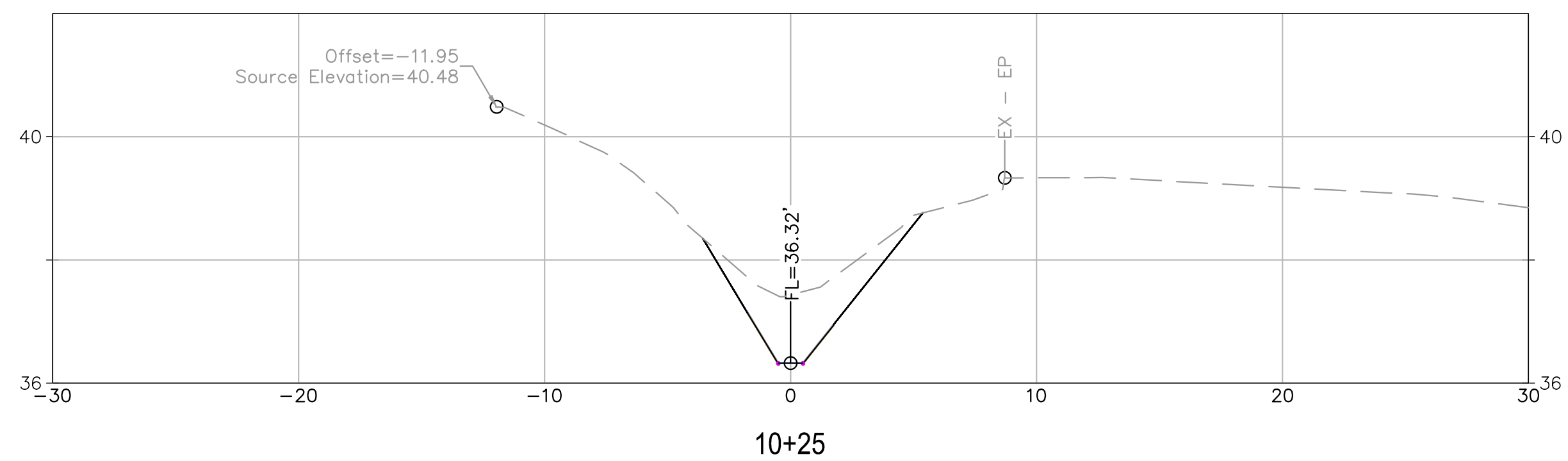
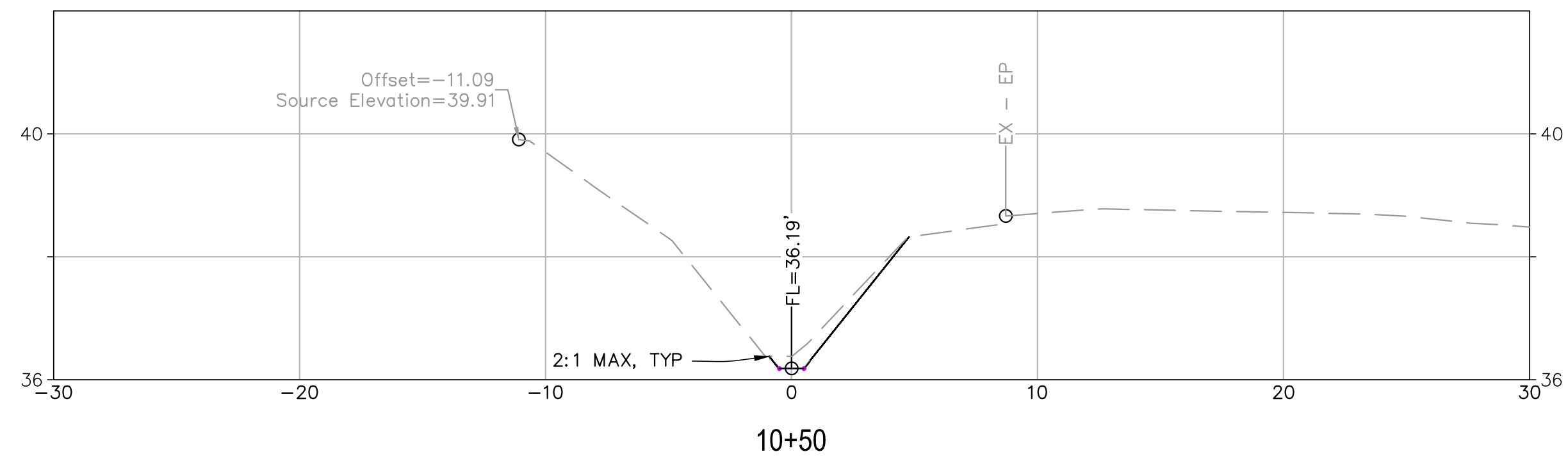
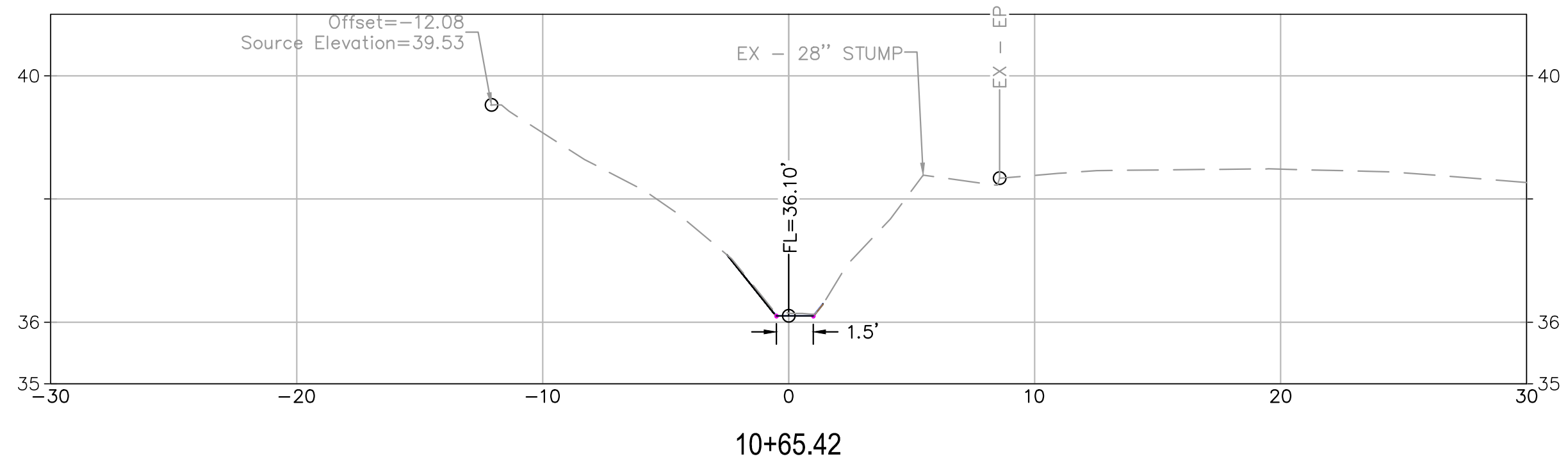

CROSS SECTION SCALES
HORIZ.: 1" = 5'
VERT.: 1" = 2'

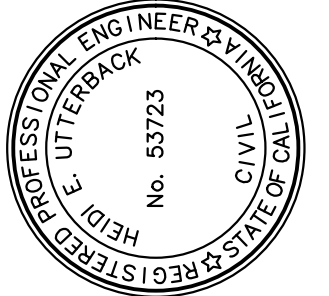

PREPARED UNDER THE DIRECTION OF
HEIDI E. UTTERBACK
DESIGNED BY
DRAWN BY
REVIEWED BY
DATE
3/19/2026

DCCM
DCCM Infrastructure, Inc.
1400 Neolomas Ave, Santa Rosa, CA 95405
707.571.8005 | DCCM.com

TOWN OF ROSS
CALIFORNIA
DRAINAGE IMPROVEMENTS
ROADSIDE DITCH SECTIONS 1

PROJECT NUMBER
9007-65
DRAWING DATE
MARCH 2026
SHEET NUMBER
8 OF 11

ORIGINAL PLOT DATE:

FOR REDUCED PLANS, THE 0 ORIGINAL SCALE IS IN INCHES

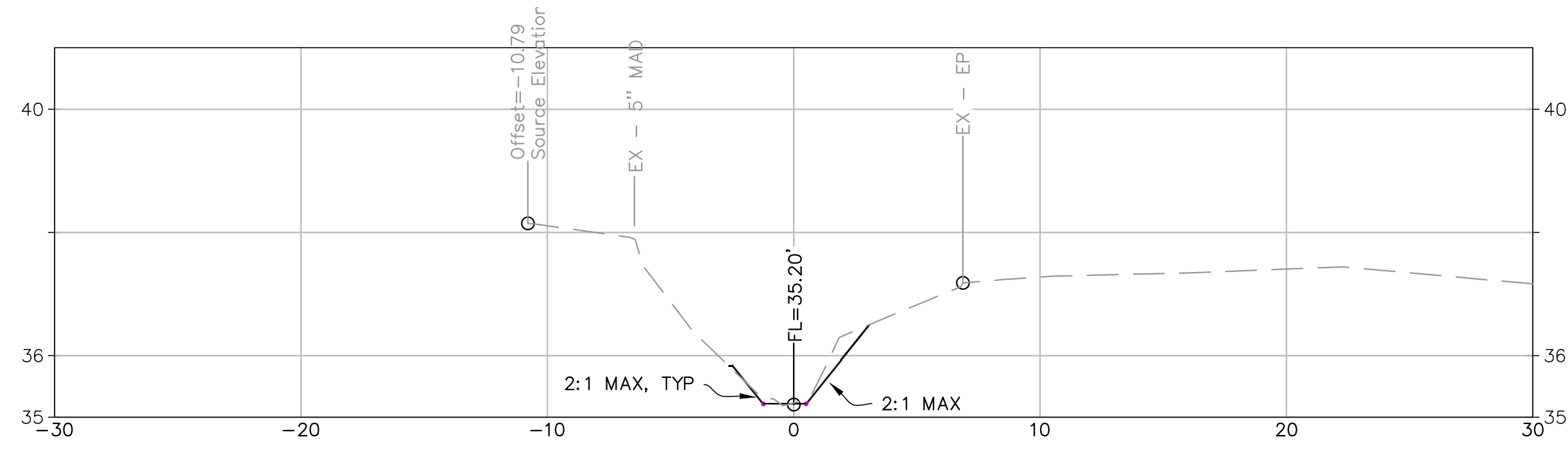

11+75

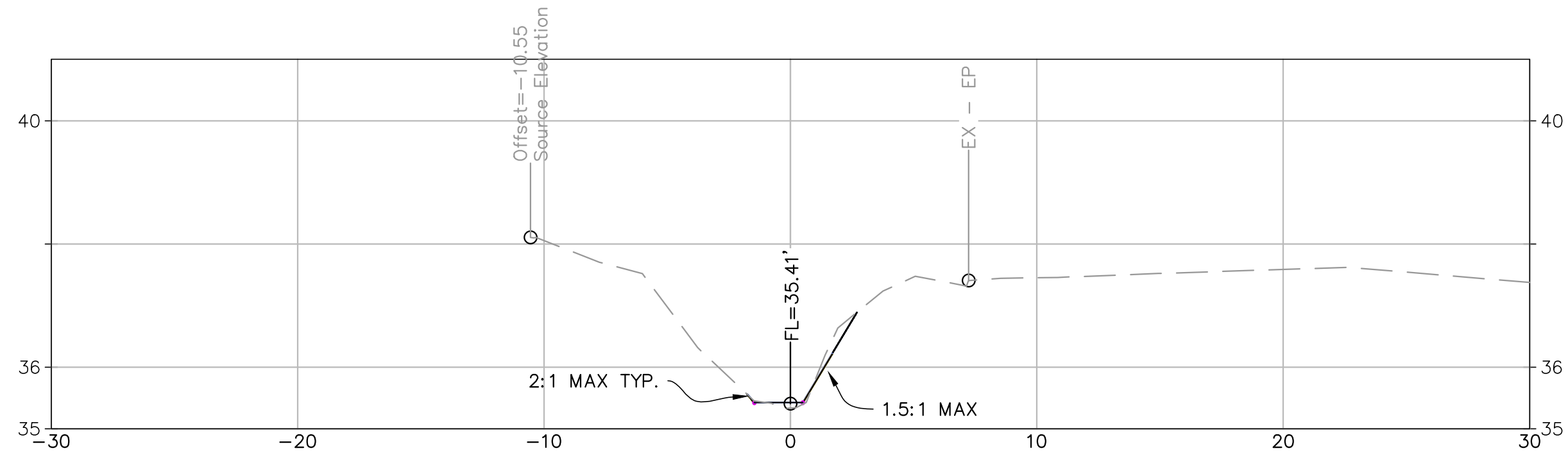

11+50

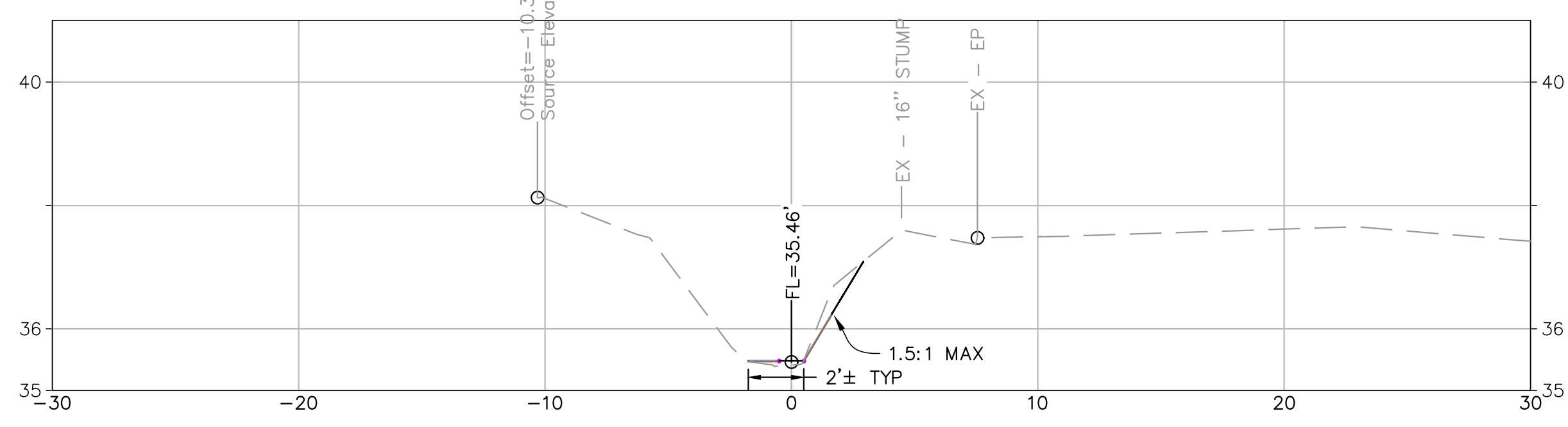

11+43.54

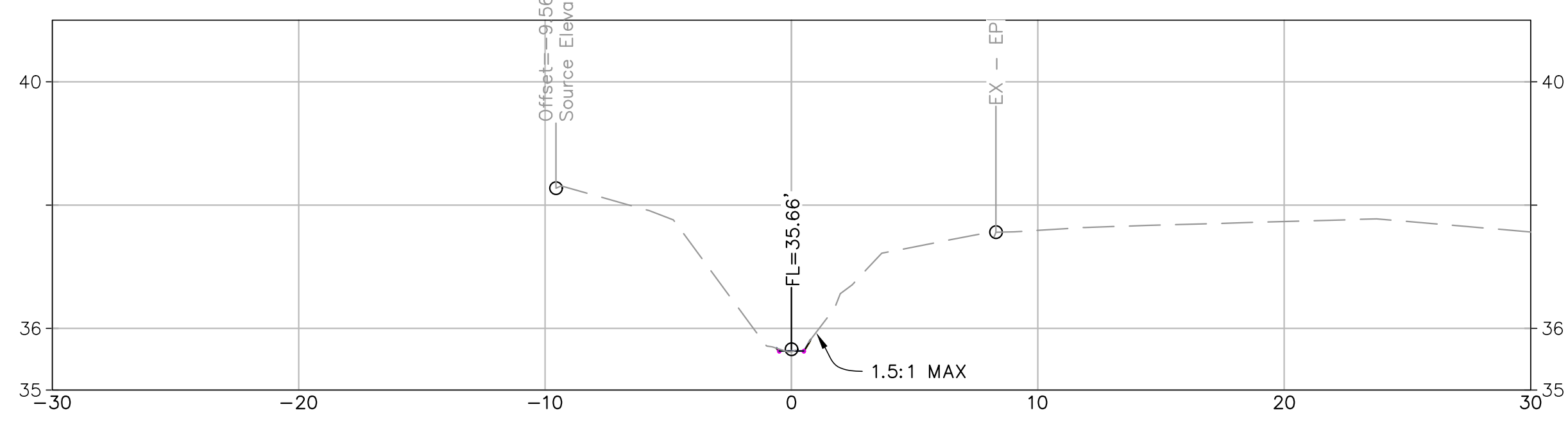

11+25

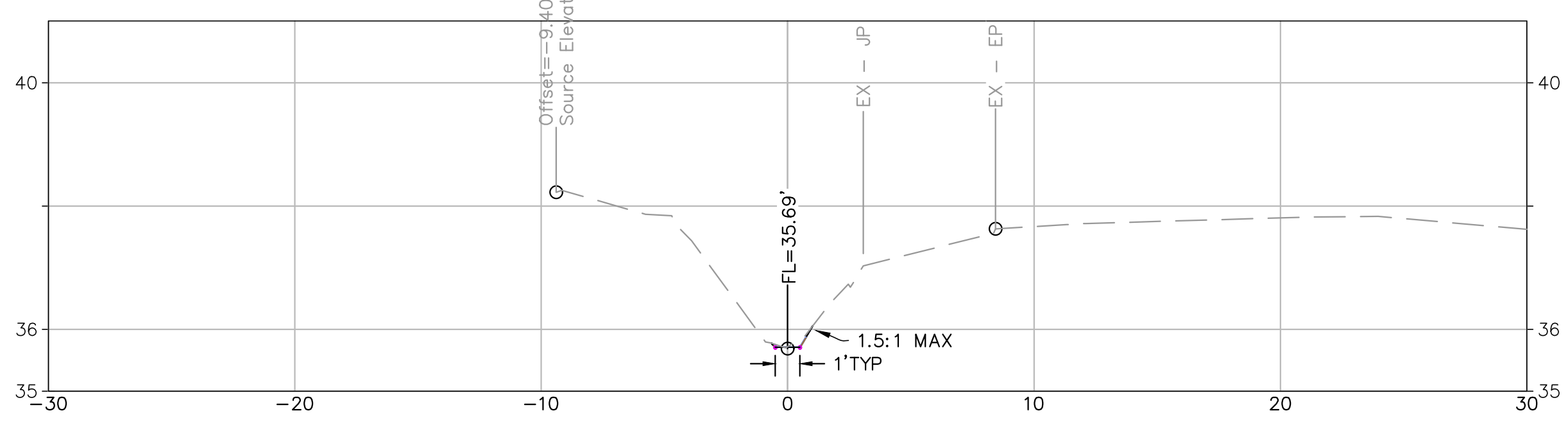

11+15.60

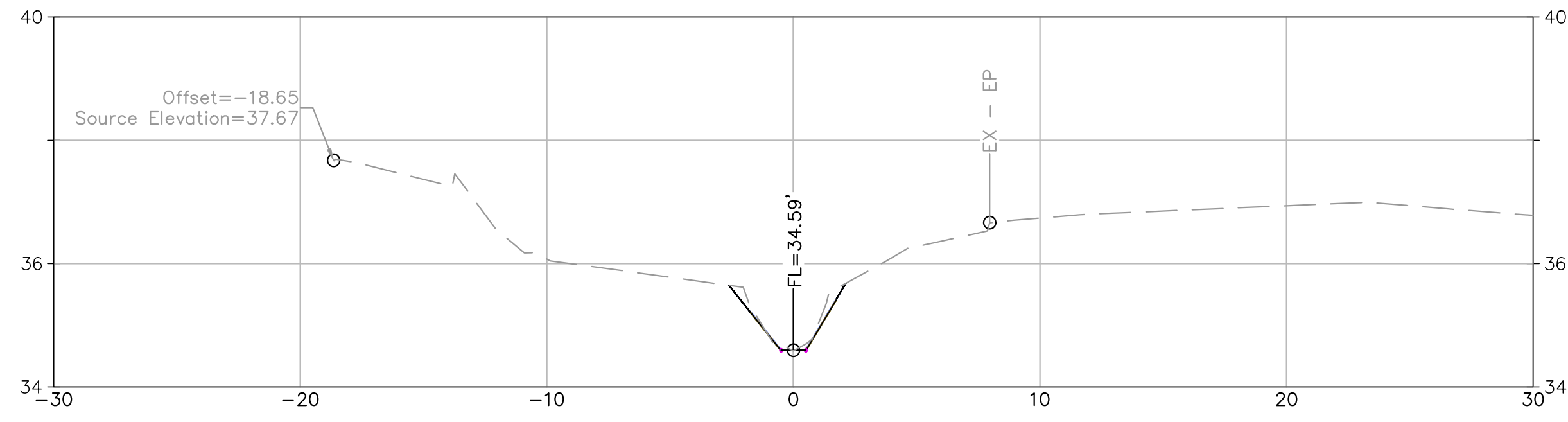

12+50

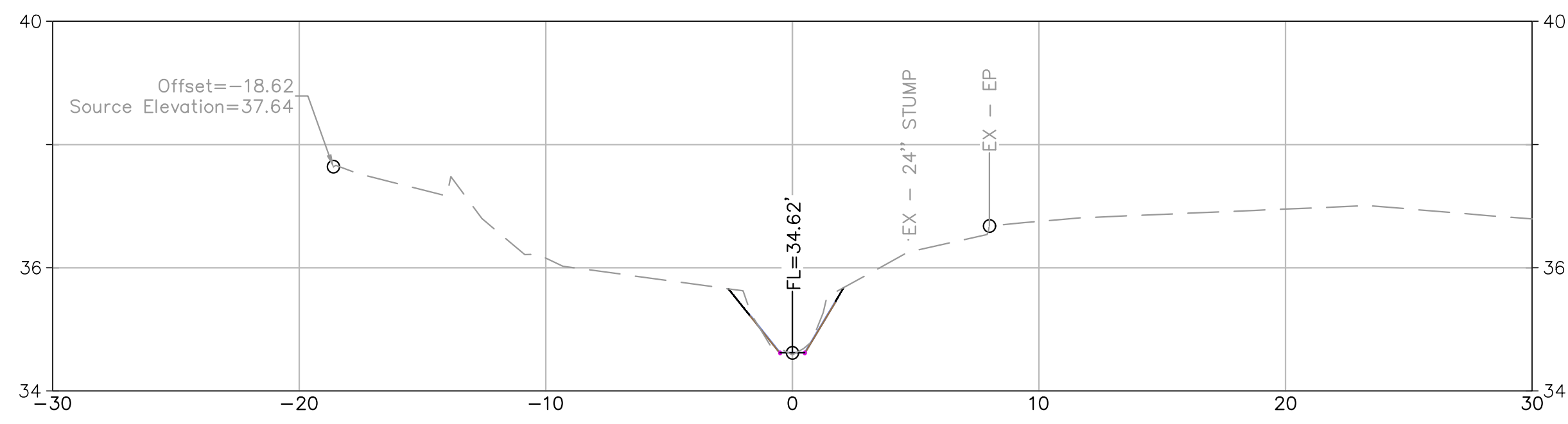

12+47.26

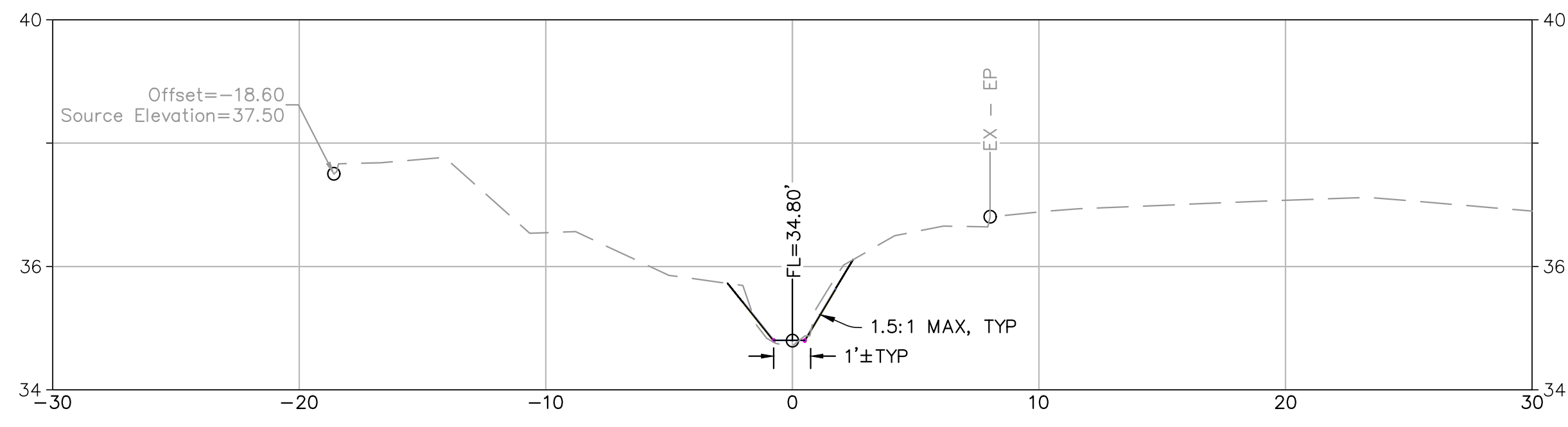

12+25

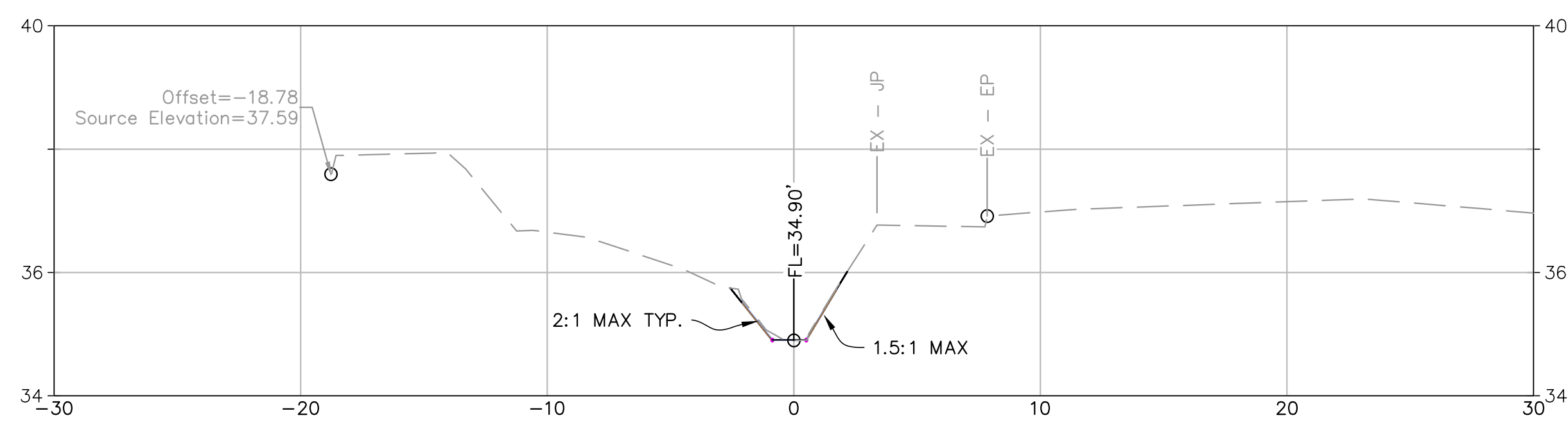

12+12.93

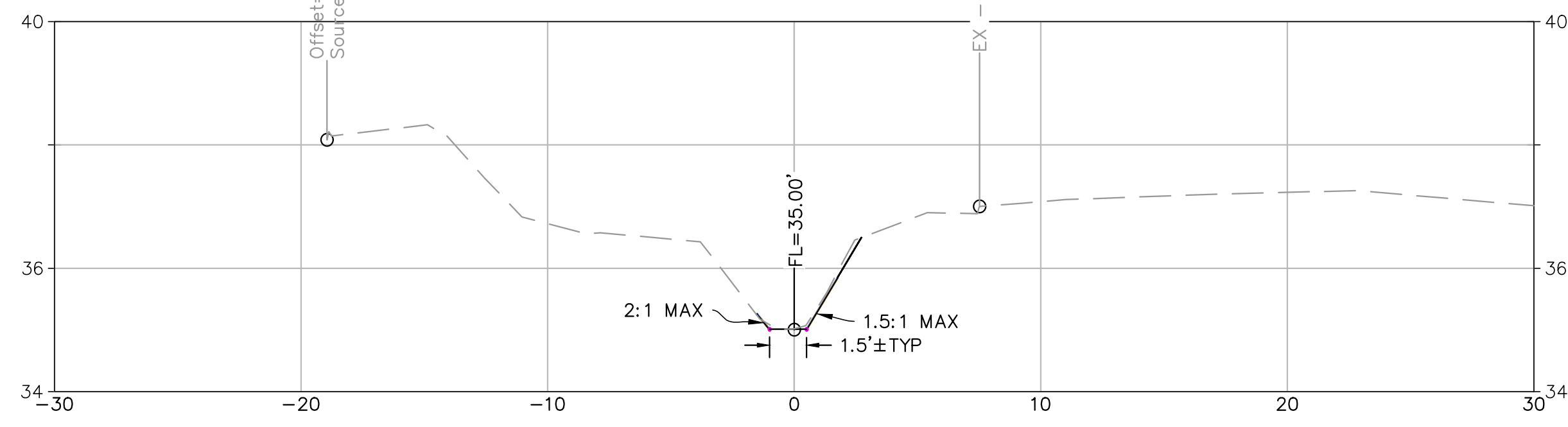

12+00

CROSS SECTION SCALES
 HORIZ: 1" = 5'
 VERT: 1" = 2'

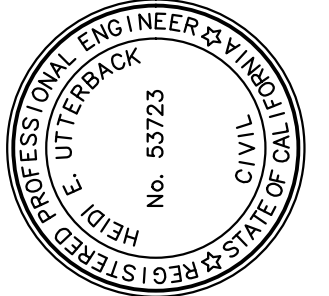

PREPARED UNDER THE DIRECTION OF
 HEIDI E. UTTERBACK
 No. 53723
 DATE 3/19/2026
 DESIGNED BY AJM
 DRAWN BY AJM
 REVIEWED BY HEU

DCCM
 DCCM Infrastructure, Inc.
 1400 Neolomas Ave, Santa Rosa, CA 95405
 707.571.8005 | DCCM.com

CALIFORNIA

DRAINAGE IMPROVEMENTS
 TOWN OF ROSS
 ROADSIDE DITCH SECTIONS 2

PROJECT NUMBER 9007-65
 DRAWING DATE MARCH 2026
 SHEET NUMBER 9 OF 11

ORIGINAL PLOT DATE:

FOR REDUCED PLANS, THE ORIGINAL SCALE IS IN INCHES

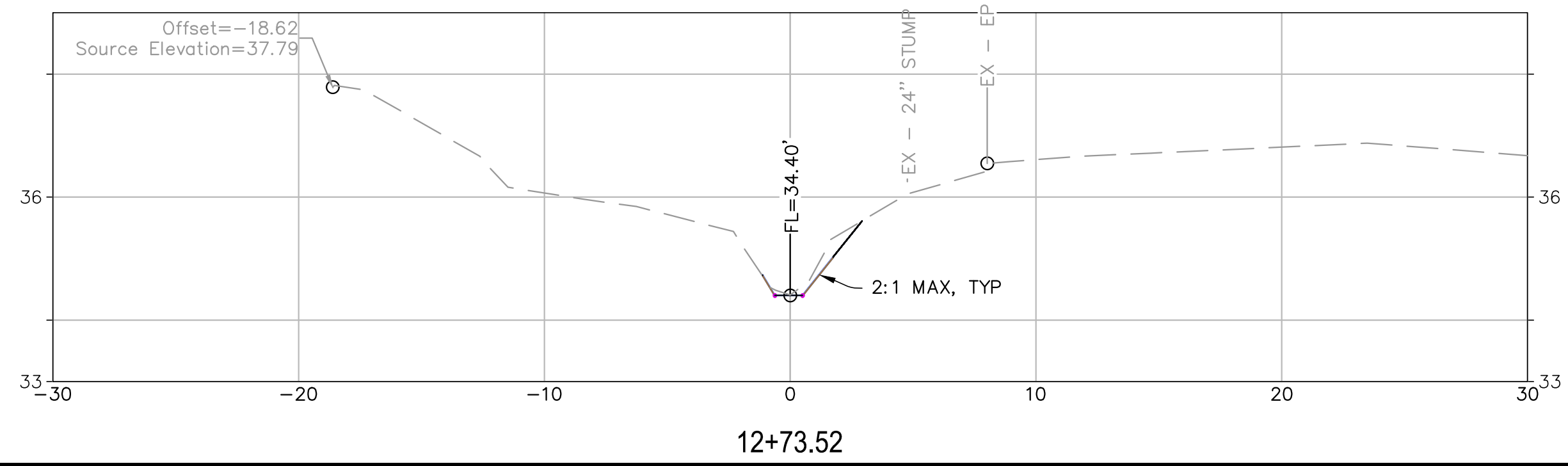
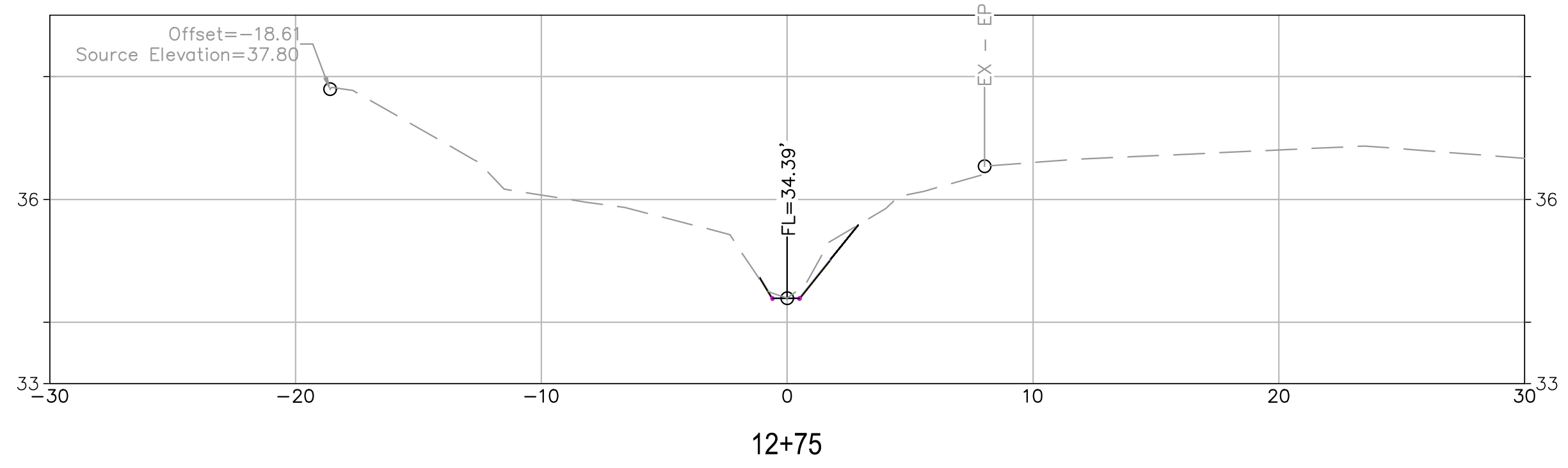
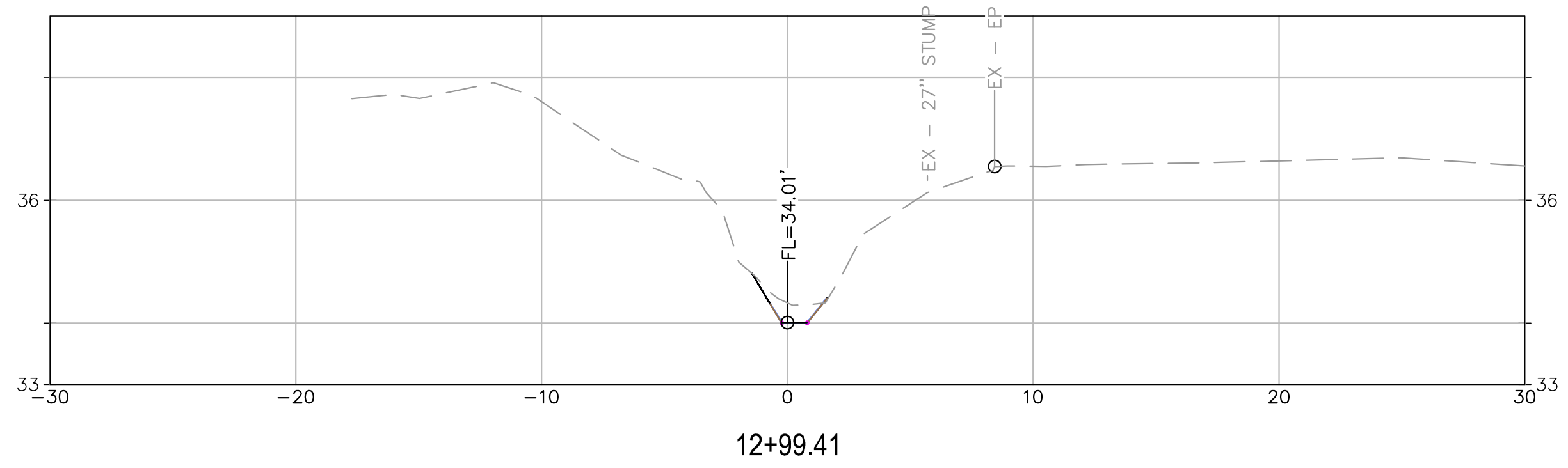
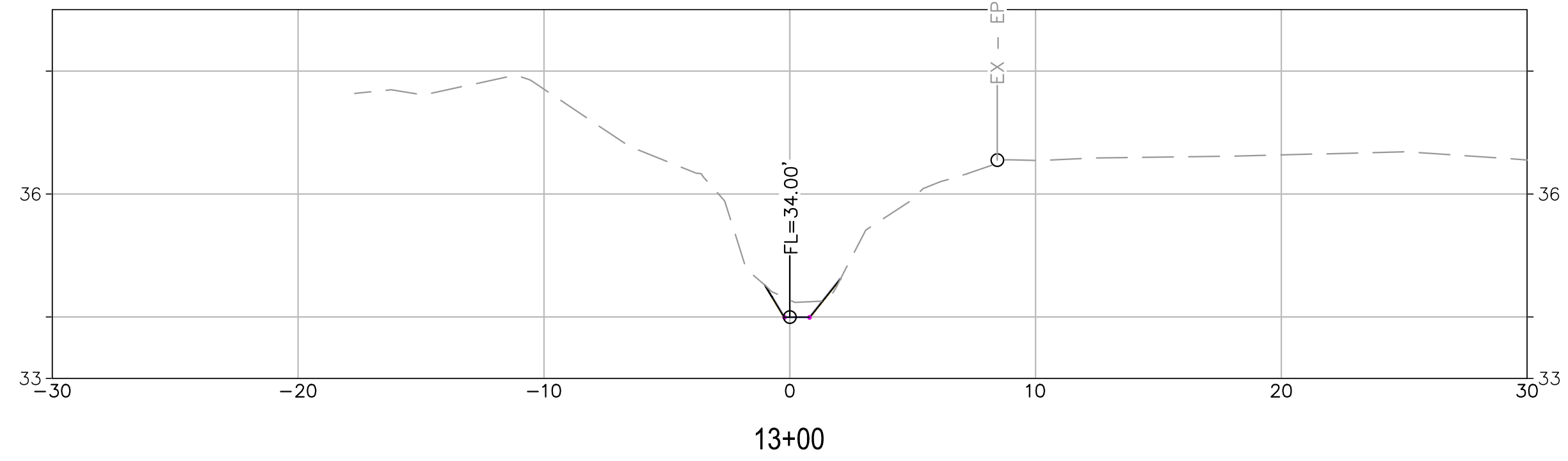

CROSS SECTION SCALES
 HORIZ.: 1" = 5'
 VERT.: 1" = 2'

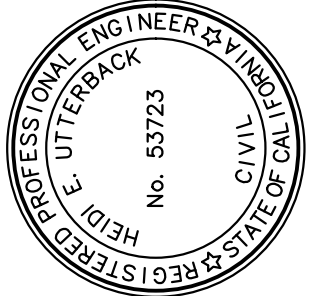

PREPARED UNDER THE DIRECTION OF
 Heidi E. Utterback
 HEIDI E. UTTERBACK, PCE 53723
 DESIGNED BY
 AJM
 DRAWN BY
 AJM
 REVIEWED BY
 HEU
 DATE
 3/19/2026

DCCM
 DCCM Infrastructure, Inc.
 1400 Neolomas Ave, Santa Rosa, CA 95405
 707.571.8005 | DCCM.com

TOWN OF ROSS
 CALIFORNIA
 DRAINAGE IMPROVEMENTS
 ROADSIDE DITCH SECTIONS 3

PROJECT NUMBER
 9007-65
 DRAWING DATE
 MARCH 2026
 SHEET NUMBER
 10 OF 11

ORIGINAL PLOT DATE:

FOR REDUCED PLANS, THE 0 ORIGINAL SCALE IS IN INCHES 1 2 3

Path: X:\Engineering\CDI_Projects\865399_Ross_Drainage_Project\DWG\865399_CDI.dwg Layout Name: DETAILS-1

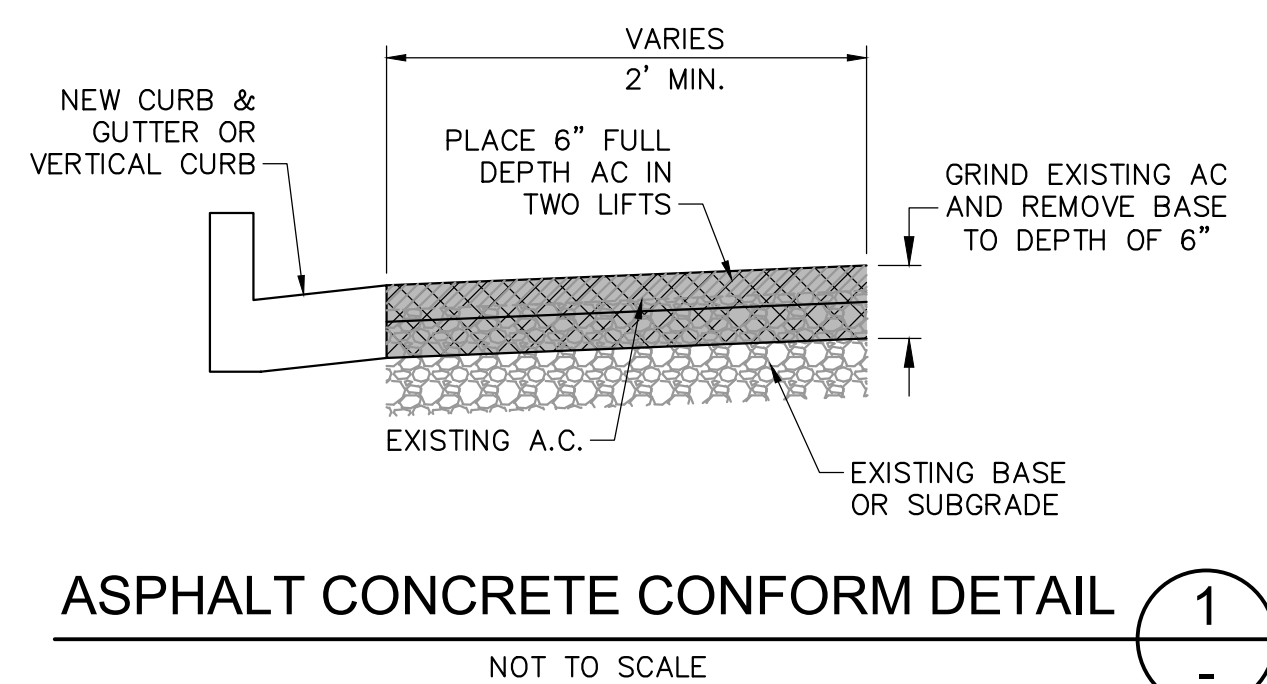

ASPHALT CONCRETE CONFORM DETAIL 1 - NOT TO SCALE

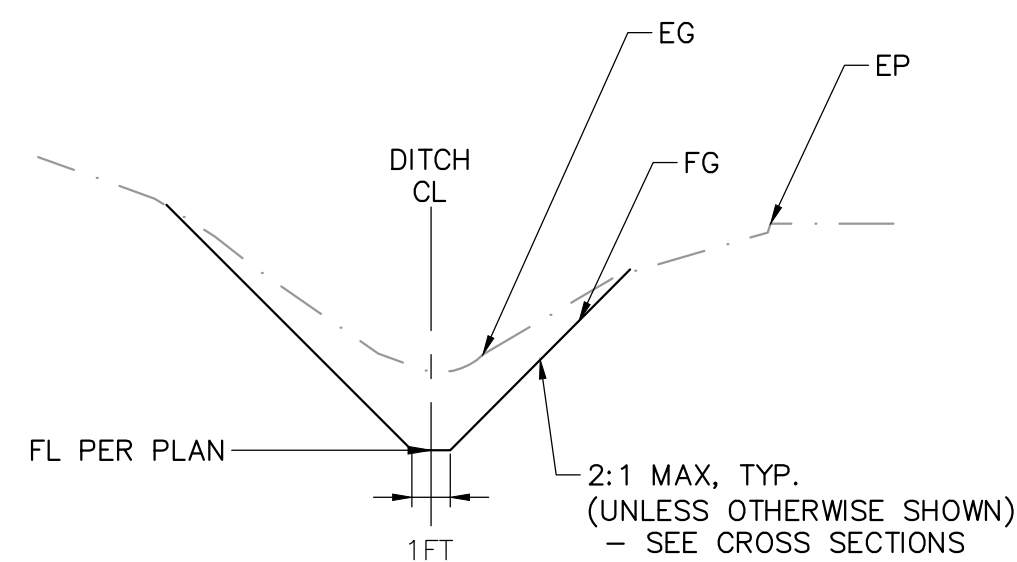

TYPICAL DITCH SECTION 2 - NOT TO SCALE

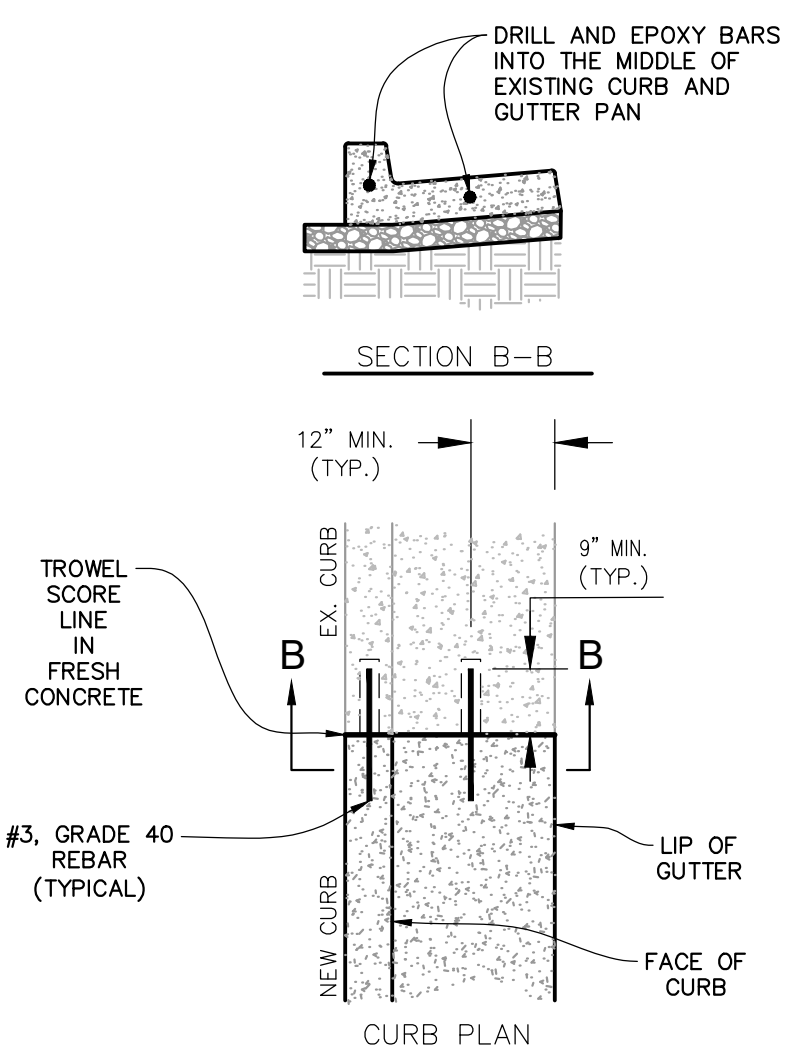

NOTES:

1. CURB AND GUTTER CONSTRUCTION SHALL CONFORM TO MUCS STD 105, TYPE "A" CURB.
2. ALL SOFT OR SPONGY SUB-GRADE MATERIAL SHALL BE REMOVED AND REPLACED WITH SUITABLE MATERIAL AS REQUIRED BY THE ENGINEER.
3. REINFORCING BARS SHALL BE MINIMUM GRADE 40 AND SHALL CONFORM TO SECTION 52, "REINFORCEMENT" OF THE CALTRANS STANDARD SPECIFICATIONS.
4. EPOXY USED FOR BONDING REINFORCING BARS TO EXISTING CONCRETE SHALL CONFORM TO THE REQUIREMENTS OF SECTION 95, EPOXY AND SECTION 95-2.03, "EPOXY RESIN ADHESIVE" FOR BONDING NEW CONCRETE TO OLD CONCRETE OF THE CALTRANS STANDARD SPECIFICATIONS.
5. CURB AND GUTTER SHALL BE SAWCUT AND REMOVED TO THE NEAREST CONTROL JOINT WHEN PRACTICAL AS DIRECTED BY THE ENGINEER.

CURB AND GUTTER REPLACEMENT DETAIL 3 - NOT TO SCALE

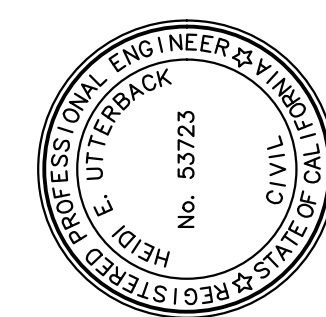

PREPARED UNDER THE DIRECTION OF
 HEIDI E. UTTERBACK, PCE 53723
 DESIGNED BY A:JM
 DRAWN BY A:JM
 REVIEWED BY HEU
 DATE 3/19/2026



TOWN OF ROSS
 CALIFORNIA
 DRAINAGE IMPROVEMENTS
 CONSTRUCTION DETAILS

PROJECT NUMBER
 9007-65
 DRAWING DATE
 MARCH 2026
 SHEET NUMBER
 11 OF 11